

NOTE: STREET NETWORK, INTERSECTIONS, TRANSFORMER LOCATIONS AND UTILITY DESIGN ARE CONCEPTUAL IN NATURE. FINAL DESIGN WILL OCCUR AT SESP.

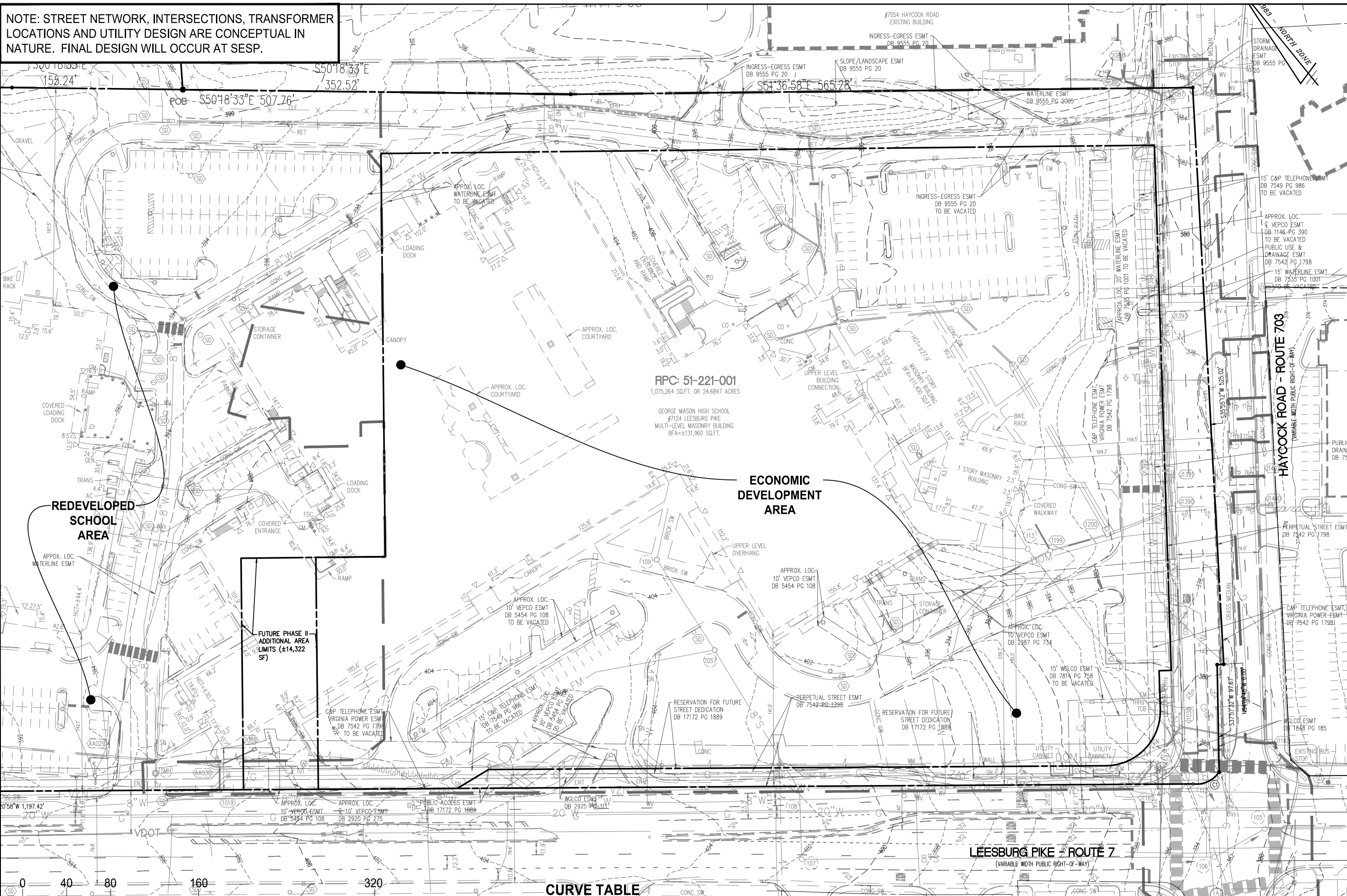

**RPC: 51-221-001**  
1,075,264 SQ.FT. OR 24.6847 ACRES  
GEORGE MASON HIGH SCHOOL  
#7124 LEESBURG PIKE  
MULTI-LEVEL MASONRY BUILDING  
BFA=±131,960 SQ.FT.

**REDEVELOPED SCHOOL AREA**

**ECONOMIC DEVELOPMENT AREA**

**FUTURE PHASE II ADDITIONAL AREA LIMITS (±14,322 SF)**



**CURVE TABLE**

CURVE	RADIUS	LENGTH	DELTA	TANGENT	CHORD	CHORD BEARING
C1	25.00'	27.36'	62°42'16"	15.23'	26.01'	N75°29'08"W

NOTE: CONTOURS BASED ON VERTICAL DATUM NAVD 1988.

**EXISTING CONDITIONS PLAN**  
**WEST FALLS CHURCH ECONOMIC DEVELOPMENT**  
**SPECIAL EXCEPTION ENTITLEMENT PLAN**  
CITY OF FALLS CHURCH

SCALE: 1" = 80'  
DATE: 01/13/2021  
02/04/2019 04/28/2021  
04/19/2019  
06/07/2019  
05/15/2020  
06/08/2020  
SHEET: **C-0303**