

RFP No. 0730 – 15GMHS - PPEA

APPENDIX C - ATTACHMENT 2

EDUCATIONAL SPECIFICATION

FOR

REQUIREMENTS FOR GRADE 9-12 HIGH SCHOOL

GEORGE MASON HIGH SCHOOL

(1500 Student Capacity)

Falls Church City Public Schools
Falls Church, VA

March 1, 2016

FALLS CHURCH CITY PUBLIC SCHOOLS
EDUCATIONAL SPECIFICATIONS

GEORGE MASON HIGH SCHOOL

CONTENTS

	<u>Page No.</u>
Part I Summary of Square Footage Requirements for High School	1
Part II Space Specific Requirements	2
• General	3
• Definitions	3
• General Learning & Support Areas:	
English Department	6
Math Department	12
Science Department	17
Social Studies Department	27
World Language Department	33
Inter-Disciplinary	40
Art – Performance and Design Department	54
Cross Disciplinary Innovation Department	82
Physical Education	87
Special Education	110
Technology Support Services.....	122
Building Services / Maintenance	125
Health Services.....	129
Food Service.....	135
Administration / Safety / Guidance	149
Toilets	181
Support Spaces and Circulation	185
Exterior Site Requirements.....	191

PART I

SUMMARY OF SQUARE FOOTAGE
REQUIREMENTS FOR HIGH SCHOOL

SEE APPENDIX C – ATTACHMENT 1

PART II

SPACE SPECIFIC REQUIREMENTS

GENERAL

The school will be designed for 1500 student capacity.

FCCPS encourages the submission of High School designs that illustrate an innovative design approach that promotes the development of student critical thinking on a global scale, solving real-world problems. An example would be each of the departments arranged in a “learning pod” where classroom spaces adjoin with community learning spaces. The community spaces should be integral to the classroom activities to promote collaborative learning and design thinking. The purpose is to create a learning environment that fosters independent learners, innovators, and problem solvers through hands-on application of curriculum and learning reinforcement through student interaction, presentation, and creation.

DEFINITIONS

Telecommunications

Provide a complete Telecommunications System and Phone System with interface with the City telecommunications backbone (See Educational Specification for additional space requirements). **Telecommunication utility connections include: 1) Cox Communications Fiber Connection (Merryfield) Fiber INet (City Backbone); 2) Coax Cable from Cox Communications for VOIP; 3) (2) Verizon Fiber Connections for Internet.**

Provide a Telecommunications Server Room with split system HVAC for main telecommunications equipment (Separate Data & Phone Racks) and phone system equipment (VOIP). **Provide the following equipment for the server room:**

Vendor	Equipment	Quantity
APC	UPS 8KVA 208V	1
Dell	NetShelter Rack Cabinet	1
Dell	KVM/KMM Analog Switch Module	1
Dell	M1000e Blade Enclosure	1
Dell	M820 Blade	4
Dell	PowerVault MD3860f Fibre Channel	2
Dell	Brocade M6505 Blade Switch	4
Dell	Qlogic QME2572 Fibre Channel Card	4
Cisco	Catalyst 3850 Switch 24-port 10G	1
Cisco	Catalyst ASA5545 Firewall	1
Cisco	5508 Wireless Controller	2
Cisco	2960 Switch 48-port PoE++	1
VMWare	Virtual Center License	1
VMWare	Vsphere 6/ESX Licenses	16
Cisco	Catalyst 4500x Core Sw 10G w/SFP	1

Telecommunications Closets with separate Data & Phone Racks, Cisco PoE WS-C2960X-48FPS-L switches, and Cisco SFP 1000 Base T modules. Security Cameras will be terminated at Data Switches. Telecommunications and Phone equipment shall be connected to emergency backup power circuits along with an Uninterruptable Power Supply battery backup system.

Remote telecommunications closets shall be connected by fiber optic cable to the main telecommunications room. Provide at a minimum CAT6 cable for all data and phone connections. Every room shall have at least one data and phone outlet. Provide a wireless access point (**Cisco AIR CAP37021-A-K9**) at each classroom & special education classroom, (4) wireless access points at the cafeteria, media center, gymnasium, & auditorium, and additional wireless access points as needed for complete building coverage. Provide 64" Interactive White Boards (**SMART Board Model SBM680**), projectors (**Epson Powerlite 99W Series**), and **Apple TV** at all classrooms, special education classrooms, and as specified in the Education Specification (include all necessary data and power requirements). Interface telecommunications system with security system, security camera system, door access card reader system, and HVAC control system. The Phone System includes phones and interface with the Carehawk/Dukane Public Address intercom system.

Wireless Access outside building up to 100'

Due to the on-going rapid advancement in Technology, the cost of the specific Telecommunications Equipment noted above, including servers, switches, wireless access points, interactive white boards, projectors, and Apple TV will be included as an allowance. The allowance will be used to purchase the final Telecommunications Equipment as selected by the Owner.

Cable Television (CATV) Not required.

Intercom System Provide a complete Carehawk/Dukane Public Address intercom system that covers all interior spaces and exterior spaces including the Main Entrance and Sports Facilities. The Carehawk/Dukane Intercom System shall be installed in the Main Office, include (3) master stations, and an interface with the VOIP phone system. Provide intercom speakers in all interior spaces. Intercom announcements shall be audible at all interior spaces. Call back switches shall be provided in all classrooms, special education classrooms, and teaching spaces (See Education Specification).

Security CCTV Provide a complete security system and CCTV system that monitors the building exterior and all interior building entrances, corridors, stairs, and any areas that are remote or not directly supervised by school staff. Provide security cameras interfaced with the telecommunications system that will be monitored through the FCCPS main server. Provide interior cameras that monitor all building entrances, building corridors, and stairs at each floor. Provide exterior cameras that monitor the entire building exterior. The building security system shall provide motion detectors that monitor all building entrances, building corridors, and building stairs at each floor. Provide security system keypads at each building entrance and interface with the City of Falls Church Police Department for system monitoring.

Door Access System Provide a complete card reader door access system including computer, software, and cards for a minimum 120 personnel. Card readers and electric locks shall be provided at all building entrances, and telecommunications rooms. Interface card reader system with telecommunications system.

Life Safety Provide a complete Fire Alarm system per code requirements with interface with the City of Falls Church Police Department for system monitoring.

Provide electronic door holders for all stair, corridor, cafeteria, auditorium and gym doors. The building will be fully covered by a Sprinkler System.

Provide an Emergency Generator for all life safety systems, telecommunications system, phone system, security system, door access system, Kitchen Refrigerators & Freezers, Health Clinic Refrigerator, and Science Room Refrigerators & Freezers.

HVAC Controls

Provide ASI HVAC Control System or alternate HVAC Control System and integrate with the school's existing ASI Controls. A central HVAC Graphic Control system shall integrate all FCCPS school HVAC Control systems to one location. Provide interface and control for the George Mason High School, Mary Ellen Henderson Middle School, Thomas Jefferson Elementary School, Mount Daniel Elementary School, and Jessie Thackrey Preschool.

FF&E

Provide design, procurement, and coordination services for the development & procurement of Owner Furniture, Fixtures & Equipment (FF&E). An allowance will be established for the purchase of FF&E.

Special Characteristics

All items listed under "Special Characteristics" are to be "In-Contract" unless noted otherwise.

ENGLISH DEPARTMENT

SPACE NAME: ENGLISH COLLABORATIVE CLASSROOMS

USE OF SPACE - PURPOSE/ACTIVITIES:

- A. Teaching space for English Department.
- B. Flexible configuration of room with separate breakout space visible from classroom
- C. Cross disciplinary Opportunity with Social Studies

OCCUPANTS:

- Staff 1
- Students 24

SIZE AND LOCATION:

- Size 800 sq ft
- Location English Department

FURNISHINGS AND EQUIPMENT: (Items listed below are per space)

- **In-Contract** 120" x 48" total length tackboard
192" x 48" total length whiteboard / sliding whiteboard
64" Interactive whiteboard (smart technology w/ projector)
Flagholder and Pencil Sharpener Block on wall
Base and wall storage cabinets with Countertop (12 LF.)
Teacher wardrobe 48"w x 72"h x 24"d with lock
84" High Built-in Open Bookcase (8 LF)
- **By Owner** Desks (24)
Chairs (24)
(1) Teacher desk, chair, computer workstation
- **Finishes** Floor: VCT
Base: Vinyl
Walls: CMU - painted
Ceiling: suspended acoustic tile 9'-6" A.F.F.
Door: 36" X 84" with 8" x 30" vision glass
- **Motion Detector** lighting control
- **Electric outlets** Double duplex at desk location / Minimum (2) duplex outlets per wall / Projector ceiling outlet / Computer Charging Station
- **Telecommunications** Data / Phone outlet at teachers desk and Data outlet at opposite side of room, wireless access point, interactive white board & projector provisions / Apple TV
- **Clock (Atomic)**
- **Ceiling speakers** Public Address System with Call Back
-

SPECIAL CHARACTERISTICS:

- **Provide window approximately 240" x 60" per classroom**
Window Blinds
- **Breakout Space** Each Classroom shall contain a 50 SF Breakout Space visible from within the Classroom
- **Divided Classrooms** Provisions to open two sets of classrooms into one large classroom with a convenient acoustical divider

ENGLISH DEPARTMENT

SPACE NAME: TEACHER TEAM ROOM & LOUNGE

USE OF SPACE - PURPOSE/ACTIVITIES:

- A. Individual teachers work area and storage of professional materials.
- B. Specific Activities:
 - Teacher and staff preparation of materials
 - Space for teacher and staff files
 - Space for teacher and staff supplies and storage.

OCCUPANTS:

- **Staff** 6-8
- **Students** N/A

SIZE AND LOCATION:

- **Size** 400 sq ft
- **Location** Central to the English Department.

FURNISHINGS AND EQUIPMENT:

- **In-Contract** 6 ft. work counter/cabinet with sink/hot and cold water
48" x 48" tackboard
48" x 48" whiteboard
- **By Owner** Copier Equipment
Bookcases
File Cabinets
Sofa
2 Round tables
8 Chairs
4 Lounge chairs
- **Finishes** Floor: VCT
Base: Vinyl
Walls: CMU - painted
Ceiling: Suspended acoustic tile 9'-0" A.F.F.
Door: 36" X 84" with 24" x 36" vision glass
- **Electric outlets** Minimum (2) duplex per wall, (2) duplex outlets above counter, and (1) 208V outlet for copying equipment
- **Telecommunications** (1) data outlet for copying equipment / Wireless Access Point
- **Ceiling speaker** Public Address System
- **Motion Detector** lighting control

SPECIAL CHARACTERISTICS:

- N/A

ENGLISH DEPARTMENT

SPACE NAME: ENGLISH BREAKOUT SPACE

USE OF SPACE - PURPOSE/ACTIVITIES:

A. Small student workgroups spaces.

OCCUPANTS:

- **Staff** 1
- **Students** Varies

SIZE AND LOCATION:

- **Size** 200 sq ft
- **Location** English Department – accessible and visible from two classrooms

FURNISHINGS AND EQUIPMENT:

- **In-Contract** 64" Interactive whiteboard (smart technology w/ projector)
120" x 48" total length tackboard
120" x 48" total length whiteboard
- **By Owner**
- **Finishes** Floor: VCT
Base: Vinyl
Walls: CMU - painted
Ceiling: Suspended acoustic tile 9'-6" A.F.F.
- **Electric outlets** Minimum (2) duplex outlets per wall
- **Telecommunications** Data / Phone outlet, wireless access point, interactive white board & projector provisions / Apple TV
- **Clock (Atomic)**
- **Ceiling speakers** Public Address System with Call Back

SPECIAL CHARACTERISTICS:

- N/A

SPACE NAME: ACADEMIC STORAGE ROOM

USE OF SPACE - PURPOSE/ACTIVITIES:

- A. Storage of academic supplies.

OCCUPANTS:

- Staff N/A
- Students N/A

SIZE AND LOCATION:

- Size 300 sq ft
- Location Adjacent to Teacher Work Room

FURNISHINGS AND EQUIPMENT:

- **In-Contract** 18 L.F. adjustable metal shelving units (12" deep by 84" high)
- **By Owner** N/A
- **Finishes** Floor: VCT
Base: Vinyl
Walls: CMU - painted
Ceiling: Suspended acoustic tile 9'-0" A.F.F.
Door: 36" X 84"
- **Electric outlets** Minimum (1) duplex per wall
- **Ceiling speaker** Public Address System
- **Telecommunications** Data/Phone outlet
- **Motion Detector** lighting control

SPECIAL CHARACTERISTICS:

- N/A

ENGLISH DEPARTMENT

SPACE NAME: CONTENT AREA SMALL CLASSROOM

USE OF SPACE - PURPOSE/ACTIVITIES:

- A. Student small group classroom.
- B. Flexible Configuration of Room

OCCUPANTS:

- Staff 1
- Students Varies 5-10

SIZE AND LOCATION:

- Size 400 sq ft
- Location English Department - Accessible and visible from two Classrooms and Corridor

FURNISHINGS AND EQUIPMENT:

- **In-Contract** 120" x 48" total length tackboard
120" x 48" total length whiteboard
64" Interactive whiteboard (smart technology w/ projector)
Flagholder on wall
Base and wall storage cabinets (6 ft.)
36" x 120" bookcase under tackboard
- **By Owner** Desks (5-10)
Chairs (5-10)
(1) Teacher desk, chair, computer workstation
- **Finishes** Floor: VCT
Base: Vinyl
Walls: CMU - painted
Ceiling: Suspended acoustic tile 9'-6" A.F.F.
Door: 36" X 84" with 8" x 30" vision glass
- **Electric outlets** Double duplex at desk location / Minimum (2) duplex outlets per wall / Computer Charging Station
- **Telecommunications** Data / Phone outlet at teachers desk, wireless access point, interactive white board & projector provisions / Apple TV
- **Clock (Atomic)**
- **Ceiling speakers** Public Address System with Call Back
- **Motion Detector** lighting control

SPECIAL CHARACTERISTICS:

- **Provide window approximately 144" x 60" per classroom**
Window Blinds

SPACE NAME: STAFF TOILET

USE OF SPACE - PURPOSE/ACTIVITIES:

- A. For Staff use
- B. Specific Activities:
 - Rest room facility
 - H/C accessible

OCCUPANTS:

- **Staff** 1
- **Students** N/A

SIZE AND LOCATION:

- **Size** 60 sq ft each
- **Location** English Department

FURNISHINGS AND EQUIPMENT:

- **In-Contract** Toilet accessories
- **By Owner** N/A
- **Finishes** Floor: ceramic tile
Base: ceramic tile
Walls: ceramic tile wainscot 5'-0" -CMU - painted - epoxy
Ceiling: suspended acoustic tile 8'-0" A.F.F.
Door: 36" X 84" with privacy lock
- **Ceiling speaker** Public Address System
- **Motion Detector** lighting control

SPECIAL CHARACTERISTICS:

- **ADA Accessible**

MATH DEPARTMENT

SPACE NAME: MATH CLASSROOMS

USE OF SPACE - PURPOSE/ACTIVITIES:

- A. Teaching space for Math Department
- B. Flexible configuration of room
- C. Cross disciplinary Opportunity with Science Department

OCCUPANTS:

- Staff 1
- Students 24

SIZE AND LOCATION:

- Size 800 sq ft
- Location

FURNISHINGS AND EQUIPMENT: (Items listed below are per space)

- **In-Contract** 120" x 48" total length tackboard
192" x 48" total length whiteboard / sliding whiteboard
64" Interactive whiteboard (smart technology w/ projector)
Flagholder and Pencil Sharpener Block on wall
Base and wall storage cabinets with Countertop (8 LF)
Teacher wardrobe 48"w x 72"h x 24"d with lock
84" High Built-in Open Bookcase (8 LF)
- **By Owner** Desks (24)
Chairs (24)
(1) Teacher desk, chair, computer workstation
- **Finishes** Floor: VCT
Base: Vinyl
Walls: CMU - painted
Ceiling: suspended acoustic tile 9'-6" A.F.F.
Door: 36" X 84" with 8" x 30" vision glass
- **Electric outlets** Double duplex at desk location / Minimum (2) duplex outlets per wall / Projector ceiling outlet / Computer Charging Station
- **Telecommunications** Data / Phone outlet at teachers desk and Data outlet at opposite side of room, wireless access point, interactive white board & projector provisions / Apple TV
- **Clock (Atomic)**
- **Ceiling speakers** Public Address System with Call Back
- **Motion Detector** lighting control

SPECIAL CHARACTERISTICS:

- **Provide window approximately 240" x 60" per classroom**
Window Blinds
- **Divided Classrooms** Provisions to open two sets of classrooms into one large classroom with a convenient acoustical divider

MATH DEPARTMENT

SPACE NAME: TEACHER TEAM ROOM & LOUNGE

USE OF SPACE - PURPOSE/ACTIVITIES:

- A. Individual teachers work area and storage of professional materials.
- B. Specific Activities:
 - Teacher and staff preparation of materials
 - Space for teacher and staff files
 - Space for teacher and staff supplies and storage.

OCCUPANTS:

- **Staff** 6-8
- **Students** N/A

SIZE AND LOCATION:

- **Size** 400 sq ft
- **Location** Central to the Math Department.

FURNISHINGS AND EQUIPMENT:

- **In-Contract** 6 ft. work counter/cabinet with sink/hot and cold water
48" x 48" tackboard
48" x 48" whiteboard
- **By Owner** Copier Equipment
Bookcases
File Cabinets
Sofa
Table
4 Chairs
- **Finishes** Floor: VCT
Base: Vinyl
Walls: CMU - painted
Ceiling: Suspended acoustic tile 9'-0" A.F.F.
Door: 36" X 84" with 24" x 36" vision glass
- **Electric outlets** Minimum (2) duplex per wall, (2) duplex outlets above counter, and (1) 208V outlet for copying equipment
- **Telecommunications** (1) data outlet for copying equipment, Wireless Access Point
- **Ceiling speaker** Public Address System
- **Motion Detector** lighting control

SPECIAL CHARACTERISTICS:

- N/A

SPACE NAME: ACADEMIC STORAGE ROOM

USE OF SPACE - PURPOSE/ACTIVITIES:

- A. Storage of academic supplies.

OCCUPANTS:

- Staff N/A
- Students N/A

SIZE AND LOCATION:

- Size 300 sq ft
- Location Adjacent to Teacher Work Room

FURNISHINGS AND EQUIPMENT:

- In-Contract 18 L.F. adjustable metal shelving units (12" deep by 84" high)
- By Owner N/A
- Finishes
 - Floor: VCT
 - Base: Vinyl
 - Walls: CMU - painted
 - Ceiling: Suspended acoustic tile 9'-0" A.F.F.
 - Door: 36" X 80"
- Electric outlets Minimum (1) duplex per wall
- Ceiling speaker Public Address System
- Telecommunications Data/Phone outlet
- Motion Detector lighting control

SPECIAL CHARACTERISTICS:

- N/A

MATH DEPARTMENT

SPACE NAME: CONTENT AREA SMALL CLASSROOM

USE OF SPACE - PURPOSE/ACTIVITIES:

- A. Student small Classroom space.
- B. Flexible Configuration of Room

OCCUPANTS:

- Staff 1
- Students Varies 5-10

SIZE AND LOCATION:

- Size 400 sq ft
- Location Math Department – Accessible from two classrooms with visual control and Corridor

FURNISHINGS AND EQUIPMENT:

- **In-Contract** 120” x 48” total length tackboard
120” x 48” total length whiteboard
64” Interactive whiteboard (smart technology w/ projector)
Flagholder on wall
Base and wall storage cabinets (6 ft.)
Teacher wardrobe 48”w x 72”h x 24”d with lock
36” x 120” bookcase under tackboard
- **By Owner** Desks (5-10)
Chairs (5-10)
(1) Teacher desk, chair, computer workstation
- **Finishes** Floor: VCT
Base: Vinyl
Walls: CMU - painted
Ceiling: Suspended acoustic tile 9'-6" A.F.F.
Door: 36” X 84” with 8” x 30” vision glass
- **Electric outlets** Double duplex at desk location / Minimum (2) duplex outlets per wall / Computer Charging Station
- **Telecommunications** Data / Phone outlet at teachers desk, wireless access point, interactive white board & projector provisions / Apple TV
- **Clock (Atomic)**
- **Ceiling speakers** Public Address System with Call Back
- **Motion Detector** lighting control

SPECIAL CHARACTERISTICS:

- Provide window approximately 120” x 60” per classroom
Window Blinds

SPACE NAME: STAFF TOILET

USE OF SPACE - PURPOSE/ACTIVITIES:

- A. For Staff use
- B. Specific Activities:
 - Rest room facility
 - H/C accessible

OCCUPANTS:

- Staff 1
- Students N/A

SIZE AND LOCATION:

- Size 60 sq ft each
- Location Math Department

FURNISHINGS AND EQUIPMENT:

- **In-Contract** Toilet accessories
- **By Owner** N/A
- **Finishes**
 - Floor: ceramic tile
 - Base: ceramic tile
 - Walls: ceramic tile wainscot 5'-0" - CMU - painted - epoxy
 - Ceiling: suspended acoustic tile 8'-0" A.F.F.
 - Door: 36" X 84" with privacy lock
- **Ceiling speaker** Public Address System
- **Motion Detector** lighting control

SPECIAL CHARACTERISTICS:

- **ADA Accessible**

SCIENCE DEPARTMENT

SPACE NAME: UNIVERSAL LAB / CLASSROOMS

USE OF SPACE - PURPOSE/ACTIVITIES:

- A. Teaching space for Science.
- B. Flexible configuration of room
- C. Cross disciplinary Opportunity with Math Department
- D. Final Room Configurations for Biology, Chemistry, and Physics Classrooms may vary between Classroom types.

OCCUPANTS:

- Staff 1
- Students 24

SIZE AND LOCATION:

- Size 1600 sq ft
- Location Science Department

FURNISHINGS AND EQUIPMENT: (Items listed below are per space)

- **In-Contract**
 - 120" x 48" total length tackboard
 - 192" x 48" total length whiteboard / sliding whiteboards
 - 64" Interactive whiteboard (smart technology w/ projector)
 - Small fixed Central Teacher Science Desk with gas, deep sink, gooseneck faucet, electric, and acid resistant countertop. Base cabinet storage under desk. Movable side Teacher Demonstration Tables with acid resistant countertop.
 - (6) Movable Science Room Tables, adjustable height, four students each, with acid resistant countertop.
 - (6) fixed student workstations in perimeter casework with gas, deep sink, gooseneck faucet, (3) electric duplex outlets, and acid resistant countertop. Provide undercounter knee space at workstations.
 - (25) Science Table Stools
 - Flagholder and Pencil Sharpener Block on wall
 - Base and wall storage cabinets along entire perimeter wall (no wall cabinets at windows), and acid resistant countertops. Mix in full height storage cabinets. Half of wall cabinets to have door vision glass.
 - Teacher wardrobe 48"w x 72"h x 24"d with lock
 - (24) 12" x 18" cubbies / Apron Hooks
 - (6) Ceiling Mounted Duplex Electric Reals near center of room.
 - Fume Hood (total 4 additional mobile fume hoods for department)
 - Central Distilled Water Unit and Ice maker for Department
 - Safety Shower and Eyewash
 - Goggle Cabinet (36)
 - Built-in Dishwasher and Microwave
 - Standard Refrigerator on emergency circuit
 - Computer Charging Station
- **By Owner** Science Equipment
- **Finishes**
 - Floor: VCT
 - Base: Vinyl
 - Walls: CMU - painted
 - Ceiling: suspended acoustic tile 9'-6" A.F.F.
 - Door: 36" X 84" with 8" x 30" vision glass

SCIENCE DEPARTMENT

- **Electric outlets** Double duplex at desk location / Minimum (2) duplex outlets per wall / Projector ceiling outlet / Science Tables / (8) duplex outlets above countertop / Computer Charging Station / (6) ceiling mounted duplex electric reals near center for room / Emergency Circuit for Refrigerator
- **Telecommunications** Data / Phone outlet at teachers desk and Data outlet at opposite side of room, wireless access point, interactive white board & projector provisions / Apple TV
- **Clock (Atomic)**
- **Ceiling speakers** Public Address System with Call Back
- **Motion Detector** lighting control

SPECIAL CHARACTERISTICS:

- **Provide window approximately 240" x 60" per classroom**
Blackout Curtains

SCIENCE DEPARTMENT

SPACE NAME: SCIENCE PREPARATION ROOM

USE OF SPACE - PURPOSE/ACTIVITIES:

- A. Teacher Preparation for Science Class.
- B. Accessible from two Science Classrooms.

OCCUPANTS:

- Staff 2-4
- Students N/A

SIZE AND LOCATION:

- Size 400 sq ft
- Location Science Department

FURNISHINGS AND EQUIPMENT: (Items listed below are per space)

- **In-Contract** 48" x 48" total length tackboard
48" x 48" total length whiteboard
Base and wall storage cabinets along entire perimeter wall and acid resistant countertops. Mix in full height storage cabinets. Wall cabinets to have door vision glass. Workstation with gas, deep sink, gooseneck faucet, and electric.
Microscope Storage Unit
Central Distilled Water Unit and Icemaker for Department
Safety Shower and Eyewash
Built-in Dishwasher and Microwave
Standard Refrigerator on emergency circuit
- **By Owner** Science Equipment
- **Finishes** Floor: VCT
Base: Vinyl
Walls: CMU - painted
Ceiling: suspended acoustic tile 9'-6" A.F.F.
Door: 36" X 84" with 8" x 30" vision glass
- **Electric outlets** (8) duplex outlets above countertop / Emergency Circuit for Refrigerator
- **Telecommunications** Data / Phone outlet above counter
- **Clock (Atomic)**
- **Ceiling speakers** Public Address System
- **Motion Detector** lighting control

SPECIAL CHARACTERISTICS:

- N/A

SCIENCE DEPARTMENT

SPACE NAME: STEAM LAB RESOURCE AREA

USE OF SPACE - PURPOSE/ACTIVITIES:

- A. Science, Technology, Engineering, Art & Math education space.
- B. Flexible Configuration of Room

OCCUPANTS:

- Staff 1
- Students 24

SIZE AND LOCATION:

- Size 1500 sq ft
- Location

FURNISHINGS AND EQUIPMENT: (Items listed below are per space)

- **In-Contract**
 - 120" x 48" total length tackboard
 - 192" x 48" total length whiteboard / sliding whiteboards
 - 64" Interactive whiteboard (smart technology w/ projector)
 - Flagholder and Pencil Sharpener Block on wall
 - Base and wall storage cabinets along two entire walls
 - Two deep double science room sinks with gooseneck faucets
 - Teacher wardrobe 48"w x 72"h x 24"d with lock
 - Laminated science acid resistant countertops
 - (6) Science room tables on casters (4 students each)
- **By Owner**
 - Chairs (24)
 - (1) Teacher desk, chair, computer workstation
- **Finishes**
 - Floor: VCT
 - Base: Vinyl
 - Walls: CMU - painted
 - Ceiling: suspended acoustic tile 9'-6" A.F.F.
 - Door: 36" X 84" with 8" x 30" vision glass
- **Electric outlets**
 - Double duplex at desk location / Minimum (2) duplex outlets per wall / Projector ceiling outlet / (8) duplex outlets above counter
- **Telecommunications**
 - Data / Phone outlet at teachers desk and Data outlet at opposite side of room, wireless access point, interactive white board & projector provisions / Apple TV
- **Clock (Atomic)**
- **Ceiling speakers**
 - Public Address System with Call Back
- **Motion Detector**
 - lighting control

SPECIAL CHARACTERISTICS:

- Provide window approximately 240" x 60" per classroom w/ Window Blinds
- Provide 12' wide roll-up door to exterior classroom space (minimum 1000 SF)
- HVAC provisions for roll-up door considerations (isolate space)
- Provide conduit to roof for future weather station and solar panels
- Coordinate electrical and space requirements for central analytical equipment

SCIENCE DEPARTMENT

SPACE NAME: TEACHER TEAM ROOM & LOUNGE

USE OF SPACE - PURPOSE/ACTIVITIES:

- A. Individual teachers work area and storage of professional materials.
- B. Specific Activities:
 - Teacher and staff preparation of materials
 - Space for teacher and staff files
 - Space for teacher and staff supplies and storage.

OCCUPANTS:

- **Staff** 6-8
- **Students** N/A

SIZE AND LOCATION:

- **Size** 400 sq ft
- **Location** Central to the Science Department.

FURNISHINGS AND EQUIPMENT:

- **In-Contract** 6 ft. work counter/cabinet with sink/hot and cold water
84" High Built-in Open Bookshelves (12 LF)
48" x 48" tackboard
48" x 48" whiteboard
- **By Owner** Copier Equipment
Bookcases
File Cabinets
Sofa
2 Round tables
8 Chairs
4 Lounge chairs
- **Finishes** Floor: VCT
Base: Vinyl
Walls: CMU - painted
Ceiling: Suspended acoustic tile 9'-0" A.F.F.
Door: 36" X 84" with 24" x 36" vision glass
- **Electric outlets** Minimum (2) duplex per wall, (2) duplex outlets above counter, and (1) 208V outlet for copying equipment
- **Telecommunications** (1) data outlet for copying equipment / Wireless Access Point
- **Ceiling speaker** Public Address System
- **Motion Detector** lighting control

SPECIAL CHARACTERISTICS:

- N/A

SCIENCE DEPARTMENT

SPACE NAME: SCIENCE BREAKOUT SPACE

USE OF SPACE - PURPOSE/ACTIVITIES:

A. Small student workgroups open space.

OCCUPANTS:

- **Staff** 1
- **Students** Varies

SIZE AND LOCATION:

- **Size** 200 sq ft
- **Location** Science Department - Accessible and visible from two Classrooms

FURNISHINGS AND EQUIPMENT:

- **In-Contract** 64" Interactive whiteboard (smart technology w/ projector)
- **By Owner**
- **Finishes** Floor: VCT
Base: Vinyl
Walls: CMU - painted
Ceiling: Suspended acoustic tile 9'-6" A.F.F.
- **Electric outlets** Minimum (2) duplex outlets per wall
- **Telecommunications** Data / Phone outlet, wireless access point, interactive white board & projector provisions / Apple TV
- **Ceiling speakers** Public Address System

SPECIAL CHARACTERISTICS:

- N/A

SCIENCE DEPARTMENT

SPACE NAME: ACADEMIC STORAGE ROOM

USE OF SPACE - PURPOSE/ACTIVITIES:

- A. Storage of academic supplies.

OCCUPANTS:

- **Staff** N/A
- **Students** N/A

SIZE AND LOCATION:

- **Size** 300 sq ft
- **Location** Adjacent to Teacher Work Room

FURNISHINGS AND EQUIPMENT:

- **In-Contract** 18 L.F. adjustable metal shelving units (12" deep by 84" high)
- **By Owner** N/A
- **Finishes** Floor: VCT
Base: Vinyl
Walls: CMU - painted
Ceiling: Suspended acoustic tile 9'-0" A.F.F.
Door: 36" X 80"
- **Electric outlets** Minimum (1) duplex per wall
- **Ceiling speaker** Public Address System
- **Telecommunications** Data/Phone outlet
- **Motion Detector** lighting control

SPECIAL CHARACTERISTICS:

- N/A

SPACE NAME: CHEMICAL STORAGE ROOM

USE OF SPACE - PURPOSE/ACTIVITIES:

A. Storage of chemical.

OCCUPANTS:

- Staff N/A
- Students N/A

SIZE AND LOCATION:

- Size 200 sq ft
- Location Adjacent to Teacher Work Room

FURNISHINGS AND EQUIPMENT:

- **In-Contract** Chemical Storage Cabinets
Explosion proof Refrigerator
- **By Owner** N/A
- **Finishes** Floor: VCT
Base: Vinyl
Walls: CMU - painted
Ceiling: Suspended acoustic tile 9'-0" A.F.F.
Door: 36" X 80"
- **Electric outlets** Minimum (1) duplex per wall
- **Ceiling speaker** Public Address System
- **Telecommunications** Data/Phone outlet
- **Motion Detector** lighting control

SPECIAL CHARACTERISTICS:

- **Chemical Storage Ventilation**

SCIENCE DEPARTMENT

SPACE NAME: CONTENT AREA SMALL CLASSROOM

USE OF SPACE - PURPOSE/ACTIVITIES:

- A. Student small group classroom.
- B. Flexible Configuration of Room

OCCUPANTS:

- Staff 1
- Students Varies 5-10

SIZE AND LOCATION:

- Size 400 sq ft
- Location Science Department - Accessible and visible from two Classrooms and Corridor

FURNISHINGS AND EQUIPMENT:

- **In-Contract** 120" x 48" total length tackboard
192" x 48" total length whiteboard / Sliding Whiteboard
64" Interactive whiteboard (smart technology w/ projector)
Flagholder on wall
Base and wall storage cabinets (6 ft.)
Teacher wardrobe 48"w x 72"h x 24"d with lock
36" x 120" bookcase under tackboard
Computer Charging Station
- **By Owner** Desks (5-10)
Chairs (5-10)
(1) Teacher desk, chair, computer workstation
- **Finishes** Floor: VCT
Base: Vinyl
Walls: CMU - painted
Ceiling: Suspended acoustic tile 9'-6" A.F.F.
Door: 36" X 84" with 8" x 30" vision glass
- **Electric outlets** Double duplex at desk location / Minimum (2) duplex outlets per wall
- **Telecommunications** Data / Phone outlet at teachers desk, wireless access point, interactive white board & projector provisions / Apple TV
- **Clock (Atomic)**
- **Ceiling speakers** Public Address System with Call Back
- **Motion Detector** lighting control

SPECIAL CHARACTERISTICS:

- Provide window approximately 120" x 60" per classroom
Window Blinds

SCIENCE DEPARTMENT

SPACE NAME: STAFF TOILET

USE OF SPACE - PURPOSE/ACTIVITIES:

- A. For Staff use
- B. Specific Activities:
 - Rest room facility
 - H/C accessible

OCCUPANTS:

- **Staff** 1
- **Students** N/A

SIZE AND LOCATION:

- **Size** 60 sq ft each
- **Location** Science Department

FURNISHINGS AND EQUIPMENT:

- **In-Contract** Toilet accessories
- **By Owner** N/A
- **Finishes** Floor: ceramic tile
Base: ceramic tile
Walls: ceramic tile wainscot 5'0" - CMU - painted - epoxy
Ceiling: suspended acoustic tile 8'-0" A.F.F.
Door: 36" X 84" with privacy lock
- **Ceiling speaker** Public Address System
- **Motion Detector** lighting control

SPECIAL CHARACTERISTICS:

- **ADA Accessible**

SOCIAL STUDIES DEPARTMENT

SPACE NAME: SOCIAL STUDIES COLLABORATIVE CLASSROOMS

USE OF SPACE - PURPOSE/ACTIVITIES:

- A. Teaching space for Social Studies.
- B. Flexible configuration of room
- C. Cross disciplinary Opportunity with English and World Languages

OCCUPANTS:

- Staff 1
- Students 24

SIZE AND LOCATION:

- Size 800 sq ft
- Location Social Studies Department

FURNISHINGS AND EQUIPMENT: (Items listed below are per space)

- **In-Contract**
 - 120" x 48" total length tackboard
 - 192" x 48" total length whiteboard / sliding whiteboard
 - Map Holder
 - 64" Interactive whiteboard (smart technology w/ projector)
 - Flagholder and Pencil Sharpener Block on wall
 - Base and wall storage cabinets with Countertop (8 LF)
 - Teacher wardrobe 48"w x 72"h x 24"d with lock
 - 84" High Built-in lockable bookcase (8 LF)
 - Built-in Display Case with Glass lockable doors (6 LF)
- **By Owner**
 - Desks (24)
 - Chairs (24)
 - (1) Teacher desk, chair, computer workstation
- **Finishes**
 - Floor: VCT
 - Base: Vinyl
 - Walls: CMU - painted
 - Ceiling: suspended acoustic tile 9'-6" A.F.F.
 - Door: 36" X 84" with 8" x 30" vision glass
- **Electric outlets**
 - Double duplex at desk location / Minimum (2) duplex outlets per wall / Projector ceiling outlet / Computer Charging Station
- **Telecommunications**
 - Data / Phone outlet at teachers desk and Data outlet at opposite side of room, wireless access point, interactive white board & projector provisions / Apple TV
- **Clock (Atomic)**
- **Ceiling speakers**
 - Public Address System with Call Back
- **Motion Detector**
 - lighting control

SPECIAL CHARACTERISTICS:

- **Provide window approximately 240" x 60" per classroom**
 - Window Blinds
- **Divided Classrooms** Provisions to open two sets of classrooms into one large classroom with a convenient acoustical divider

SOCIAL STUDIES DEPARTMENT

SPACE NAME: TEACHER TEAM ROOM & LOUNGE

- A. Individual teachers work area and storage of professional materials.
- B. Specific Activities:
 - Teacher and staff preparation of materials
 - Space for teacher and staff files
 - Space for teacher and staff supplies and storage.

OCCUPANTS:

- **Staff** 6-8
- **Students** N/A

SIZE AND LOCATION:

- **Size** 400 sq ft
- **Location** Central to the Social Studies Department.

FURNISHINGS AND EQUIPMENT:

- **In-Contract** 6 ft. work counter/cabinet with sink/hot and cold water
48" x 48" tackboard
48" x 48" whiteboard
- **By Owner** Copier Equipment
Bookcases
File Cabinets
Sofa
2 Round tables
8 Chairs
4 Lounge chairs
- **Finishes** Floor: VCT
Base: Vinyl
Walls: CMU - painted
Ceiling: Suspended acoustic tile 9'-0" A.F.F.
Door: 36" X 84" with 24" x 36" vision glass
- **Electric outlets** Minimum (2) duplex per wall, (2) duplex outlets above counter, and (1) 208V outlet for copying equipment
- **Telecommunications** (1) data outlet for copying equipment / Wireless Access Point
- **Ceiling speaker** Public Address System
- **Motion Detector** lighting control

SPECIAL CHARACTERISTICS:

- N/A

SOCIAL STUDIES DEPARTMENT

SPACE NAME: SOCIAL STUDIES BREAKOUT SPACE

USE OF SPACE - PURPOSE/ACTIVITIES:

A. Small student workgroups open space.

OCCUPANTS:

- **Staff** 1
- **Students** Varies

SIZE AND LOCATION:

- **Size** 200 sq ft
- **Location** Social Studies Department – accessible and visible from two classrooms

FURNISHINGS AND EQUIPMENT:

- **In-Contract** 64" Interactive whiteboard (smart technology w/ projector)
- **By Owner**
- **Finishes** Floor: VCT
Base: Vinyl
Walls: CMU - painted
Ceiling: Suspended acoustic tile 9'-6" A.F.F.
- **Electric outlets** Minimum (2) duplex outlets per wall
- **Telecommunications** Data / Phone outlet, wireless access point, interactive white board & projector provisions / Apple TV
- **Ceiling speakers** Public Address System

SPECIAL CHARACTERISTICS:

- N/A

SOCIAL STUDIES DEPARTMENT

SPACE NAME: ACADEMIC STORAGE ROOM

USE OF SPACE - PURPOSE/ACTIVITIES:

- A. Storage of academic supplies.

OCCUPANTS:

- **Staff** N/A
- **Students** N/A

SIZE AND LOCATION:

- **Size** 150 sq ft
- **Location** Adjacent to Teacher Work Room

FURNISHINGS AND EQUIPMENT:

- **In-Contract** 16 L.F. adjustable metal shelving units (12" deep by 84" high)
- **By Owner** N/A
- **Finishes** Floor: VCT
Base: Vinyl
Walls: CMU - painted
Ceiling: Suspended acoustic tile 9'-0" A.F.F.
Door: 36" X 84"
- **Electric outlets** Minimum (1) duplex per wall
- **Ceiling speaker** Public Address System
- **Telecommunications** Data/Phone outlet
- **Motion Detector** lighting control

SPECIAL CHARACTERISTICS:

- N/A

SOCIAL STUDIES DEPARTMENT

SPACE NAME: CONTENT AREA SMALL CLASSROOM

USE OF SPACE - PURPOSE/ACTIVITIES:

- A. Student small group classroom.
- B. Flexible configuration of room

OCCUPANTS:

- Staff 1
- Students Varies 5-10

SIZE AND LOCATION:

- Size 400 sq ft
- Location Social Studies Department – Accessible and visible from two Classrooms and Corridor

FURNISHINGS AND EQUIPMENT:

- **In-Contract** 120" x 48" total length tackboard
120" x 48" total length whiteboard
64" Interactive whiteboard (smart technology w/ projector)
Flagholder on wall
Base and wall storage cabinets (6 ft.)
Teacher wardrobe 48"w x 72"h x 24"d with lock
36" x 120" bookcase under tackboard
- **By Owner** Desks (5-10)
Chairs (5-10)
(1) Teacher desk, chair, computer workstation
- **Finishes** Floor: VCT
Base: Vinyl
Walls: CMU - painted
Ceiling: Suspended acoustic tile 9'-6" A.F.F.
Door: 36" X 84" with 8" x 30" vision glass
- **Electric outlets** Double duplex at desk location / Minimum (2) duplex outlets per wall / Computer Charging Station
- **Telecommunications** Data / Phone outlet at teachers desk, wireless access point, interactive white board & projector provisions / Apple TV
- **Clock (Atomic)**
- **Ceiling speakers** Public Address System with Call Back
- **Motion Detector** lighting control

SPECIAL CHARACTERISTICS:

- **Provide window approximately 120" x 60" per classroom**
Window Blinds

SOCIAL STUDIES DEPARTMENT

SPACE NAME: STAFF TOILET

USE OF SPACE - PURPOSE/ACTIVITIES:

- A. For Staff use
- B. Specific Activities:
 - Rest room facility
 - H/C accessible

OCCUPANTS:

- **Staff** 1
- **Students** N/A

SIZE AND LOCATION:

- **Size** 60 sq ft each
- **Location**

FURNISHINGS AND EQUIPMENT:

- **In-Contract** Toilet accessories
- **By Owner** N/A
- **Finishes** Floor: ceramic tile
Base: ceramic tile
Walls: ceramic tile wainscot 5'-0" - CMU - painted - epoxy
Ceiling: suspended acoustic tile 8'-0" A.F.F.
Door: 36" X 84" with privacy lock
- **Ceiling speaker** Public Address System
- **Motion Detector** lighting control

SPECIAL CHARACTERISTICS:

- **ADA Accessible**

WORLD LANGUAGE DEPARTMENT

SPACE NAME: LARGE GROUP CALSSROOM

USE OF SPACE - PURPOSE/ACTIVITIES:

- A. Teaching space for Languages
- B. Flexible configuration of room
- C. Cross disciplinary opportunity with Social Studies

OCCUPANTS:

- Staff 1
- Students 24

SIZE AND LOCATION:

- Size 800 sq ft
- Location

FURNISHINGS AND EQUIPMENT: (Items listed below are per space)

- **In-Contract** 120" x 48" total length tackboard
192" x 48" total length whiteboard / sliding whiteboard
64" Interactive whiteboard (smart technology w/ projector)
Flagholder and Pencil Sharpener Block on wall
Base and wall storage cabinets with Countertop (12 LF)
Teacher wardrobe 48"w x 72"h x 24"d with lock
84" High Built-in Open Bookshelf (4 LF)
Built-in Display Case with lockable glass doors (6 LF)
- **By Owner** Desks (24)
Chairs (24)
(1) Teacher desk, chair, computer workstation
- **Finishes** Floor: VCT
Base: Vinyl
Walls: CMU - painted
Ceiling: suspended acoustic tile 9'-6" A.F.F.
Door: 36" X 84" with 8" x 30" vision glass
- **Electric outlets** Double duplex at desk location / Minimum (2) duplex outlets per wall
/ Projector ceiling outlet / Computer Charging Station
- **Telecommunications** Data / Phone outlet at teachers desk and Data outlet at opposite side
of room, wireless access point, interactive white board & projector
provisions / Apple TV
- **Clock (Atomic)**
- **Ceiling speakers** Public Address System with Call Back
- **Motion Detector** lighting control

SPECIAL CHARACTERISTICS:

- **Provide window approximately 240" x 60" per classroom**
Window Blinds
- **Divided Classrooms** Provisions to open two sets of classrooms into one large classroom
with a convenient acoustical divider.

WORLD LANGUAGE DEPARTMENT

SPACE NAME: SMALL GROUP CLASSROOM

USE OF SPACE - PURPOSE/ACTIVITIES:

- A. Teaching space for Languages.
- B. Flexible Configuration of Room

OCCUPANTS:

- Staff 1
- Students Varies 5-10

SIZE AND LOCATION:

- Size 400 sq ft
- Location World Language Department – Accessible and visible from tow Classrooms and Corridor

FURNISHINGS AND EQUIPMENT:

- **In-Contract** 120" x 48" total length tackboard
192" x 48" total length whiteboard
64" Interactive whiteboard (smart technology w/ projector)
Flagholder on wall
Base and wall storage cabinets (6 ft.)
Teacher wardrobe 48"w x 72"h x 24"d with lock
36" x 120" bookcase under tackboard
- **By Owner** Desks (5-10)
Chairs (5-10)
(1) Teacher desk, chair, computer workstation
- **Finishes** Floor: VCT
Base: Vinyl
Walls: CMU - painted
Ceiling: Suspended acoustic tile 9'-6" A.F.F.
Door: 36" X 84" with 8" x 30" vision glass
- **Electric outlets** Double duplex at desk location / Minimum (2) duplex outlets per wall / Computer Charging Station
- **Telecommunications** Data / Phone outlet at teachers desk, wireless access point, interactive white board & projector provisions / Apple TV
- **Clock (Atomic)**
- **Ceiling speakers** Public Address System with Call Back
- **Motion Detector** lighting control

SPECIAL CHARACTERISTICS:

- **Provide window approximately 120" x 60" per classroom**
Window Blinds

WORLD LANGUAGE DEPARTMENT

SPACE NAME: LANGUAGE BREAKOUT SPACE

USE OF SPACE - PURPOSE/ACTIVITIES:

A. Small student workgroups open space.

OCCUPANTS:

- **Staff** 1
- **Students** Varies

SIZE AND LOCATION:

- **Size** 200 sq ft
- **Location** Along corridor in World Language Department

FURNISHINGS AND EQUIPMENT:

- **In-Contract** 64" Interactive whiteboard (smart technology w/ projector)
- **By Owner**
- **Finishes** Floor: VCT
Base: Vinyl
Walls: CMU - painted
Ceiling: Suspended acoustic tile 9'-6" A.F.F.
- **Electric outlets** Minimum (2) duplex outlets per wall
- **Telecommunications** Data / Phone outlet, wireless access point, interactive white board & projector provisions / Apple TV
- **Clock (Atomic)**
- **Ceiling speakers** Public Address System with Call Back

SPECIAL CHARACTERISTICS:

- **Acoustic Isolation of room**

WORLD LANGUAGE DEPARTMENT

SPACE NAME: TEACHER TEAM ROOM & LOUNGE

- A. Individual teachers work area and storage of professional materials.
- B. Specific Activities:
 - Teacher and staff preparation of materials
 - Space for teacher and staff files
 - Space for teacher and staff supplies and storage.

OCCUPANTS:

- **Staff** 6-8
- **Students** N/A

SIZE AND LOCATION:

- **Size** 400 sq ft
- **Location** Central to the World Language Department.

FURNISHINGS AND EQUIPMENT:

- **In-Contract** 6 ft. work counter/cabinet with sink/hot and cold water
48" x 48" tackboard
48" x 48" whiteboard
- **By Owner** Copier Equipment
Bookcases
File Cabinets
Sofa
2 Round tables
8 Chairs
4 Lounge chairs
- **Finishes** Floor: VCT
Base: Vinyl
Walls: CMU - painted
Ceiling: Suspended acoustic tile 9'-0" A.F.F.
Door: 36" X 84" with 24" x 36" vision glass
- **Electric outlets** Minimum (2) duplex per wall, (2) duplex outlets above counter, and (1) 208V outlet for copying equipment
- **Telecommunications** (1) data outlet for copying equipment
- **Ceiling speaker** Public Address System
- **Motion Detector** lighting control

SPECIAL CHARACTERISTICS:

- N/A

WORLD LANGUAGE DEPARTMENT

SPACE NAME: ACADEMIC STORAGE ROOM

USE OF SPACE - PURPOSE/ACTIVITIES:

- A. Storage of academic supplies.

OCCUPANTS:

- **Staff** N/A
- **Students** N/A

SIZE AND LOCATION:

- **Size** 300 sq ft
- **Location** Adjacent to Teacher Work Room

FURNISHINGS AND EQUIPMENT:

- **In-Contract** 18 L.F. adjustable metal shelving units (12" deep by 84" high)
- **By Owner** N/A
- **Finishes** Floor: VCT
Base: Vinyl
Walls: CMU - painted
Ceiling: Suspended acoustic tile 9'-0" A.F.F.
Door: 36" X 84"
- **Electric outlets** Minimum (1) duplex per wall
- **Ceiling speaker** Public Address System
- **Telecommunications** Data/Phone outlet
- **Motion Detector** lighting control

SPECIAL CHARACTERISTICS:

- N/A

WORLD LANGUAGE DEPARTMENT

SPACE NAME: CONTENT AREA SMALL CLASSROOM

USE OF SPACE - PURPOSE/ACTIVITIES:

- A. Student small classroom space.
- B. Flexible Configuration of Room

OCCUPANTS:

- Staff 1
- Students Varies 5-10

SIZE AND LOCATION:

- Size 400 sq ft
- Location World Language Department – Accessible and visible from two Classrooms and Corridor

FURNISHINGS AND EQUIPMENT:

- **In-Contract** 120" x 48" total length tackboard
192" x 48" total length whiteboard
64" Interactive whiteboard (smart technology w/ projector)
Flagholder on wall
Base and wall storage cabinets (6 ft.)
Teacher wardrobe 48"w x 72"h x 24"d with lock
36" x 120" bookcase under tackboard
- **By Owner** Desks (5-10)
Chairs (5-10)
(1) Teacher desk, chair, computer workstation
- **Finishes** Floor: VCT
Base: Vinyl
Walls: CMU - painted
Ceiling: Suspended acoustic tile 9'-6" A.F.F.
Door: 36" X 84" with 8" x 30" vision glass
- **Electric outlets** Double duplex at desk location / Minimum (2) duplex outlets per wall / Computer Charging Station
- **Telecommunications** Data / Phone outlet at teachers desk, wireless access point, interactive white board & projector provisions / Apple TV
- **Clock (Atomic)**
- **Ceiling speakers** Public Address System with Call Back
- **Motion Detector** lighting control

SPECIAL CHARACTERISTICS:

- **Provide window approximately 120" x 60" per classroom**
Window Blinds

WORLD LANGUAGE DEPARTMENT

SPACE NAME: STAFF TOILET

USE OF SPACE - PURPOSE/ACTIVITIES:

- A. For Staff use
- B. Specific Activities:
 - Rest room facility
 - H/C accessible

OCCUPANTS:

- **Staff** 1
- **Students** N/A

SIZE AND LOCATION:

- **Size** 60 sq ft each
- **Location** World Language Department

FURNISHINGS AND EQUIPMENT:

- **In-Contract** Toilet accessories
- **By Owner** N/A
- **Finishes** Floor: ceramic tile
Base: ceramic tile
Walls: ceramic tile wainscot 5'0" - CMU - painted - epoxy
Ceiling: suspended acoustic tile 8'-0" A.F.F.
Door: 36" X 84" with privacy lock
- **Ceiling speaker** Public Address System
- **Motion Detector** lighting control

SPECIAL CHARACTERISTICS:

- **ADA Accessible**

INTER-DISCIPLINARY

SPACE NAME: LIBRARY MEDIA SERVICES – MEDIA CENTER

USE OF SPACE - PURPOSE/ACTIVITIES:

- A. Provide three distinct seating areas to handle up to three classes at a time exclusive of reading spaces. One of these areas should be able to be darkened for audiovisual presentations. The entire media center should be open with easy visual control.
- B. Provide working/reading space for individuals and small groups (about 25-35 students total). This area should be close to the circulation desk near the reference books, periodical display, and paperback racks. Leisure furniture is desirable in this location in addition to tables and chairs.
- C. Provide shelving for the print collection for students. There are distinct collections that have special requirements and it is important that the linear footage estimates be considered so that collections can be easily marked up for students. The shelving should hold at least 15,000 books in main library (approximately 10 books/linear foot). All bookshelves not built-in against a wall should be low movable units on wheels.
- D. Media Center should be flexible with all furnishings easy to move.

OCCUPANTS:

- Staff 3
- Students 75

SIZE AND LOCATION:

- Size 4,000 sq ft
- Location As close to the center of the building as possible. Use of Media Center should be possible after hours without violating security.

FURNISHINGS AND EQUIPMENT:

- **In-Contract** Fixed Wall and Mobile Bookshelves for 15,000 books
Built-in Casework for Circulation Desk - 39" high. Provide book return and computer space for two people. Additional book return through Corridor wall.
144" x 48" tackboard
144" x 48" white marker board
(2) 64" interactive white boards (smart technology w/ projector)
Printer Station
Presenters station with permanent computer, audio system control, and projector configured for quick and easy use.
- **By Owner** Chairs (80)
Lounge chairs (4)
End table (2)
File 4-drawer (3)
Tables 48" round (25)
Paperback racks (2)
- **Finishes** Floor: Carpet
Base: Vinyl
Walls: CMU - painted
Ceiling: Suspended acoustic tile 12'-0" A.F.F.
Doors: 36" X 84" with 24" x 36" vision glass

INTER-DISCIPLINARY

- **Light Switches** Three-way light switches for entire Media Center should be located at main entrance and at each instructional area. Zone lighting into three group areas and **reading areas**.
- **Electric outlets** Minimum **(24)** duplex outlets, Double duplex at circulation desk locations, floor outlets where applicable, **Computer Charging Station**
- **Telecommunications** (3) Data Outlets & (1) Phone outlet at circulation desk, (6) Data Outlets, **(4) Data Outlets at printer station**, (4) wireless access points, (2) interactive white boards & projectors provisions, (2) Apple TV
- **Clock (Atomic)**
- **Ceiling Speakers** (4) minimum / Public Address System with Call Back
- **Audio System** **(12)** Speakers **arranged in (3) Zones** / Local audio system w/ microphone jacks
- **Motion detector(s)** lighting controls

SPECIAL CHARACTERISTICS:

- **Book security system at entrance doors**
- **Layout shelves and aisles for visual supervision from circulation desk.**
- **Interior Windows to Corridor**
- **Maximize Natural Lighting w/ Window Blinds**
- **Provide an open Café Area with hard flooring, beverage “bar”, and café seating**
- **Provide reading area with Fireplace**

INTER-DISCIPLINARY

SPACE NAME: LIBRARY MEDIA SERVICES – OFFICE

USE OF SPACE - PURPOSE/ACTIVITIES:

- A. Specific Activities:
- Librarian Office Space

OCCUPANTS:

- **Staff** 1
- **Students** N/A

SIZE AND LOCATION:

- **Size** 150 sq ft
- **Location** Adjacent to circulation desk. Good visibility of library from office

FURNISHINGS AND EQUIPMENT:

- **In-Contract** 48" x 48" tackboard
48" x 48" white board
- **By Owner** Desk
Chair
2 side chairs
- **Finishes** Floor: Carpet
Base: Vinyl
Walls: CMU - painted
Ceiling: suspended acoustic tile 9'-0" A.F.F.
Door: 36" X 84" with 8" x 30" vision glass
Vision Glass to Media Center
- **Electric outlets** Double duplex at desk location / Minimum (1) duplex outlet per wall
- **Telecommunications** Data / Phone outlets at desk
- **Ceiling speakers** Public Address System
- **Motion Detector** lighting control

SPECIAL CHARACTERISTICS:

- **Provide visual windows between office and media center**
Window Blinds

INTER-DISCIPLINARY

SPACE NAME: LIBRARY MEDIA SERVICES – WORKROOM

USE OF SPACE - PURPOSE/ACTIVITIES:

- A. Librarian work area and storage of professional materials.
- B. Specific Activities:
 - Librarian and staff preparation of materials
 - Space for Librarian and staff files
 - Space for Librarian and staff supplies and storage.

OCCUPANTS:

- Staff 3
- Students N/A

SIZE AND LOCATION:

- Size 400 sq ft
- Location Accessible from Librarian's Offices.

FURNISHINGS AND EQUIPMENT:

- **In-Contract** Base and wall cabinets with countertop (24 LF)
Sink with hot and cold water
84" High built-in bookcase (8 LF)
Center worktable
48" x 48" tackboard
48" x 48" whiteboard
- **By Owner** Copier Equipment
Bookcases
File Cabinets
Table
4 Chairs
- **Finishes** Floor: VCT
Base: Vinyl
Walls: CMU - painted
Ceiling: Suspended acoustic tile 9'-0" A.F.F.
Door: 36" X 84" with 24" x 36" vision glass
- **Electric outlets** Minimum (2) duplex per wall, (2) duplex outlets above counter, and (1) 208V outlet for copying equipment
- **Telecommunications** (1) data outlet for copying equipment
- **Ceiling speaker** Public Address System
- **Motion Detector** lighting control

SPECIAL CHARACTERISTICS:

- N/A

INTER-DISCIPLINARY

SPACE NAME: LIBRARY MEDIA SERVICES – STAFF TOILET

USE OF SPACE - PURPOSE/ACTIVITIES:

- A. For Staff use
- B. Specific Activities:
 - Rest room facility
 - H/C accessible

OCCUPANTS:

- **Staff** 1
- **Students** N/A

SIZE AND LOCATION:

- **Size** 60 sq ft each
- **Location**

FURNISHINGS AND EQUIPMENT:

- **In-Contract** Toilet accessories
- **By Owner** N/A
- **Finishes** Floor: ceramic tile
Base: ceramic tile
Walls: ceramic tile wainscot 5'-0" - CMU - painted - epoxy
Ceiling: suspended acoustic tile 8'-0" A.F.F.
Door: 36" X 84" with privacy lock
- **Ceiling speaker** Public Address System
- **Motion Detector** lighting control

SPECIAL CHARACTERISTICS:

- **ADA Accessible**

INTER-DISCIPLINARY

SPACE NAME: LIBRARY MEDIA SERVICES – COLLABORATIVE CLASSROOM

USE OF SPACE - PURPOSE/ACTIVITIES:

- A. Teaching space for Media Center.
- B. Ability to open classroom to Media Center

OCCUPANTS:

- Staff 1
- Students 24

SIZE AND LOCATION:

- Size 800 sq ft
- Location

FURNISHINGS AND EQUIPMENT: (Items listed below are per space)

- **In-Contract** 120" x 48" total length tackboard
192" x 48" total length whiteboard
64" Interactive whiteboard (smart technology w/ projector)
Flagholder on wall
Base and wall storage cabinets (6 ft.)
Teacher wardrobe 48"w x 72"h x 24"d with lock
- **By Owner** Desks (24)
Chairs (24)
(1) Teacher desk, chair, computer workstation
- **Finishes** Floor: VCT
Base: Vinyl
Walls: CMU - painted
Ceiling: suspended acoustic tile 9'-6" A.F.F.
Door: 36" X 84" with 8" x 30" vision glass
- **Electric outlets** Double duplex at desk location / Minimum (2) duplex outlets per wall
/ Projector ceiling outlet
- **Telecommunications** Data / Phone outlet at teachers desk and Data outlet at opposite side
of room, wireless access point, interactive white board & projector
provisions / Apple TV
- **Clock (Atomic)**
- **Ceiling speakers** Public Address System with Call Back
- **Motion Detector** lighting control

SPECIAL CHARACTERISTICS:

- **Provide window approximately 240" x 60" per classroom**
Window Blinds

INTER-DISCIPLINARY

SPACE NAME: LIBRARY MEDIA SERVICES – COLLABORATIVE CLASSROOM

USE OF SPACE - PURPOSE/ACTIVITIES:

- A. Teaching Space for Media Center.
- B. Ability to open classroom to Media Center

OCCUPANTS:

- **Staff** 1
- **Students** Varies 10-12

SIZE AND LOCATION:

- **Size** 500 sq ft
- **Location**

FURNISHINGS AND EQUIPMENT:

- **In-Contract** 120" x 48" total length tackboard
192" x 48" total length whiteboard
64" Interactive whiteboard (smart technology w/ projector)
Flagholder on wall
Base and wall storage cabinets one full wall
Teacher wardrobe 48"w x 72"h x 24"d with lock
- **By Owner** Desks (10-12)
Chairs (10-12)
(1) Teacher desk, chair, computer workstation
- **Finishes** Floor: VCT
Base: Vinyl
Walls: CMU - painted
Ceiling: Suspended acoustic tile 9'-6" A.F.F.
Door: 36" X 84" with 8" x 30" vision glass
- **Electric outlets** Double duplex at desk location / Minimum (2) duplex outlets per wall
- **Telecommunications** Data / Phone outlet at teachers desk, wireless access point, interactive white board & projector provisions / Apple TV
- **Clock (Atomic)**
- **Ceiling speakers** Public Address System with Call Back
- **Motion Detector** lighting control

SPECIAL CHARACTERISTICS:

- **Provide window approximately 120" x 60" per classroom**
Window Blinds

INTER-DISCIPLINARY

SPACE NAME: LIBRARY MEDIA SERVICES – DESIGN LAB

OCCUPANTS:

- Staff 1
- Students 24

SIZE AND LOCATION:

- Size 1600 sq ft
- Location Adjacent Media Center / Access from Media Center

FURNISHINGS AND EQUIPMENT: (Items listed below are per space)

- **In-Contract** 192" x 48" total length whiteboard / sliding whiteboard
64" Interactive whiteboard (smart technology w/ projector)
Flagholder on wall
Base and wall storage cabinets along two entire walls
One deep double sink with gooseneck faucet
Teacher wardrobe 48"w x 72"h x 24"d with lock
Provisions for material storage
(4) Shop Worktables on wheels
Shop Equipment TBD
- **By Owner** (1) Teacher desk, chair, computer workstation
- **Finishes** Floor: VCT
Base: Vinyl
Walls: CMU - painted
Ceiling: suspended acoustic tile 9'-6" A.F.F.
Door: 36" X 84" with 8" x 30" vision glass
- **Electric outlets** Double duplex at desk location / Minimum (2) duplex outlets per wall
/ Projector ceiling outlet / Quad Ceiling Electric Reals over
Worktables / Power strips above counter space / Coordinate
electrical requirements for shop equipment.
- **Telecommunications** Data / Phone outlet at teachers desk and Data outlet at opposite side
of room, wireless access point, interactive white board & projector
provisions / Apple TV
- **Clock (Atomic)**
- **Ceiling speakers** Public Address System with Call Back
- **Motion Detector** lighting control

SPECIAL CHARACTERISTICS:

- **Provide window approximately 240" x 60" per classroom**
Window Blinds
- **Windows to Media Center for visual control of space**
- **Sound Isolation from Media Center**
- **Ventilation system for shop equipment and worktables**

INTER-DISCIPLINARY

SPACE NAME: LIBRARY MEDIA SERVICES – DESIGN STUDIO

OCCUPANTS:

- Staff 1
- Students 24

SIZE AND LOCATION:

- Size 900 sq ft
- Location

FURNISHINGS AND EQUIPMENT: (Items listed below are per space)

- **In-Contract** 192" x 48" total length whiteboard / sliding whiteboard
64" Interactive whiteboard (smart technology w/ projector)
Flagholder on wall
Base and wall storage cabinets along two entire walls
One deep double sink with gooseneck faucet
Teacher wardrobe 48"w x 72"h x 24"d with lock
Recording / TV Studio Equipment
(2) Shop Worktables on wheels
- **By Owner** (1) Teacher desk, chair, computer workstation
- **Finishes** Floor: VCT
Base: Vinyl
Walls: CMU - painted
Ceiling: suspended acoustic tile 9'-6" A.F.F.
Door: 36" X 84" with 8" x 30" vision glass
- **Electric outlets** Double duplex at desk location / Minimum (2) duplex outlets per wall
/ Projector ceiling outlet / Quad Ceiling Electric Reals over
Worktables / Power strips above counter space
- **Telecommunications** Data / Phone outlet at teachers desk and Data outlet at opposite side
of room, wireless access point, interactive white board & projector
provisions / Apple TV
- **Clock (Atomic)**
- **Ceiling speakers** Public Address System with Call Back
- **Motion Detector** lighting control

SPECIAL CHARACTERISTICS:

- Provide window approximately 240" x 60" per classroom
Window Blinds
- Windows to Media Center for visual control of space
- Sound Isolation from Media Center

INTER-DISCIPLINARY

SPACE NAME: LIBRARY MEDIA SERVICES – SMALL GROUP / CONFERENCE

USE OF SPACE - PURPOSE/ACTIVITIES:

A. Conference room for librarian.

OCCUPANTS:

- **Staff** 8
- **Students** N/A

SIZE AND LOCATION:

- **Size** 300 sq ft
- **Location** One adjacent to librarian's office with connecting door.

FURNISHINGS AND EQUIPMENT:

- **In-Contract** 4' x 8' tackboard
4' x 4' white marker board
64" Interactive whiteboard (smart technology w/ projector)
- **By Owner** Table
Chairs
- **Finishes** Floor: Carpet
Base: Vinyl
Walls: CMU - painted
Ceiling: Suspended acoustic tile 9'-0" A.F.F.
Door: 36" X 84" with 8"x30" vision glass
- **Electric outlets** Minimum (1) duplex per wall / Projector ceiling outlet
- **Ceiling speaker** Public Address System
- **Telecommunications** Data/Phone outlet / Interactive White Board / Projector provisions / Apple TV
- **Ceiling speaker** Public Address System
- **Motion Detector** lighting control

SPECIAL CHARACTERISTICS:

- N/A

INTER-DISCIPLINARY

SPACE NAME: LIBRARY MEDIA SERVICES – DIGITAL TECHNOLOGY STORAGE

USE OF SPACE - PURPOSE/ACTIVITIES:

- A. Storage of technology and related supplies.

OCCUPANTS:

- **Staff** N/A
- **Students** N/A

SIZE AND LOCATION:

- **Size** 500 sq ft
- **Location**

FURNISHINGS AND EQUIPMENT:

- **In-Contract** 18 L.F. adjustable metal shelving units (12" deep by 84" high)
- **By Owner** N/A
- **Finishes** Floor: VCT
Base: Vinyl
Walls: CMU - painted
Ceiling: Suspended acoustic tile 9'-0" A.F.F.
Door: 36" X 84"
- **Electric outlets** Minimum (3) duplex per wall / **Charging Stations**
- **Ceiling speaker** Public Address System
- **Telecommunications** Data/Phone outlet
- **Motion Detector** lighting control

SPECIAL CHARACTERISTICS:

- N/A

INTER-DISCIPLINARY

SPACE NAME: INTERDISCIPLINARY RESOURCES – PRESENTATION ARENA

USE OF SPACE - PURPOSE/ACTIVITIES:

A. Presentations

OCCUPANTS:

- **Staff** 1
- **Students** Varies

SIZE AND LOCATION:

- **Size** 1000 sq ft
- **Location**

FURNISHINGS AND EQUIPMENT:

- **In-Contract** 120" x 48" total length tackboard
192" x 48" total length whiteboard
64" Interactive whiteboard (smart technology w/ projector)
Built in Seating for 50
- **By Owner**
- **Finishes** Floor: VCT
Base: Vinyl
Walls: CMU - painted
Ceiling: Suspended acoustic tile 12'-0" A.F.F.
Doors: 36" X 84" with 8" x 30" vision glass
- **Electric outlets** Minimum (2) duplex outlets per wall
- **Telecommunications** Data / Phone outlet at teachers desk, wireless access point, interactive white board & projector provisions / Apple TV
- **Audio System** (4) Speakers / Local audio system
- **Ceiling speakers** Public Address System
- **Motion Detector** lighting control

SPECIAL CHARACTERISTICS:

- N/A

INTER-DISCIPLINARY

SPACE NAME: INTERDISCIPLINARY RESOURCES – SMALL GROUP / IND. ASSESSMENT

USE OF SPACE - PURPOSE/ACTIVITIES:

A. Student support.

OCCUPANTS:

- **Staff** 1
- **Students** Varies 1-4

SIZE AND LOCATION:

- **Size** 200 sq ft
- **Location**

FURNISHINGS AND EQUIPMENT:

- **In-Contract** 72" x 48" total length tackboard
72" x 48" total length whiteboard
- **By Owner** Desks (4)
Chairs (4)
(1) Teacher desk, chair, computer workstation
- **Finishes** Floor: VCT
Base: Vinyl
Walls: CMU - painted
Ceiling: Suspended acoustic tile 9'-6" A.F.F.
Door: 36" X 84" with 8" x 30" vision glass
- **Electric outlets** Minimum (2) duplex outlets per wall
- **Telecommunications** Data / Phone outlet
- **Ceiling speakers** Public Address System
- **Motion Detector** lighting control

SPECIAL CHARACTERISTICS:

- **NA**

INTER-DISCIPLINARY

SPACE NAME: INTERDISCIPLINARY RESOURCES – HYBRID LEARNING
CENTER

USE OF SPACE - PURPOSE/ACTIVITIES:

A.

OCCUPANTS:

- **Staff** 1
- **Students** Varies

SIZE AND LOCATION:

- **Size** 1500 sq ft
- **Location**

FURNISHINGS AND EQUIPMENT:

- **In-Contract** 120" x 48" total length tackboard
192" x 48" total length whiteboard
64" Interactive whiteboard (smart technology w/ projector)
Flagholder on wall
Base and wall storage cabinets two full walls
Teacher wardrobe 48"w x 72"h x 24"d with lock
- **By Owner** Chairs
(1) Teacher desk, chair, computer workstation
Comfortable Seating for small groups
- **Finishes** Floor: VCT
Base: Vinyl
Walls: CMU - painted
Ceiling: Suspended acoustic tile 12'-0" A.F.F.
Door: 36" X 84" with 8" x 30" vision glass
- **Electric outlets** Double duplex at desk location / Minimum (2) duplex outlets per wall
/ Minimum (8) duplex outlets above counter
- **Telecommunications** Data / Phone outlet at teachers desk, wireless access point,
interactive white board & projector provisions / Apple TV
- **Clock (Atomic)**
- **Ceiling speakers** Public Address System with Call Back
- **Motion Detector** lighting control

SPECIAL CHARACTERISTICS:

- **Provide window approximately 240" x 60" per classroom**
Window Blinds

ART – PERFORMING AND DESIGN DEPARTMENT

SPACE NAME: VISUAL ARTS – DESIGN LAB

USE OF SPACE - PURPOSE/ACTIVITIES:

- A. Art space for drawing, painting, print making, sculpturing, and crafts to make an aesthetic product.

OCCUPANTS:

- Staff 1
- Students 24

SIZE AND LOCATION:

- Size 1200 sq ft
- Location

FURNISHINGS AND EQUIPMENT: (Items listed below are per space)

- **In-Contract** See typical art lab equipment layout and schedule
120" x 48" tackboard
192" x 48" whiteboard
64" Interactive whiteboard (smart technology w/ projector)
Flag Holder and Pencil Sharpener Block
- **By Owner** Stools (24)
(1) Teacher desk, chair, computer workstation
- **Finishes** Floor: VCT
Base: Vinyl
Walls: CMU - painted (epoxy)
Ceiling: Suspended acoustic tile 9'-6" A.F.F.
Door: 36" X 84" with 8" x 30" vision glass
- **Electric outlets** for general use (12) – coordinate with counters / Provide power strip at computer counter
- **Telecommunications** Data / Phone outlet at teachers desk and Data at opposite side of room, wireless access point, interactive white board & projector provisions / Apple TV
- **Clock (Atomic)**
- **Ceiling speakers** Public Address System with Call Back
- **Motion Detector** lighting control

SPECIAL CHARACTERISTICS:

- Provide window approximately 240" x 60" per classroom
Window Blinds
- Each set of two Design Labs should be open to each other with a separation "wall" spanning ¾ the length of the space.

ART - PERFORMANCE AND DESIGN DEPARTMENT

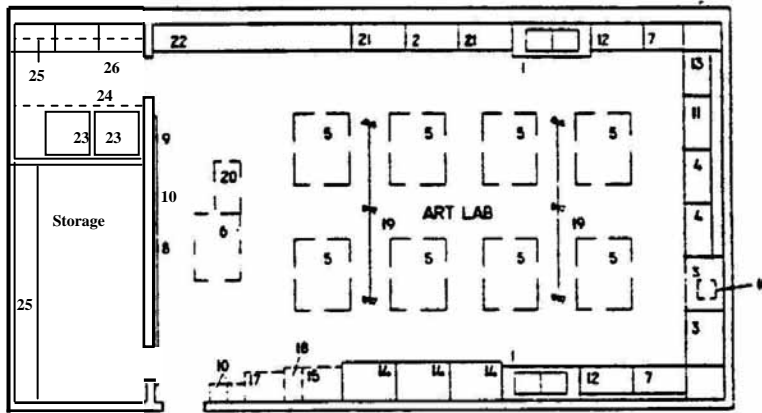

SAMPLE DESIGN LAB (See Included items below)

GENERAL REQUIREMENTS:

- PROVIDE NATURAL LIGHT
- (2) DOUBLE STAINLESS STEEL SINK BASINS, WITH HOT & COLD WATER
- ALL COUNTER TOPS TO BE 1 1/4" PLASTIC LAMINATE
- ALL CABINETS SHALL BE LOCKABLE AND KEYED ALIKE
- PROVIDE (12) ELECTRIC RECEPTACLES MINIMUM
- (1) FIRE EXTINGUISHER
- (2) PAPER TOWEL DISPENSERS
- (1) SOAP DISPENSERS

EQUIPMENT LIST: SEE ATTACHED FLOOR PLAN

- | | |
|---|-----------------------|
| 1. (2) SINK ASSEMBLY WITH (2) 24" x 22" x 10" SINK BASINS | 72"L. X 30"D. X 36"H. |
| 2. (1) BASE CABINET | 48"L. X 24"D. X 36"H. |
| 3. (2) SCULPTURE STORAGE CABINET | 48"L. X 34"D. X 36"H. |
| 4. (2) DRAWING BOARD STORAGE CABINET | 48"L. X 24"D. X 84"H. |
| 5. (6) STUDENT WORK TABLES WITH PEDESTAL BASES | 64"L. X 50"D. X 34"H |
| 6. WORK BENCH/TEACHER'S STATION | 60"L. X 42"D. X 30:H. |
| 7. (2) BASE CABINET | 24"D. X 36"H. |
| 8. TACKBOARD (BEHIND TEACHER) | 4' H X 10' L |
| 9. WHITE MARKER BOARD | 4' H X 16' L |
| 10. GRAY BOARD (FOR PROJECTOR) | 4' H X 6' L |
| 11. (1) TOOL STORAGE CASES | 48"L. X 22"D. X 84"H. |
| 12. (2) TOTE TRAY STORAGE CABINET | 48"L. X 24"D. X 36"H. |
| 13. SPRAY BOOTH | 48"L. X 24"D. X 84"H. |
| 14. (3) FLAT STORAGE CABINETS | 48"L. X 34"D. X 36"H. |
| 15. PAPER CUTTER TABLE - NIC | 36"L. X 30"D. X 36"H. |
| 16. PAPER CUTTER COUNTERTOP MODEL (NIC) | |
| 17. DRYING RACK - NIC | 36"L. X 26"D. X 48"H. |
| 18. ART PRESS - NIC | 16"L. X 30"D. |
| 20. TEACHER'S DESK - NIC | |
| 21. DRAWER BASE CABINET | |
| 22. COMPUTER COUNTER | 15' L X 28" D X 27" H |

KILN ROOM

GENERAL REQUIREMENTS:

- ALL CABINETS SHALL BE LOCKABLE AND KEYED ALIKE
- (1) PAPER TOWEL DISPENSER
- (1) FIRE EXTINGUISHER
- GOOD VENTILATION NEEDED

EQUIPMENT LIST: SEE ATTACHED FLOOR PLAN

- | | |
|--|---------------|
| 23. (2) KILNS | 42"L. X 42"D. |
| 24. EXHAUST HOOD | |
| 25. OPEN WALL MOUNTED SHELVING | 12"D. |
| 26. BASE CABINETS WITH OPEN SHELVING ABOVE | 24"D. X 36"H. |

ART - PERFORMANCE AND DESIGN DEPARTMENT

SPACE NAME: VISUAL ARTS – TEACHER TEAM ROOM & LOUNGE

USE OF SPACE - PURPOSE/ACTIVITIES:

- A. Individual teachers work area and storage of professional materials. (Visual Arts Team Room & Performing Arts Team Room)
- B. Specific Activities:
 - Teacher and staff preparation of materials
 - Space for teacher and staff files
 - Space for teacher and staff supplies and storage.
- C. Visual Arts Teacher Team Room – Window and visual control over Design Labs
- D. Performing Arts Teacher Team Room – Window and visual control over Band Room & Black Box Theater

OCCUPANTS:

- **Staff** 6-8
- **Students** N/A

SIZE AND LOCATION:

- **Size** 400 sq ft
- **Location** Split between Visual and Performing Arts.

FURNISHINGS AND EQUIPMENT:

- **In-Contract** 6 ft. work counter/cabinet with sink/hot and cold water
48" x 48" tackboard
48" x 48" whiteboard
- **By Owner** Copier Equipment
Bookcases
File Cabinets
Sofa
2 Round tables
8 Chairs
4 Lounge chairs
- **Finishes** Floor: VCT
Base: Vinyl
Walls: CMU - painted
Ceiling: Suspended acoustic tile 9'-0" A.F.F.
Door: 36" X 84" with 24" x 36" vision glass
- **Electric outlets** Minimum (2) duplex per wall, (2) duplex outlets above counter, and (1) 208V outlet for copying equipment
- **Telecommunications** (1) data outlet for copying equipment
- **Ceiling speaker** Public Address System
- **Motion Detector** lighting control

SPECIAL CHARACTERISTICS:

- **Exterior Window**

ART - PERFORMANCE AND DESIGN DEPARTMENT

SPACE NAME: VISUAL ARTS – ART STORAGE

USE OF SPACE - PURPOSE/ACTIVITIES:

- A. Storage of art supplies.

OCCUPANTS:

- Staff N/A
- Students N/A

SIZE AND LOCATION:

- Size 450 sq ft
- Location Adjacent to Design Lab – Between two Design Labs with a Door to each.

FURNISHINGS AND EQUIPMENT:

- In-Contract 24 L.F. adjustable metal shelving units (12" deep by 84" high)
- By Owner N/A
- Finishes Floor: VCT
Base: Vinyl
Walls: CMU - painted
Ceiling: Suspended acoustic tile 9'-0" A.F.F.
Door: 36" X 84" with 8" x 30" vision glass and lock
- Electric outlets (1) duplex outlet per wall
- Ceiling speaker Public Address System
- Telecommunications Data / Phone outlet
- Motion Detector lighting control

SPECIAL CHARACTERISTICS:

- N/A

ART - PERFORMANCE AND DESIGN DEPARTMENT

SPACE NAME: VISUAL ARTS – DARKROOM

USE OF SPACE - PURPOSE/ACTIVITIES:

A. Storage of art supplies.

OCCUPANTS:

- Staff N/A
- Students N/A

SIZE AND LOCATION:

- Size 400 sq ft
- Location Adjacent to Design Labs

FURNISHINGS AND EQUIPMENT:

- **In-Contract** Casework for (22) Enlarging Stations
Center Drying Table
Large deep double sink with gooseneck faucet
- **By Owner** Enlarging Equipment
- **Finishes** Floor: VCT
Base: Vinyl
Walls: CMU - painted
Ceiling: Suspended acoustic tile 9'-0" A.F.F.
Door: 36" X 84"
- **Electric outlets** (1) duplex outlet per wall / (22) outlets for enlarging equipment
- **Ceiling speaker** Public Address System
- **Telecommunications** Data / Phone outlet
- **Motion Detector** lighting control

SPECIAL CHARACTERISTICS:

- No Windows
- Dark Room Lighting

ART - PERFORMANCE AND DESIGN DEPARTMENT

SPACE NAME: VISUAL ARTS – KILN ROOM

USE OF SPACE - PURPOSE/ACTIVITIES:

- A. Room to hold Kiln and Fire Pottery.

OCCUPANTS:

- Staff 1
- Students N/A

SIZE AND LOCATION:

- Size 200 sq ft
- Location Adjacent Design Lab – Door within Design Lab.

FURNISHINGS AND EQUIPMENT:

- **In-Contract** Art Kiln
Provide Space and Rough-in for second Kiln
- **By Owner** N/A
- **Finishes** Floor: VCT
Base: Vinyl
Walls: CMU - painted
Ceiling: Suspended acoustic tile 9'-0" A.F.F.
Door: 36" X 84" w/ lock
- **Electric outlets** (1) duplex outlet per wall
Power required for Kiln
- **Ceiling speaker** Public Address System
- **Telecommunications** Data / Phone outlet
- **Motion Detector** lighting control

SPECIAL CHARACTERISTICS:

- Fire-rated to meet code.

ART - PERFORMANCE AND DESIGN DEPARTMENT

SPACE NAME: AUDITORIUM / PERFORMANCE - MAIN AUDITORIUM / STAGE

USE OF SPACE - PURPOSE/ACTIVITIES:

A. Theatrical space for use in conducting drama and music presentations, assemblies, and other student and community gatherings and presentations. ADA Accessible.

OCCUPANTS:

- Staff N/A
- Students 750

SIZE AND LOCATION:

- Size 6,000 sq ft
- Location Near main student circulation area and public entry. Part of auditorium complex, with convenient access to exterior for movement of equipment.

FURNISHINGS AND EQUIPMENT:

- **In-Contract** 750 Fixed Seats – Folding cloth seating
Electric Retractable Projection Screen and Projector
Theatrical Premium Sound System (See Stage and Support Area)
- **By Owner**
- **Finishes** Floor: Sloped, Carpet at walkways, VCT at seats
Base: Vinyl
Ceiling: Designed acoustically for music presentations
- **Electric outlets** Ample quantity and general purpose for cleaning equipment / Center area in seating with electric outlets and sound system jacks
- **Telecommunications** Data / Phone outlet – (4) Wireless Access Points
- **Ceiling speakers for building P.A. systems (10 min.)**
- **Ceiling speakers for theatrical sound system**
- **Intercommunications System (separate from school-wide intercommunications)**
- **“Dead hung” electric battens in ceiling for overhead stage lighting**
- **Catwalk for overhead lighting, concealed from audience view**
- **Sound line all ductwork**
- **Communications link between control room, stage and dressing rooms**

SPECIAL CHARACTERISTICS:

- **H.C. Accessible viewing areas dispersed throughout seating area**
- **Seating Area (Note: sloped aisle access shall comply with ADA requirements)**
- **H.C. Accessible ramp for accessibility to stage platform**
- **Acoustically Designed for Music Performances**

ART - PERFORMANCE AND DESIGN DEPARTMENT

SPACE NAME: AUDITORIUM / PERFORMANCE - AUDITORIUM LOBBY

USE OF SPACE - PURPOSE/ACTIVITIES:

- A. The lobby acts as a common gathering point and should reflect the identity of George Mason High School.
- B. Specific Activities:
 - Waiting / Gathering Area

OCCUPANTS:

- **Staff** n/a
- **Students** N/A

SIZE AND LOCATION:

- **Size** 1000 sq ft
- **Location** Entrance to building from Exterior.

FURNISHINGS AND EQUIPMENT:

- **In-Contract** Benches
School Name and Graphic
Built-in Display Cases (Total 24 LF)
- **By Owner** _____

- **Finishes** Floor: Epoxy Terrazzo
Base: Terrazzo
Walls: CMU - painted
Ceiling: Suspended acoustic tile 10'0" A.F.F.
Door: Storefront System
- **Electric outlets** (4) Maintenance Outlets / (2) TV Outlets
- **Intercom** Main visitor entrance to Auditorium and Main Office
- **Buzzer/elec. release** Main visitor entrance to Auditorium from Main Office
- **Key pad for security**
- **Ceiling Speakers** Public Address System
- **Ceiling Speakers** Auditorium Sound System / Control Room
- **Telecommunications** (2) Data Outlet at Wall mounted TV
- **Motion Detector** lighting control

SPECIAL CHARACTERISTICS:

- Provide electronic door release for Lobby Entrance Doors from Main Office. Egress doors from Lobby should be lockable to provide emergency egress only.

ART - PERFORMANCE AND DESIGN DEPARTMENT

SPACE NAME: AUDITORIUM / PERFORMANCE – STAGE AND SUPPORT AREAS

USE OF SPACE - PURPOSE/ACTIVITIES:

- A. Theatrical space for drama, music, and other school and community presentations. ADA Accessible.
- B. Stage shall be equally deep as wide – 50' x 50'

OCCUPANTS:

- Staff 2
- Students 50

SIZE AND LOCATION:

- Size 4,000 sq ft
- Location Part of auditorium complex, with convenient access to exterior for movement of equipment.

FURNISHINGS AND EQUIPMENT:

- **In-Contract**
 - Stage Lighting – (100) light circuits with dimmer on each circuit, light bars on stage and in front, light trees on each side of stage, (120) lights with (2) spot light positions.
 - Lighting Control Panel located in Control Room
 - Catwalk for rigging and lighting
 - Work lights
 - Stage Rigging – Double Purchase Fly System
 - Stage Curtains Include:
 - Grand Curtain
 - Middle Curtain
 - Back Curtain
 - Cyclorama
 - (4) Leg Curtains
 - (4) Teaser Curtains
 - Stage Sound – (48) Channel Sound System, System “base” speakers mounted with ability for additional mobile speakers, both microphone jacks and wireless.
 - Include separate “one click” sound system with plug in microphone. Simple operation plug in microphone, turn on, adjust volume, & speak.
 - Sound System Control Panel located in Control Room
 - Small Secure Storage Room or wire cage
- **By Owner**
- **Finishes**
 - Floor: Wood – Painted Flat Black
 - Base: Wood – Painted Flat Black
 - Walls: CMU, painted
 - Ceiling: Exposed, painted (20' High)
- **Electric outlets** (24) Electrical Outlets
- **Telecommunications** Data / Phone Outlet
- **Sound line all ductwork**
- **Communications link between control room, stage and dressing rooms**

SPECIAL CHARACTERISTICS:

- H.C. Accessible ramp for accessibility to stage platform
- Special consideration to sound isolation and acoustics
- Exterior Garage Door with Access to Loading Dock

ART - PERFORMANCE AND DESIGN DEPARTMENT

SPACE NAME: AUDITORIUM / PERFORMANCE – CONTROL ROOM

USE OF SPACE - PURPOSE/ACTIVITIES:

- A. Visual view of stage
- B. Control Sound and lighting during performances

OCCUPANTS:

- Staff 1
- Students 3

SIZE AND LOCATION:

- Size 200 sq ft
- Location Back of Auditorium raised above seats

FURNISHINGS AND EQUIPMENT:

- **In-Contract** 10 ft. work counter/cabinet
Teacher wardrobe 48”w x 72”h x 24”d with lock
Lighting Control Board
Sound System Control Board
Provide large operable sliding window
- **By Owner** Chairs (4)
- **Finishes** Floor: VCT
Base: Vinyl
Walls: CMU - painted/acoustical panels
Ceiling: Suspended acoustic tile 9'-0" A.F.F.
Door: 36" X 84"
- **Electric outlets** (4) Double duplex at counter location / Minimum (2) duplex outlets per wall
Power for Sound and Lighting boards
- **Telecommunications** Data / Phone outlet, wireless access point
- **Ceiling speakers** Public Address System with Call Back
- **Lock on Door** Keycard access
- **Motion Detector** lighting control

SPECIAL CHARACTERISTICS:

- Special consideration to sound isolation and acoustics
- Communications link between control room, stage and dressing rooms

ART - PERFORMANCE AND DESIGN DEPARTMENT

SPACE NAME: AUDITORIUM / PERFORMANCE – BROADCAST ROOM

USE OF SPACE - PURPOSE/ACTIVITIES:

A.

OCCUPANTS:

- Staff 1
- Students

SIZE AND LOCATION:

- Size 300 sq ft
- Location In Theater Complex

FURNISHINGS AND EQUIPMENT:

- **In-Contract** Broadcast Cameras (In Auditorium)
Broadcast Control Equipment
- **By Owner**
- **Finishes** Floor: VCT
Base: Vinyl
Walls: CMU - painted/acoustical panels
Ceiling: Suspended acoustic tile 12'-6" A.F.F.
Door: (2) 36" X 84" with 8" x 30" vision glass
- **Electric outlets** Double duplex at desk location / Minimum (2) duplex outlets per wall
- **Telecommunications** Data / Phone outlet, wireless access point, Apple TV
Link to Control Room – Sound System
- **Ceiling speakers** Public Address System with Call Back
- **Motion Detector** lighting control

SPECIAL CHARACTERISTICS:

- **Special consideration to sound isolation and acoustics**
- **Coordinate with Falls Church Public Television**

ART - PERFORMANCE AND DESIGN DEPARTMENT

SPACE NAME: AUDITORIUM / PERFORMANCE – TICKET BOOTH

USE OF SPACE - PURPOSE/ACTIVITIES:

A. Selling tickets for Performances

OCCUPANTS:

- **Staff** 1
- **Students** 1-2

SIZE AND LOCATION:

- **Size** 50 sq ft
- **Location** Adjacent to Entry doors in Auditorium Lobby with space for cuing

FURNISHINGS AND EQUIPMENT:

- **In-Contract** Countertop
Glass window with talk-through or roll-down grille
- **By Owner** Chairs (2)
- **Finishes** Floor: VCT
Base: Vinyl
Walls: CMU - painted
Ceiling: Suspended acoustic tile 9'-0" A.F.F.
Door: 36" X 84" with 8" x 30" vision glass
- **Electric outlets** Double duplex at counter location / Minimum (1) duplex outlets per wall
- **Telecommunications** Data / Phone outlet
- **Ceiling speakers** Public Address System
- **Motion Detector** lighting control

SPECIAL CHARACTERISTICS:

- **N/A**

ART - PERFORMANCE AND DESIGN DEPARTMENT

SPACE NAME: AUDITORIUM / PERFORMANCE – CONCESSIONS / SCHOOL STORE

USE OF SPACE - PURPOSE/ACTIVITIES:

- A. Specific Activities
- Sale of school supplies and school spirit goods.
 - Sale of Concessions during performance intermissions

OCCUPANTS:

- **Staff** 1
- **Students** 4

SIZE AND LOCATION:

- **Size** 300 sq ft
- **Location** Adjacent to Auditorium Lobby

FURNISHINGS AND EQUIPMENT:

- **In-Contract** 36 L.F. adjustable metal shelving 12" deep by 84" high
Storage cabinet 48"w x 72"h x 24"d with lock
Display Counter with roll-down gate
Counter with deep sink
Icemaker
Refrigerator
- **By Owner** Stools (4)
- **Finishes** Floor: VCT
Base: Vinyl
Walls: CMU - painted
Ceiling: Suspended acoustic tile 9'-6" A.F.F.
Door: 36" X 84"
- **Electric outlets** Double duplex at counter location / Minimum (2) duplex outlets per wall
- **Telecommunications** Data / Phone outlet
- **Ceiling speakers** Public Address System
- **Motion Detector** lighting control

SPECIAL CHARACTERISTICS:

- N/A

ART - PERFORMANCE AND DESIGN DEPARTMENT

SPACE NAME: AUDITORIUM / PERFORMANCE – DRESSING ROOM / TOILET

USE OF SPACE - PURPOSE/ACTIVITIES:

- A. For Student use
- B. Specific Activities:
 - Rest room facility
 - Changing clothing during performances
 - Applying make-up
 - H/C accessible

OCCUPANTS:

- **Staff** 1
- **Students** 24

SIZE AND LOCATION:

- **Size** 300 sq ft
- **Location** Located backstage

FURNISHINGS AND EQUIPMENT:

- **In-Contract** Toilet accessories
Toilet partitions
Countertops (vanity) with mirrors for 8 students (each side of room)
Lighting at mirrors
Space for Costume Rack
- **By Owner** Soap Dispensers
Stools (24)
- **Finishes** Floor: ceramic tile at toilets, VCT in dressing area
Base: ceramic tile at toilets, vinyl in dressing area
Walls: ceramic tile wainscot at toilets - CMU - painted - epoxy
Ceiling: suspended acoustic tile 9'-0" A.F.F.
Door: 36" X 84"
- **Ceiling speaker** Public Address System
- **Motion Detector** lighting control

SPECIAL CHARACTERISTICS:

- **ADA Accessible**
- **Special consideration to sound isolation**

ART - PERFORMANCE AND DESIGN DEPARTMENT

SPACE NAME: AUDITORIUM / PERFORMANCE – SCENE SHOP AND WORKROOM

USE OF SPACE - PURPOSE/ACTIVITIES:

A. Construction of Sets

OCCUPANTS:

- Staff 1
- Students 24

SIZE AND LOCATION:

- Size 800 sq ft
- Location In Theater Complex

FURNISHINGS AND EQUIPMENT:

- **In-Contract** 120" x 48" tackboard
192" x 48" whiteboard
6 ft. work counter/cabinet with sink/hot and cold water
Teacher wardrobe 48"w x 72"h x 24"d with lock
Floor Slop Sink
- **By Owner** Stool (24)
Teacher desk with chair
- **Finishes** Floor: VCT
Base: Vinyl
Walls: CMU - painted
Ceiling: Suspended acoustic tile 12'-6" A.F.F.
Door: (2) 36" X 84"
- **Electric outlets** Double duplex at desk location / Minimum (4) duplex outlets per wall
Coordinate Electric with Equipment
- **Telecommunications** Data / Phone outlet at teachers desk, wireless access point
- **Clock (Atomic)**
- **Ceiling speakers** Public Address System with Call Back
- **Motion Detector** lighting control

SPECIAL CHARACTERISTICS:

- Special consideration to sound isolation from performance and practice areas

ART - PERFORMANCE AND DESIGN DEPARTMENT

SPACE NAME: AUDITORIUM / PERFORMANCE – COSTUME SHOP & STORAGE

USE OF SPACE - PURPOSE/ACTIVITIES:

A. Construction of Sets

OCCUPANTS:

- Staff 1
- Students 24

SIZE AND LOCATION:

- Size 800 sq ft
- Location In Theater Complex – Adjacent Dressing Rooms

FURNISHINGS AND EQUIPMENT:

- **In-Contract** 120" x 48" tackboard
192" x 48" whiteboard
6 ft. work counter/cabinet with sink/hot and cold water
Teacher wardrobe 48"w x 72"h x 24"d with lock
Built-in Costume Storage / Movable Storage Racks
Residential Washer and Dryer
- **By Owner** Stool (24)
Teacher desk with chair
- **Finishes** Floor: VCT
Base: Vinyl
Walls: CMU - painted
Ceiling: Suspended acoustic tile 12'-6" A.F.F.
Door: (2) 36" X 84"
- **Electric outlets** Double duplex at desk location / Minimum (4) duplex outlets per wall
Coordinate Electric with Equipment
- **Telecommunications** Data / Phone outlet at teachers desk, wireless access point
- **Clock (Atomic)**
- **Ceiling speakers** Public Address System with Call Back
- **Motion Detector** lighting control

SPECIAL CHARACTERISTICS:

- Special consideration to sound isolation from performance and practice areas

ART - PERFORMANCE AND DESIGN DEPARTMENT

SPACE NAME: AUDITORIUM / PERFORMANCE – THEATRE ARTS / DRAMA / BLACKBOX

USE OF SPACE - PURPOSE/ACTIVITIES:

A. Practice Space for Theater Arts – Open Flexible Space

OCCUPANTS:

- Staff 2
- Students 48

SIZE AND LOCATION:

- Size 1800 sq ft
- Location In Theater Complex

FURNISHINGS AND EQUIPMENT:

- **In-Contract** Catwalk around perimeter – Railing mounted lights
Built-in Costume Storage Casework under Catwalk – flat black
(32) Curcuit lighting control – 8 circuits per side on railing light system
(32) LED Stage Lights
(12) Channel Sound System – Stand mounted speakers
- **By Owner** Chairs (48) - folding
Teacher desk with chair
- **Finishes** Floor: VCT – flat black
Base: Vinyl – flat black
Walls: CMU – painted flat black
Ceiling: Suspended acoustic tile 16'-0" A.F.F. – flat black
Door: (2) 36" X 84"
- **Electric outlets** Double duplex at desk location / Minimum (4) duplex outlets per wall
- **Telecommunications** Data / Phone outlet at teachers desk, wireless access point
- **Access points for Sound System**
- **Clock (Atomic)**
- **Ceiling speakers** Public Address System with Call Back
- **Motion Detector** lighting control

SPECIAL CHARACTERISTICS:

- **Special consideration to sound isolation and acoustics – Sound Panels**
- **No Exterior Windows**
- **Window and visual control from Teacher Team Room (Performing Arts)**

ART - PERFORMANCE AND DESIGN DEPARTMENT

SPACE NAME: AUDITORIUM / PERFORMANCE – ORCHESTRA PIT - **DELETED**

USE OF SPACE - PURPOSE/ACTIVITIES:

A. Orchestra Performance in Auditorium – Add SF to Auditorium Space

OCCUPANTS:

- **Staff** 1
- **Students** 75

SIZE AND LOCATION:

- **Size** 0 sq ft
- **Location** In front of Stage in Auditorium – Depressed Space below level of Stage

FURNISHINGS AND EQUIPMENT:

- **In-Contract** Hydraulic Pit – Level with Stage – include trap door
- **By Owner** Chairs (75)
Music Stands (75)
Piano
- **Finishes** Floor: VCT
Base: Vinyl
Walls: CMU - painted
Ceiling: Auditorium Ceiling.
- **Electric outlets** Minimum (2) duplex outlets per wall
- **Telecommunications** Data outlet

SPECIAL CHARACTERISTICS:

- **ADA Accessible**

ART - PERFORMANCE AND DESIGN DEPARTMENT

SPACE NAME: AUDITORIUM / PERFORMANCE – PUBLIC TOILETS

USE OF SPACE - PURPOSE/ACTIVITIES:

- A. For Public use
- B. Specific Activities:
 - Rest room facility
 - H/C accessible

OCCUPANTS:

- **Staff** N/A
- **Students** 12

SIZE AND LOCATION:

- **Size** 700 sq ft
- **Location** Located by auditorium lobby

FURNISHINGS AND EQUIPMENT:

- **In-Contract** Toilet accessories
Toilet partitions
- **By Owner** Soap Dispensers
- **Finishes** Floor: ceramic tile
Base: ceramic tile
Walls: ceramic tile
Ceiling: suspended acoustic tile 9'-0" A.F.F.
Door: 36" X 84"
- **Ceiling speaker** Public Address System
- **Motion Detector** lighting control

SPECIAL CHARACTERISTICS:

- **ADA Accessible**

ART - PERFORMANCE AND DESIGN DEPARTMENT

SPACE NAME: PERFORMING ARTS – BAND / ORCHESTRA

USE OF SPACE - PURPOSE/ACTIVITIES:

A. Instrument teaching, band rehearsal, orchestra rehearsal, small meetings and recitals

OCCUPANTS:

- Staff 1
- Students 90

SIZE AND LOCATION:

- Size 1600 sq ft
- Location Clustered in the performing arts area. Music area shall include band room, choral, strings, music classroom, and support space. Access near Stage.

FURNISHINGS AND EQUIPMENT:

- **In-Contract** 120" x 48" tackboard
120" x 48" whiteboard
64" Interactive whiteboard (smart technology w/ projector)
12 ft. work counter/cabinet with sink/hot and cold water
Large Deep Double Sink with Gooseneck Faucet
Teacher wardrobe 48"w x 72"h x 24"d with lock
Built-in Display Case (12 LF)
Portable Sound System – recording capabilities
- **By Owner** 90 chairs and music stands
Piano with bench
- **Finishes** Floor: carpet
Base: vinyl
Walls: CMU painted /tectum acoustical panels
Ceiling: suspended acoustic tile 12'-6" A.F.F.
Door: 36" X 84" with 8" x 30" vision glass
- **Electric outlets** Double duplex at desk location / Minimum (4) duplex outlets per wall
- **Telecommunications** Data / Phone outlet at teachers desk, wireless access point, interactive white board & projector provisions / Apple TV
- **Access points for Portable Sound System**
- **Clock (Atomic)**
- **Ceiling speakers** Public Address System with Call Back
- **Motion Detector** lighting control

SPECIAL CHARACTERISTICS:

- Special consideration to sound isolation and acoustics
- Provide closet for chair and riser storage
- Window and visual control from Performing Arts Teacher Team Room

ART - PERFORMANCE AND DESIGN DEPARTMENT

SPACE NAME: PERFORMING ARTS – CHORAL / STRINGS PROGRAM

USE OF SPACE - PURPOSE/ACTIVITIES:

A. Music Teaching Space

OCCUPANTS:

- Staff 1
- Students 50

SIZE AND LOCATION:

- Size 1000 sq ft
- Location

FURNISHINGS AND EQUIPMENT:

- **In-Contract** 120" x 48" tackboard
192" x 48" whiteboard
64" Interactive whiteboard (smart technology w/ projector)
6 ft. work counter/cabinet
Teacher wardrobe 48"w x 72"h x 24"d with lock\
Portable Sound System
Portable Choir Risers (Total 200 students)
- **By Owner** Chairs (50)
Music Stands (50)
Piano with Bench
Teacher desk with chair
- **Finishes** Floor: Carpet
Base: Vinyl
Walls: CMU - painted/acoustical panels
Ceiling: Suspended acoustic tile 12'-6" A.F.F.
Door: (2) 36" X 84" with 8" x 30" vision glass
- **Electric outlets** Double duplex at desk location / Minimum (2) duplex outlets per wall
- **Telecommunications** Data / Phone outlet at teachers desk, wireless access point, interactive white board & projector provisions / Apple TV
- **Access points for Portable Sound System**
- **Clock (Atomic)**
- **Ceiling speakers** Public Address System with Call Back
- **Motion Detector** lighting control

SPECIAL CHARACTERISTICS:

- **Special consideration to sound isolation and acoustics**
- **Provide closet for chair and riser storage**

ART - PERFORMANCE AND DESIGN DEPARTMENT

SPACE NAME: PERFORMING ARTS – INSTRUMENT STORAGE - PERCUSSION

USE OF SPACE - PURPOSE/ACTIVITIES:

A. Storage of percussion owned instruments. Emergency repair and wash facilities.

OCCUPANTS:

- Staff 1
- Students Varies

SIZE AND LOCATION:

- Size 400 sq ft
- Location Adjacent Band / Orchestra Room – Door within Band Room.

FURNISHINGS AND EQUIPMENT:

- **In-Contract** 6 ft. work counter/cabinet
Deep open casework shelving on two walls
Shallow open casework shelving one wall
Coordinate shelf size and spacing with specific instruments
- **By Owner** Instruments
- **Finishes** Floor: VCT
Base: vinyl
Walls: CMU painted
Ceiling: suspended acoustic tile 9'-6" A.F.F.
Door: (1) 72" X 84" – Removable center mullion
- **Electric outlets** Double duplex at counter location / Minimum (2) duplex outlets per wall
- **Telecommunications** Data / Phone outlet at counter,
- **Ceiling speakers** Public Address System
- **Motion Detector** lighting control

SPECIAL CHARACTERISTICS:

- N/A

ART - PERFORMANCE AND DESIGN DEPARTMENT

SPACE NAME: PERFORMING ARTS – INSTRUMENT STORAGE – STRINGS

USE OF SPACE - PURPOSE/ACTIVITIES:

A. Storage of string instruments.

OCCUPANTS:

- Staff 1
- Students Varies

SIZE AND LOCATION:

- Size 200 sq ft
- Location Adjacent Choir/ Strings Room – Door within Choir Room.

FURNISHINGS AND EQUIPMENT:

- **In-Contract** 6 ft. work counter/cabinet
Open Casework shelving on two walls
Coordinate shelf size and spacing with specific instruments
- **By Owner** Instruments
- **Finishes** Floor: VCT
Base: vinyl
Walls: CMU painted
Ceiling: suspended acoustic tile 9'-6" A.F.F.
Door: (1) 72" X 84" – Removable center mullion
- **Electric outlets** Double duplex at counter location / Minimum (2) duplex outlets per wall
- **Telecommunications** Data / Phone outlet at counter,
- **Ceiling speakers** Public Address System
- **Motion Detector** lighting control

SPECIAL CHARACTERISTICS:

- N/A

ART - PERFORMANCE AND DESIGN DEPARTMENT

SPACE NAME: PERFORMING ARTS – INSTRUMENT STORAGE - BAND

USE OF SPACE - PURPOSE/ACTIVITIES:

A. Storage of band instruments. Emergency repair and wash facilities.

OCCUPANTS:

- Staff 1
- Students Varies

SIZE AND LOCATION:

- Size 200 sq ft
- Location Adjacent Band / Orchestra Room – Door within Band Room.

FURNISHINGS AND EQUIPMENT:

- **In-Contract** 6 ft. work counter/cabinet with sink/hot and cold water
Open casework shelving on two walls – select lockable units
Coordinate shelving size and spacing with specific instruments
Configure with one door in, one door out, pass through circulation
- **By Owner** Instruments
- **Finishes** Floor: VCT
Base: vinyl
Walls: CMU painted
Ceiling: suspended acoustic tile 9'-6" A.F.F.
Door: (2) 36" X 84"
- **Electric outlets** Double duplex at counter location / Minimum (2) duplex outlets per wall
- **Telecommunications** Data / Phone outlet at counter,
- **Ceiling speakers** Public Address System
- **Motion Detector** lighting control

SPECIAL CHARACTERISTICS:

- N/A

ART - PERFORMANCE AND DESIGN DEPARTMENT

SPACE NAME: PERFORMING ARTS – UNIFORM STORAGE

USE OF SPACE - PURPOSE/ACTIVITIES:

A. Uniform Storage

OCCUPANTS:

- Staff N/A
- Students N/A

SIZE AND LOCATION:

- Size 200 sq ft
- Location Adjacent Choir/ Strings Room
Adjacent Band / Orchestra Room

FURNISHINGS AND EQUIPMENT:

- **In-Contract** Rolling Storage Racks – Move out for changing
(100) Band Tux Uniforms
(100) Chorus Robes
(100) Specialty Uniforms
- **By Owner** N/A
- **Finishes** Floor: VCT
Base: Vinyl
Walls: CMU - painted
Ceiling: Suspended acoustic tile 9'-0" A.F.F.
Door: 36" X 84" with 8" x 30" vision glass and lock
- **Electric outlets** (1) duplex outlet per wall
- **Ceiling speaker** Public Address System
- **Telecommunications** Data / Phone outlet
- **Motion Detector** lighting control

SPECIAL CHARACTERISTICS:

- Provide additional ventilation for uniforms

ART - PERFORMANCE AND DESIGN DEPARTMENT

SPACE NAME: PERFORMING ARTS – PRACTICE ROOMS

USE OF SPACE - PURPOSE/ACTIVITIES:

- A. Music / Band Small Breakout & Practice Spaces

OCCUPANTS:

- Staff 1
- Students 1-4

SIZE AND LOCATION:

- Size 100 sq ft
- Location Adjacent Choir/ Strings Room
Adjacent Band / Orchestra Room

FURNISHINGS AND EQUIPMENT:

- In-Contract
- By Owner 4 Chairs
4 Music Stands
- Finishes Floor: VCT
Base: Vinyl
Walls: CMU - painted
Ceiling: Suspended acoustic tile 9'-0" A.F.F.
Door: 36" X 84" with 8" x 30" vision glass and lock
- Electric outlets (1) duplex outlet per wall
- Ceiling speaker Public Address System
- Telecommunications Data / Phone outlet
- Motion Detector lighting control

SPECIAL CHARACTERISTICS:

- Special consideration to sound isolation and acoustics

ART - PERFORMANCE AND DESIGN DEPARTMENT

SPACE NAME: PERFORMING ARTS – SECTIONAL PRACTICE ROOMS

USE OF SPACE - PURPOSE/ACTIVITIES:

A. Music / Band Small Group Breakout & Practice Spaces

OCCUPANTS:

- Staff 1
- Students 5-15

SIZE AND LOCATION:

- Size 600 sq ft
- Location Adjacent Choir/ Strings Room
Adjacent Band / Orchestra Room

FURNISHINGS AND EQUIPMENT:

- **In-Contract** Computer Countertop (24 LF)
- **By Owner** 15 Chairs
15 Music Stands
- **Finishes** Floor: VCT
Base: Vinyl
Walls: CMU - painted
Ceiling: Suspended acoustic tile 9'-0" A.F.F.
Door: 36" X 84" with 8" x 30" vision glass and lock
- **Electric outlets** (1) duplex outlet per wall / (6) Above Counter duplex outlets
- **Ceiling speaker** Public Address System
- **Telecommunications** Data / Phone outlet / wireless access point
- **Motion Detector** lighting control

SPECIAL CHARACTERISTICS:

- **Special consideration to sound isolation and acoustics**

ART - PERFORMANCE AND DESIGN DEPARTMENT

SPACE NAME: PERFORMING ARTS – MUSIC LIBRARY

A. Storage of music supplies.

OCCUPANTS:

- Staff N/A
- Students N/A

SIZE AND LOCATION:

- Size 300 sq ft
- Location Adjacent Performing Arts Teacher Team Room
- In-Contract Base and Wall Cabinets with Countertop (12 L.F)
High Density Storage System
- By Owner N/A
- Finishes Floor: VCT
Base: Vinyl
Walls: CMU - painted
Ceiling: Suspended acoustic tile 9'-0" A.F.F.
Door: 36" X 84"
- Electric outlets (1) duplex outlet per wall
- Ceiling speaker Public Address System
- Telecommunications Data / Phone outlet
- Motion Detector lighting control

SPECIAL CHARACTERISTICS:

- N/A

CROSS DISCIPLINARY INNOVATION DEPARTMENT

SPACE NAME: PROJECT BASED LEARNING LABS

USE OF SPACE - PURPOSE/ACTIVITIES:

- A. Teaching space for Innovation and Project Based Learning
- B. Flexible Space, easy to reconfigure. Equipment and furnishings on wheels where possible.

OCCUPANTS:

- Staff 1
- Students 24

SIZE AND LOCATION:

- Size 1500 sq ft
- Location

FURNISHINGS AND EQUIPMENT: (Items listed below are per space)

- **In-Contract**
 - 192" x 48" total length whiteboard / sliding whiteboard
 - 64" Interactive whiteboard (smart technology w/ projector)
 - Flagholder and Pencil Sharpener Block on wall
 - Base and wall storage cabinets with countertop on two entire walls
 - Teacher wardrobe 48"w x 72"h x 24"d with lock
 - (4) Shop Worktables on wheels
 - Large deep double shop sink with gooseneck faucet
 - Wall mounted material storage
 - Shop Equipment TBD
- **By Owner** (1) Teacher desk, chair, computer workstation
- **Finishes**
 - Floor: VCT
 - Base: Vinyl
 - Walls: CMU - painted
 - Ceiling: suspended acoustic tile 9'-6" A.F.F.
 - Door: 36" X 84" with 8" x 30" vision glass
- **Electric outlets** Double duplex at desk location / Minimum (2) duplex outlets per wall / Projector ceiling outlet / Quad Ceiling Electric Reals over Worktables / Power strips above countertops / Coordinate equipment electrical requirements
- **Telecommunications** Data / Phone outlet at teachers desk and Data outlet at opposite side of room, wireless access point, interactive white board & projector provisions / Apple TV
- **Clock (Atomic)**
- **Ceiling speakers** Public Address System with Call Back
- **Motion Detector** lighting control

SPECIAL CHARACTERISTICS:

- Provide window approximately 240" x 60" per classroom
- Ventilation System for equipment and worktables

CROSS DISCIPLINARY INNOVATION DEPARTMENT

SPACE NAME: EDUCATION RESOURCE CENTER

USE OF SPACE - PURPOSE/ACTIVITIES:

- A.
- B.

OCCUPANTS:

- **Staff** 6-8
- **Students** N/A

SIZE AND LOCATION:

- **Size** 800 sq ft
- **Location**

FURNISHINGS AND EQUIPMENT:

- **In-Contract** 48" x 48" tackboard
48" x 48" whiteboard
- **By Owner**
- **Finishes** Floor: VCT
Base: Vinyl
Walls: CMU - painted
Ceiling: Suspended acoustic tile 9'-0" A.F.F.
Door: 36" X 84" with 24" x 36" vision glass
- **Electric outlets** Minimum (2) duplex per wall
- **Telecommunications** (1) data outlet / wireless access point
- **Ceiling speaker** Public Address System with Call Back
- **Clock (Atomic)**
- **Motion Detector** lighting control
- **Fire alarm mini-audio/visual signaling device**

SPECIAL CHARACTERISTICS:

- N/A

CROSS DISCIPLINARY INNOVATION DEPARTMENT

SPACE NAME: TECHNOLOGY BREAKOUT SPACE

USE OF SPACE - PURPOSE/ACTIVITIES:

A. Small student workgroups open space.

OCCUPANTS:

- **Staff** 1
- **Students** Varies

SIZE AND LOCATION:

- **Size** 200 sq ft
- **Location** Access from both Learning Labs with visual control from Labs

FURNISHINGS AND EQUIPMENT:

- **In-Contract** 64" Interactive whiteboard (smart technology w/ projector)
120" x 48" total length whiteboards / sliding whiteboards
- **By Owner**
- **Finishes** Floor: VCT
Base: Vinyl
Walls: CMU - painted
Ceiling: Suspended acoustic tile 9'-6" A.F.F.
- **Electric outlets** Minimum (2) duplex outlets per wall
- **Telecommunications** Data / Phone outlet, wireless access point, interactive white board & projector provisions / Apple TV
- **Ceiling speakers** Public Address System

SPECIAL CHARACTERISTICS:

- **N/A**

CROSS DISCIPLINARY INNOVATION DEPARTMENT

SPACE NAME: STORAGE ROOM

USE OF SPACE - PURPOSE/ACTIVITIES:

- A. Storage of academic supplies.

OCCUPANTS:

- Staff N/A
- Students N/A

SIZE AND LOCATION:

- Size 300 sq ft
- Location Adjacent to and access from both Project Based Learning Labs

FURNISHINGS AND EQUIPMENT:

- In-Contract 32 L.F. adjustable metal shelving units (12" deep by 84" high)
- By Owner N/A
- Finishes Floor: VCT
Base: Vinyl
Walls: CMU - painted
Ceiling: Suspended acoustic tile 9'-0" A.F.F.
Door: 36" X 84"
- Electric outlets Minimum (1) duplex per wall
- Ceiling speaker Public Address System
- Telecommunications Data/Phone outlet
- Motion Detector lighting control

SPECIAL CHARACTERISTICS:

- N/A

CROSS DISCIPLINARY INNOVATION DEPARTMENT

SPACE NAME: STAFF TOILET

USE OF SPACE - PURPOSE/ACTIVITIES:

- A. For Staff use
- B. Specific Activities:
 - Rest room facility
 - H/C accessible

OCCUPANTS:

- **Staff** 1
- **Students** N/A

SIZE AND LOCATION:

- **Size** 60 sq ft each
- **Location**

FURNISHINGS AND EQUIPMENT:

- **In-Contract** Toilet accessories
- **By Owner** N/A
- **Finishes** Floor: ceramic tile
Base: ceramic tile
Walls: ceramic tile wainscot 5'-0" - CMU - painted - epoxy
Ceiling: suspended acoustic tile 8'-0" A.F.F.
Door: 36" X 84" with privacy lock
- **Ceiling speaker** Public Address System
- **Motion Detector** lighting control

SPECIAL CHARACTERISTICS:

- **ADA Accessible**

PHYSICAL EDUCATION

SPACE NAME: COMPETITION GYMNASIUM

USE OF SPACE - PURPOSE/ACTIVITIES:

- A. Large safe play area for various size groups of pupils and adults to move about freely in numerous activities. Instruction for the regular physical education program and the high school athletic program. Competition Court sized for regulation basketball (Minimum 94' long) with 15' clear at ends of main court.
- B. Host high school athletics

OCCUPANTS:

- **Staff** 4
- **Students** 1800

SIZE AND LOCATION:

- **Size** 20,000 sq ft
- **Location** Located with direct access to play fields and access to Gym Lobby for after school use. Public Toilet facilities to be opened and used by the community for recreational purposes when the rest of the school is closed.

FURNISHINGS AND EQUIPMENT:

- **In-Contract** (6) basketball backstops, motorized folding type, glass backboards
Three pairs (6) combination standards
Bleachers Seating 1800
Wireless Controlled four sided center hung Scoreboard
Wall Pads as required
- **By Owner** Loose and movable P.E. equipment
- **Finishes** Floor: Fixed Floating Wood Floor with game lines
Base: metal
Walls: CMU - painted (epoxy)
Ceiling: Exposed acoustical metal deck painted (40' clear over competition court)
Door: 36" X 84" with 8" x 30" vision glass (Size for Egress)
- **Electric outlets** Minimum (24) duplex outlets
- **Clock (Atomic)** with wire guard
- **Telecommunications** (6) Data outlets / (4) wireless access points
Flush access in floor center for score board controls and sound system connection, Central Control Board lighting and backboards
- **Ceiling Speaker for Public Address System (8 min.) with Call Back; 8 speakers for Gym Sound System back to Broadcast Room**
- **Local P.A. system wall jacks**
- **Electronic Door Holders**

SPECIAL CHARACTERISTICS:

- **The mechanical system will be designed to provide heating/cooling during non-school periods.**

PHYSICAL EDUCATION

SPACE NAME: GYM LOBBY

USE OF SPACE - PURPOSE/ACTIVITIES:

- A. The lobby acts as a common gathering point and should reflect the identity of George Mason High School.
- B. Specific Activities:
 - Waiting / Gathering Area
 - Access to Concessions

OCCUPANTS:

- **Staff** N/A
- **Students** N/A

SIZE AND LOCATION:

- **Size** 1000 sq ft
- **Location** Entrance to building from Exterior
Adjacent to Main Gymnasium
Can be co-located with other common areas

FURNISHINGS AND EQUIPMENT:

- **In-Contract** Benches
School Name and Graphic
Recessed Trophy Display Cases - total 120' x 6' – lobby and corridor
- **By Owner** _____

- **Finishes** Floor: Epoxy Terrazzo
Base: Terrazzo
Walls: CMU - painted
Ceiling: Suspended acoustic tile 10'0" A.F.F.
Door: Storefront System
- **Electric outlets** Maintenance Outlets (4) / (2) TV Outlets
- **Intercom** Lobby entrance to Main Office
- **Buzzer/elec. release** Main Office
- **Key pad for security**
- **Ceiling Speakers** Public Address System
- **Telecommunications** (2) Data Outlets at Wall mounted TVs
- **Motion Detector** lighting control

SPECIAL CHARACTERISTICS:

- Provide electronic door release for Lobby Entrance Doors from Main Office.

PHYSICAL EDUCATION

SPACE NAME: COMMUNITY GYMNASIUM

USE OF SPACE - PURPOSE/ACTIVITIES:

- A. Large safe play area for various size groups of pupils and adults to move about freely in numerous activities. Instruction for the regular physical education program and the high school athletic program.
- B. 2 Regulation Basketball Courts

OCCUPANTS:

- **Staff** 2
- **Students** 800

SIZE AND LOCATION:

- **Size** 12000 sq ft
- **Location** In Physical Education Department – locate for community after hours use.

FURNISHINGS AND EQUIPMENT:

- **In-Contract** 8 basketball backstops, motorized folding type, adjustable height, glass backboards
6 combination standards
Bleacher Seating for 400
Suspended walking track with Athletic Flooring
Wireless Controlled Scoreboards
Ceiling suspended batting cage
Wall Pads as required
Multiple Curtain Dividers
- **By Owner** Loose and movable P.E. equipment
- **Finishes** Floor: Fluid Applied Athletic Flooring with game lines
Base: Rubber
Walls: CMU - painted (epoxy)
Ceiling: Exposed acoustical metal deck painted (26' clear)
Door: 36" X 84" with 8" x 30" vision glass (Size for Egress)
- **Electric outlets** Minimum (20) duplex outlets
- **Clock (Atomic)** with wire guard
- **Telecommunications** (2) Data outlets / (2) wireless access points, Central Control Panel for lighting, backstops, and curtains.
- **Ceiling Speaker** Public Address System (6 min.) with Call Back; 4 speakers in corners
- **P.A. system wall jacks and speakers, Sound System**
- **Electronic Door Holders**

SPECIAL CHARACTERISTICS:

- **The mechanical system will be designed to provide heating/cooling during non-school periods.**

PHYSICAL EDUCATION

SPACE NAME: WRESTLING ROOM

USE OF SPACE - PURPOSE/ACTIVITIES:

- A. Large safe play area for various size groups of pupils and adults to move about freely in numerous activities. Instruction for the regular physical education program and the high school athletic program.

OCCUPANTS:

- **Staff** 4
- **Students** 40

SIZE AND LOCATION:

- **Size** 3,000 sq ft
- **Location** In Physical Education Department

FURNISHINGS AND EQUIPMENT:

- **In-Contract** Batting Cage
- **By Owner** Loose and movable P.E. equipment
Portable PA system
Wrestling Mats & Stands
Mat Storage System
- **Finishes** Floor: Rubber Tile
Base: Rubber
Walls: CMU - painted (epoxy)
Ceiling: Suspended Acoustical Tile 12'-0" AFF
Door: 36" X 84" with 8" x 30" vision glass (Size for Egress)
- **Electric outlets** Minimum (12) duplex outlets
- **Clock (Atomic)** with wire guard
- **Telecommunications** (2) Data outlets / wireless access point
- **Ceiling Speaker for Public Address System (6 min.) with Call Back; 4 speakers in corners**
- **Portable P.A. system wall jacks and speakers**
- **Electronic Door Holders**

SPECIAL CHARACTERISTICS:

- N/A

PHYSICAL EDUCATION

SPACE NAME: FITNESS CENTER

USE OF SPACE - PURPOSE/ACTIVITIES:

A. Fitness Center.

OCCUPANTS:

- **Staff** 2
- **Students** 50

SIZE AND LOCATION:

- **Size** 4,000 sq ft
- **Location** In Physical Education Department.

FURNISHINGS AND EQUIPMENT:

- **In-Contract** 96" x 48" whiteboard
96" x 48" tackboard
Mirrored Wall Surface
(8) Combination Lifting Platforms / Racks
(10) Cardio / Fitness Machines
(4) Pulley / Cable Systems
(10) Plate loaded machines
Weight Storage
- **By Owner** Loose and movable P.E. equipment
Portable PA system
- **Finishes** Floor: Rubber Tile
Base: Rubber
Walls: CMU - painted (epoxy)
Ceiling: Suspended Acoustical Tile 12'-0" AFF
Door: 36" X 84" with 8" x 30" vision glass (Size for Egress)
- **Electric outlets** Minimum (20) duplex outlets (Coordinate with Equipment)
- **Clock (Atomic)** with wire guard
- **Telecommunications** (2) Data outlets / wireless access point
- **Ceiling Speaker** Public Address System (6 min.) with Call Back; 4 speakers in corners
- **Portable P.A. system wall jacks and speakers**
- **Electronic Door Holders**

SPECIAL CHARACTERISTICS:

- N/A

SPACE NAME: CONCESSIONS

USE OF SPACE - PURPOSE/ACTIVITIES:

- A. Specific Activities
- Sale of Concessions during sporting events

OCCUPANTS:

- **Staff** 1
- **Students** 4

SIZE AND LOCATION:

- **Size** 300 sq ft
- **Location** Adjacent to Auditorium Lobby

FURNISHINGS AND EQUIPMENT:

- **In-Contract** 18 L.F. adjustable metal shelving 12" deep by 84" high
(2) Storage cabinet 48"w x 72"h x 24"d with lock
Display Counter with roll-down gate
Counter with Sink
Icemaker
Refrigerator
- **By Owner** Stools (4)
- **Finishes** Floor: VCT
Base: Vinyl
Walls: CMU - painted
Ceiling: Suspended acoustic tile 9'-0" A.F.F.
Door: 36" X 84"
- **Electric outlets** Double duplex at counter location / Minimum (2) duplex outlets per wall
- **Telecommunications** Data / Phone outlet
- **Ceiling speakers** Public Address System
- **Motion Detector** lighting control

SPECIAL CHARACTERISTICS:

- N/A

SPACE NAME: **TICKET BOOTH**

USE OF SPACE - PURPOSE/ACTIVITIES:

A. Selling tickets for Events

OCCUPANTS:

- **Staff** 1
- **Students** 2-3

SIZE AND LOCATION:

- **Size** 150 sq ft
- **Location** Adjacent to Entry doors in Gym Lobby with space for cuing

FURNISHINGS AND EQUIPMENT:

- **In-Contract** Countertop
Glass window with talk-through (2) or roll-down grille
- **By Owner** Chairs (2)
- **Finishes** Floor: VCT
Base: Vinyl
Walls: CMU - painted/acoustical panels
Ceiling: Suspended acoustic tile 9'-0" A.F.F.
Door: 36" X 84" with 8" x 30" vision glass
- **Electric outlets** Double duplex at counter location / Minimum (1) duplex outlets per wall
- **Telecommunications** Data / Phone outlet
- **Ceiling speakers** Public Address System with Call Back
- **Motion Detector** lighting control

SPECIAL CHARACTERISTICS:

- N/A

SPACE NAME: BROADCAST A/V ROOM

USE OF SPACE - PURPOSE/ACTIVITIES:

A. Broadcast of Sporting Events in Gymnasium.

OCCUPANTS:

- **Staff** 1
- **Students**

SIZE AND LOCATION:

- **Size** 300 sq ft
- **Location** In Gymnasium Complex

FURNISHINGS AND EQUIPMENT:

- **In-Contract** Broadcast Equipment
- **By Owner**
- **Finishes** Floor: VCT
Base: Vinyl
Walls: CMU - painted/acoustical panels
Ceiling: Suspended acoustic tile 12'-6" A.F.F.
Door: (2) 36" X 80" with 8" x 30" vision glass
- **Electric outlets** Double duplex at desk location / Minimum (2) duplex outlets per wall / Broadcast Equipment
-
- **Telecommunications** Data / Phone outlet
- **Clock (Atomic)**
- **Ceiling speakers** Public Address System
- **Motion Detector** lighting control

SPECIAL CHARACTERISTICS:

- **Special consideration to sound isolation and acoustics**

SPACE NAME: INDOOR STORAGE ROOM

USE OF SPACE - PURPOSE/ACTIVITIES:

- A. Storage of loose P.E. equipment and apparatus.

OCCUPANTS:

- **Staff** N/A
- **Students** N/A

SIZE AND LOCATION:

- **Size** 800 sq ft
- **Location** Adjacent to gymnasium.

FURNISHINGS AND EQUIPMENT:

- **In-Contract** 40 L.F. adjustable metal shelving units (24" deep by 84" high) with shelf lip.
- **By Owner** Loose and movable P.E. equipment
- **Finishes** Floor: VCT
Base: Vinyl
Walls: CMU - painted
Ceiling: Suspended acoustic tile 10'-0" A.F.F.
Door: (2) 36" X 84" (no center mullion)
- **Electric outlets** (1) duplex outlet per wall
- **Ceiling speaker** Public Address System
- **Telecommunications** Data / Phone outlet
- **Motion sensors** light control

SPECIAL CHARACTERISTICS:

- N/A

PHYSICAL EDUCATION

SPACE NAME: BOYS LOCKER ROOM

USE OF SPACE - PURPOSE/ACTIVITIES:

- A. A combination of large and small lockers arranged to minimize circulation conflicts.
- B. Specific Activities:
 - Storing clothes and changing for PE
 - Team Locker Room
 - Separate Area for Toilets
 - Separate Area for Showers

OCCUPANTS:

- **Staff** N/A
- **Students** Varies

SIZE AND LOCATION:

- **Size** 6,000 sq ft aggregate
- **Location** Adjacent to and accessible from Gym and Public Hallways

FURNISHINGS AND EQUIPMENT:

- **In-Contract** 900 12"W x 15"D x 24"H student wardrobe lockers
100 Team Lockers suitable for football equipment
Benches
- **By Owner** N/A
- **Finishes** Floor: Ceramic Tile
Base: Ceramic Tile
Walls: Ceramic Tile wainscot 7'-0" - CMU painted - epoxy
Ceiling: suspended acoustic tile 9'-0" A.F.F.
- **Electric outlets** ample quantity general purpose for cleaning equipment
- **Telecommunications** wireless access point
- **Ceiling speakers** Public Address System

SPECIAL CHARACTERISTICS:

- **Locker area and circulation areas should be designed for maximum ease of supervision by faculty and staff. Provide good visual control.**
- **ADA Accessible**

PHYSICAL EDUCATION

SPACE NAME: **GIRLS LOCKER ROOM**

USE OF SPACE - PURPOSE/ACTIVITIES:

- A. A combination of large and small lockers arranged to minimize circulation conflicts.
- B. Specific Activities:
 - Storing clothes and changing for PE
 - Team Locker Room
 - Separate Area for Toilets
 - Separate Area for Showers

OCCUPANTS:

- **Staff** N/A
- **Students** Varies

SIZE AND LOCATION:

- **Size** 6,000 sq ft aggregate
- **Location** Adjacent to and accessible from Gym and Public Hallways

FURNISHINGS AND EQUIPMENT:

- **In-Contract** 900 12"W x 15"D x 24"H student wardrobe lockers
100 Team Lockers sized for lacrosse sticks
Benches
- **By Owner** N/A
- **Finishes** Floor: Ceramic Tile
Base: Ceramic Tile
Walls: Ceramic Tile wainscot 7'-0" - CMU painted - epoxy
Ceiling: suspended acoustic tile 9'-0" A.F.F.
- **Electric outlets** ample quantity general purpose for cleaning equipment
- **Telecommunications** wireless access point
- **Ceiling speakers** Public Address System

SPECIAL CHARACTERISTICS:

- **Locker area and circulation areas should be designed for maximum ease of supervision by faculty and staff. Provide good visual control.**
- **ADA Accessible**

SPACE NAME: PUBLIC TOILETS

USE OF SPACE - PURPOSE/ACTIVITIES:

- A. For Public use
- B. Specific Activities:
 - Rest room facility
 - H/C accessible

OCCUPANTS:

- **Staff** N/A
- **Students** 12

SIZE AND LOCATION:

- **Size** 700 sq ft
- **Location** Located by gymnasium lobby

FURNISHINGS AND EQUIPMENT:

- **In-Contract** Toilet accessories
Toilet partitions
- **By Owner** Soap Dispensers
- **Finishes** Floor: ceramic tile
Base: ceramic tile
Walls: ceramic tile
Ceiling: suspended acoustic tile 9'-0" A.F.F.
Door: 36" X 84"
- **Ceiling speaker** Public Address System
- **Motion Detector** lighting control

SPECIAL CHARACTERISTICS:

- **ADA Accessible**

SPACE NAME: OUTDOOR STORAGE

USE OF SPACE - PURPOSE/ACTIVITIES:

A. Storage of outdoor physical education equipment

OCCUPANTS:

- **Staff** 1
- **Students** N/A

SIZE AND LOCATION:

- **Size** 250 sq ft
- **Location** Adjacent to gymnasium entry and playing fields.

FURNISHINGS AND EQUIPMENT:

- **In-Contract** 20 L.F. adjustable metal shelving units (24" deep by 84" high)
- **By Owner** Physical Education Equipment
- **Finishes** Floor: concrete
Base: none
Walls: CMU painted - epoxy
Ceiling: exposed structure 10'-0" clear.
Door: (2) 36" X 84" metal with no center mullion.
- **Electric outlets** for general use
- **Ceiling speaker** Public Address System

SPECIAL CHARACTERISTICS:

- N/A

PHYSICAL EDUCATION

SPACE NAME: GYM A.D. OFFICE

USE OF SPACE - PURPOSE/ACTIVITIES:

- A. Open office space for the Athletic Department.
- B. Specific Activities:
 -

OCCUPANTS:

- **Staff** 4
- **Students** N/A

SIZE AND LOCATION:

- **Size** 500 sq ft
- **Location** Adjacent to the Gymnasium. Must have visual control of Gymnasium and Gym Lobby entrance. Door to Lobby and Gymnasium

FURNISHINGS AND EQUIPMENT:

- **In-Contract** 48" x 48" tackboard
48" x 48" whiteboard
6 L.F. base and wall cabinet with sink and under counter refrigerator
(4) Cubical Workstations
- **By Owner** (4) Chairs
Tables
File cabinets
- **Finishes** Floor: VCT
Base: Vinyl
Walls: CMU - painted
Ceiling: Suspended acoustic tile 9'-0" A.F.F.
Doors: 36" X 84" with 24" x 36" vision glass
- **Electric outlets** Double duplex at desk locations / Minimum (2) duplex per wall
- **Telecommunications** Data and Phone Outlet at each workstation / wireless access point
- **Clock (Atomic)**
- **Ceiling Speakers** Public Address System

SPECIAL CHARACTERISTICS:

- N/A

PHYSICAL EDUCATION

SPACE NAME: CONFERENCE ROOM

USE OF SPACE - PURPOSE/ACTIVITIES:

A. Conference room for Physical Education Department.

OCCUPANTS:

- **Staff** 30
- **Students** N/A

SIZE AND LOCATION:

- **Size** 900 sq ft
- **Location** Adjacent to Gym A.D. Office

FURNISHINGS AND EQUIPMENT:

- **In-Contract** 48" x 48" tackboard
120" x 48" white marker board
64" Interactive whiteboard (smart technology w/ projector)
- **By Owner** Table
Chairs
- **Finishes** Floor: VCT
Base: Vinyl
Walls: CMU - painted
Ceiling: Suspended acoustic tile 9'-0" A.F.F.
Door: 36" X 84" with 8"x30" vision glass
- **Electric outlets** Minimum (2) duplex per wall / Projector ceiling outlet
- **Ceiling speaker** Public Address System
- **Telecommunications** Data/Phone outlet / interactive whiteboard & projector provisions / Apple TV
- **Motion Detector** lighting control

SPECIAL CHARACTERISTICS:

- N/A

PHYSICAL EDUCATION

SPACE NAME: FACULTY OFFICE

USE OF SPACE - PURPOSE/ACTIVITIES:

- A. Specific Activities:
- Planning with individuals, and community groups
 - Conferring with teachers, students, and parents

OCCUPANTS:

- **Staff** 1
- **Students** N/A

SIZE AND LOCATION:

- **Size** 150 sq ft
- **Location**

FURNISHINGS AND EQUIPMENT:

- **In-Contract**
- **By Owner** Desk (1)
Chair (1)
- **Finishes** Floor: Carpet
Base: Vinyl
Walls: CMU - painted
Ceiling: suspended acoustic tile 9'-0" A.F.F.
Door: 36" X 84"
- **Electric outlets** Double duplex at desk location / Minimum (1) duplex per wall
- **Telecommunications** Data/Phone outlet at Desk
- **Ceiling speaker** Public Address System
- **Motion Detector** lighting control

SPECIAL CHARACTERISTICS:

- **One Office must be located adjacent the Competition Gym for game officials and contain a shower.**

PHYSICAL EDUCATION

SPACE NAME: COACH'S OFFICE

USE OF SPACE - PURPOSE/ACTIVITIES:

- A. Specific Activities:
- Change clothes and showering.
 - Class preparation and lesson planning.
 - Administer minor first aid.
 - Conferring with teachers, students, and parents

OCCUPANTS:

- **Staff** 5
- **Students** N/A

SIZE AND LOCATION:

- **Size** 1500 sq ft
- **Location** Visual Control over Gymnasium

FURNISHINGS AND EQUIPMENT:

- **In-Contract** 48" x 48" whiteboard
48" x 48" tackboard (2)
6 ft Counter with sink, base and wall cabinets
Toilet and Shower accessories
Desks around perimeter of Room
- **By Owner** Chair (5)
Desks (5)
Filing Cabinets (1)
- **Finishes** Floor: VCT (ceramic in toilet/shower)
Base: Vinyl (ceramic in toilet/shower)
Walls: CMU - painted (epoxy in toilet and ceramic in shower)
Ceiling: Suspended acoustic tile 9'-0" A.F.F.
Door: 36" X 84"
Vision windows (3' x 3' w/ blinds) into main gym (lexan)
- **Electric outlets** Double duplex at desk locations / Minimum (2) duplex per wall
- **Telecommunications** Data/Phone outlet at Desk / wireless access point
- **Ceiling speaker** Public Address System
- **Motion Detector** lighting control

SPECIAL CHARACTERISTICS:

- **Provide toilet and shower for office space**

SPACE NAME: STAFF TOILET / SHOWER ROOM

USE OF SPACE - PURPOSE/ACTIVITIES:

- A. For Staff use
- B. Specific Activities:
 - Rest room and shower facility
 - H/C accessible

OCCUPANTS:

- Staff 1
- Students N/A

SIZE AND LOCATION:

- Size 100 sq ft each
- Location

FURNISHINGS AND EQUIPMENT:

- In-Contract Toilet accessories
- By Owner N/A
- Finishes
 - Floor: ceramic tile
 - Base: ceramic tile
 - Walls: ceramic tile wainscot 5'-0" - CMU - painted – epoxy
 - Walls: ceramic tile full height at shower
 - Ceiling: suspended acoustic tile 8'-0" A.F.F.
 - Door: 36" X 84" with privacy lock
- Ceiling speaker Public Address System
- Motion Detector lighting control

SPECIAL CHARACTERISTICS:

- ADA Accessible

PHYSICAL EDUCATION

SPACE NAME: HEALTH CLASSROOM

USE OF SPACE - PURPOSE/ACTIVITIES:

A. Teaching space for Health.

OCCUPANTS:

- **Staff** 1
- **Students** 24

SIZE AND LOCATION:

- **Size** 800 sq ft
- **Location** In Physical Education Department

FURNISHINGS AND EQUIPMENT: (Items listed below are per space)

- **In-Contract** 120" x 48" total length tackboard
192" x 48" total length whiteboard
64" Interactive whiteboard (smart technology w/ projector)
Flagholder on wall
Base and wall storage cabinets (6 ft.)
Teacher wardrobe 48"w x 72"h x 24"d with lock
36" x 120" bookcase under tackboard
- **By Owner** Desks (24)
Chairs (24)
(1) Teacher desk, chair, computer workstation
- **Finishes** Floor: VCT
Base: Vinyl
Walls: CMU - painted
Ceiling: suspended acoustic tile 9'-6" A.F.F.
Door: 36" X 84" with 8" x 30" vision glass
- **Electric outlets** Double duplex at desk location / Minimum (2) duplex outlets per wall
/ Projector ceiling outlet
- **Telecommunications** Data / Phone outlet at teachers desk and Data outlet at opposite side
of room, wireless access point, interactive white board & projector
provisions / Apple TV
- **Clock (Atomic)**
- **Ceiling speakers** Public Address System with Call Back
- **Motion Detector** lighting control

SPECIAL CHARACTERISTICS:

- **Provide window approximately 120" x 60" per classroom**
Window Blinds

SPACE NAME: LAUNDRY ROOM

USE OF SPACE - PURPOSE/ACTIVITIES:

A. Cleaning Uniforms and towels

OCCUPANTS:

- **Staff** 2
- **Students** N/A

SIZE AND LOCATION:

- **Size** 500 sq ft
- **Location** Adjacent to Training Room

FURNISHINGS AND EQUIPMENT:

- **In-Contract** 48" x 48" tackboard
6'-0" Counter for folding
Utility Sinks (2)
Commercial Washing Machine (2)
Commercial Dryer (2)
- **By Owner**
- **Finishes** Floor: VCT
Base: Vinyl
Walls: CMU - painted
Ceiling: Suspended acoustic tile 9'-0" A.F.F.
Door: 36" X 84
- **Electric outlets** Minimum (1) duplex outlet per wall
Power for Washers and Dryers
- **Telecommunications** (1) Data / Phone
- **Ceiling speakers** Public Address System
- **Motion Detector** lighting control

SPECIAL CHARACTERISTICS:

- N/A

SPACE NAME: TRAINING ROOM

USE OF SPACE - PURPOSE/ACTIVITIES:

A.

OCCUPANTS:

- **Staff** 1
- **Students** 5

SIZE AND LOCATION:

- **Size** 1500 sq ft
- **Location** Must have access to outside in proximity of playing fields. On grade with floors of both Gyms

FURNISHINGS AND EQUIPMENT:

- **In-Contract** 48" x 48" whiteboard
48" x 48" tackboard (2)
(3) Full Depth whirlpool tubs
(4) Training & Treatment Tables
Large Ice Maker / Cooler Filing Station
- **By Owner**
- **Finishes** Floor: VCT
Base: Vinyl
Walls: CMU - painted
Ceiling: Suspended acoustic tile 9'-0" A.F.F.
Door: 36" X 84"
- **Electric outlets** Minimum (2) duplex outlet per wall / Electric for Training Equipment
- **Telecommunications** (1) Data / Phone
- **Ceiling speakers** Public Address System
- **Motion Detector** lighting control

SPECIAL CHARACTERISTICS:

- **Provide plumbing and floor drains to accommodate whirlpool tubs**

PHYSICAL EDUCATION

SPACE NAME: STORAGE / PE

USE OF SPACE - PURPOSE/ACTIVITIES:

- A. Storage of loose P.E. equipment and apparatus.

OCCUPANTS:

- **Staff** N/A
- **Students** N/A

SIZE AND LOCATION:

- **Size** 800 sq ft
- **Location** Adjacent to gymnasium.

FURNISHINGS AND EQUIPMENT:

- **In-Contract** 40 L.F. adjustable metal shelving units (24" deep by 84" high) with shelf lip.
- **By Owner** Loose and movable P.E. equipment
- **Finishes** Floor: VCT
Base: Vinyl
Walls: CMU - painted
Ceiling: Suspended acoustic tile 10'-0" A.F.F.
Door: (2) 36" X 84" (no center mullion)
- **Electric outlets** (1) duplex outlet per wall
- **Ceiling speaker** Public Address System
- **Telecommunications** Data / Phone outlet
- **Motion sensors** light control

SPECIAL CHARACTERISTICS:

- N/A

PHYSICAL EDUCATION

SPACE NAME: STORAGE / ATHLETICS

USE OF SPACE - PURPOSE/ACTIVITIES:

- A. Storage of Athletic equipment and apparatus.

OCCUPANTS:

- Staff N/A
- Students N/A

SIZE AND LOCATION:

- Size 4,500 sq ft
- Location In Physical Education Department – Access to competition gymnasium

FURNISHINGS AND EQUIPMENT:

- **In-Contract** 40 L.F. adjustable metal shelving units (24" deep by 84" high) with shelf lip.
High Density Storage Units
- **By Owner** Loose and movable P.E. equipment
- **Finishes** Floor: VCT
Base: Vinyl
Walls: CMU - painted
Ceiling: Suspended acoustic tile 10'-0" A.F.F.
Door: 36" X 84" / Roll up Doors to exterior and competition gym
- **Electric outlets** (1) duplex outlet per wall
- **Ceiling speaker** Public Address System
- **Telecommunications** Data / Phone outlet
- **Motion sensors** light control

SPECIAL CHARACTERISTICS:

- Access to loading dock

SPECIAL EDUCATION

SPACE NAME: SPECIAL NEEDS CONTENT AREA

USE OF SPACE - PURPOSE/ACTIVITIES:

A. Special education programs and Instructional Support.

OCCUPANTS:

- **Staff** 1
- **Students** Varies 24

SIZE AND LOCATION:

- **Size** 800 sq ft
- **Location**

FURNISHINGS AND EQUIPMENT: (Items listed below are per space)

- **In-Contract**
 - 72" x 48" total length whiteboard
 - 72" x 48" total length tackboard
 - 64" Interactive whiteboard (smart technology w/ projector)
 - Flag holder on wall
 - Base and wall storage cabinets (6 ft.)
 - Teacher wardrobe 48"w x 72"h x 24"d with lock
 - 36" x 120" bookcase under tackboard
- **By Owner**
 - Desks (24)
 - Chairs (24)
 - (1) Teacher desk, chair, computer workstation
- **Finishes**
 - Floor: VCT
 - Base: Vinyl
 - Walls: CMU - painted
 - Ceiling: Suspended acoustic tile 9'-6" A.F.F.
 - Door: (2) 36" X 84" with 8" x 30" vision glass
- **Electric outlets** Double duplex at desk location / Minimum (2) duplex outlets per wall
- **Telecommunications** Data / Phone outlet at teachers desk, wireless access point, interactive white board & projector provisions / Apple TV
- **Clock (Atomic)**
- **Ceiling speakers** Public Address System with Call Back
- **Motion Detector** lighting control

SPECIAL CHARACTERISTICS:

- **Provide window approximately 240" x 60" per classroom**

SPACE NAME: SMALL RESOURCE ROOM

USE OF SPACE - PURPOSE/ACTIVITIES:

A. Student support.

OCCUPANTS:

- **Staff** 1
- **Students** Varies 1-4

SIZE AND LOCATION:

- **Size** 500 sq ft
- **Location**

FURNISHINGS AND EQUIPMENT: (Items listed below are per space)

- **In-Contract** 72" x 48" total length whiteboard
72" x 48" total length tackboard
64" Interactive whiteboard (smart technology w/ projector)
Flag holder on wall
Teacher wardrobe 48"w x 72"h x 24"d with lock
- **By Owner** Desks (1-4)
Chairs (1-4)
(1) Teacher desk, chair, computer workstation
- **Finishes** Floor: VCT
Base: Vinyl
Walls: CMU - painted
Ceiling: Suspended acoustic tile 9'-6" A.F.F.
Door: 36" X 84" with 8" x 30" vision glass
- **Electric outlets** Double duplex at desk location / Minimum (2) duplex outlets per wall
- **Telecommunications** Data / Phone outlet at teachers desk, wireless access point, interactive white board & projector provisions / Apple TV
- **Clock (Atomic)**
- **Ceiling speakers** Public Address System with Call Back
- **Motion Detector** lighting control

SPECIAL CHARACTERISTICS:

- **Provide window approximately 120" x 60" per classroom**

SPECIAL EDUCATION

SPACE NAME: SENSORY ROOM

USE OF SPACE - PURPOSE/ACTIVITIES:

A. Student support.

OCCUPANTS:

- **Staff** 1
- **Students** Varies 1-4

SIZE AND LOCATION:

- **Size** 500 sq ft
- **Location**

FURNISHINGS AND EQUIPMENT: (Items listed below are per space)

- **In-Contract** 72" x 48" total length whiteboard
72" x 48" total length tackboard
64" Interactive whiteboard (smart technology w/ projector)
Flag holder on wall
Teacher wardrobe 48"w x 72"h x 24"d with lock
- **By Owner** Desks (1-4)
Chairs (1-4)
(1) Teacher desk, chair, computer workstation
- **Finishes** Floor: VCT
Base: Vinyl
Walls: CMU - painted
Ceiling: Suspended acoustic tile 9'-6" A.F.F.
Door: 36" X 84" with 8" x 30" vision glass
- **Electric outlets** Double duplex at desk location / Minimum (2) duplex outlets per wall
- **Telecommunications** Data / Phone outlet at teachers desk, wireless access point, interactive white board & projector provisions / Apple TV
- **Clock (Atomic)**
- **Ceiling speakers** Public Address System with Call Back
- **Motion Detector** lighting control

SPECIAL CHARACTERISTICS:

- **Provide window approximately 120" x 60" per classroom**

SPECIAL EDUCATION

NAME: LIFE SKILLS

USE OF SPACE - PURPOSE/ACTIVITIES:

A. Special education programs and Instructional Support.

OCCUPANTS:

- **Staff** 1
- **Students** Varies 10-12

SIZE AND LOCATION:

- **Size** 1500 sq ft
- **Location**

FURNISHINGS AND EQUIPMENT: (Items listed below are per space)

- **In-Contract**
 - 192" x 48" whiteboard total length
 - 192" x 48" tackboard total length
 - 64" Interactive whiteboard (smart technology w/ projector)
 - Flag holder on wall
 - Kitchen counter with refrigerator, sink, dishwasher, electric range-top, wall & base cabinets
 - Teacher wardrobe 48"w x 72"h x 24"d with lock
 - 36" x 120" bookcase
 - Provide operable acoustic partition (min. STC 52) in between Academic and Life Skills rooms.
- **By Owner**
 - Desks (10-12)
 - Chairs (10-12)
 - (1) Teacher desk, chair, computer workstation
- **Finishes**
 - Floor: VCT
 - Base: Vinyl
 - Walls: CMU - painted
 - Ceiling: Suspended acoustic tile 9'-6" A.F.F.
 - Door: (2) 36" X 84" with 8" x 30" vision glass / each side of classroom
- **Electric outlets**
 - Double duplex at desk location / Minimum (2) duplex outlets per wall
 - (4) kitchen outlets (GFI), Appliance Outlets as required
- **Telecommunications**
 - Data / Phone outlet at teachers desk, wireless access point, interactive white board & projector provisions / Apple TV
- **Clock (Atomic)**
- **Ceiling speakers**
 - Public Address System with Call Back
- **Motion Detector**
 - lighting control

SPECIAL CHARACTERISTICS:

- **Provide window approximately 240" x 60" per classroom**

SPECIAL EDUCATION

SPACE NAME: SPEECH / OCUPATIONAL THERAPY (OT) / PHYSICAL THERAPY (PT) LAB

USE OF SPACE - PURPOSE/ACTIVITIES:

A. Student support.

OCCUPANTS:

- **Staff** 1
- **Students** 1-6

SIZE AND LOCATION:

- **Size** 800 sq ft
- **Location**

FURNISHINGS AND EQUIPMENT: (Items listed below are per space)

- **In-Contract** 72" x 48" whiteboard
72" x 48" whiteboard
Teacher wardrobe 48"w x 72"h x 24"d with lock
- **By Owner** Desks (1-6)
Chairs (1-6)
- **Finishes** Floor: VCT
Base: Vinyl
Walls: CMU - painted
Ceiling: Suspended acoustic tile 9'-0" A.F.F.
Door: 36" X 84" with 8" x 30" vision glass
- **Electric outlets** Double duplex at desk location / Minimum (2) duplex outlets per wall
- **Telecommunications** Data / Phone outlet at teachers desk
- **Clock (Atomic)**
- **Ceiling speakers** Public Address System with Call Back
- **Motion Detector** lighting control

SPECIAL CHARACTERISTICS:

- **Provide window approximately 240" x 60" per classroom**
- **Provide special ceiling support structure for physical therapy equipment.**

SPACE NAME: TRANSITION CENTER

USE OF SPACE - PURPOSE/ACTIVITIES:

- A. Transition House – Mock “apartment” living space and small work environment space
- B. Teach home and workplace life skills

OCCUPANTS:

- **Staff** 1
- **Students** Varies 1-4

SIZE AND LOCATION:

- **Size** 1200 sq ft
- **Location**

FURNISHINGS AND EQUIPMENT: (Items listed below are per space)

- **In-Contract** Bedroom, toilet, living and kitchen spaces
Small work environment space
Residential Kitchen Appliances
- **By Owner** Furniture (Residential)
- **Finishes** Floor: Carpet / VCT
Base: Vinyl
Walls: CMU - painted
Ceiling: Suspended acoustic tile 9'-6" A.F.F.
Door: 36" X 84" with 8" x 30" vision glass
- **Electric outlets** Minimum (2) duplex outlets per wall / countertop outlets
- **Telecommunications** Data / Phone outlet
- **Ceiling speakers** Public Address System with Call Back

SPECIAL CHARACTERISTICS:

- **Provide window approximately 240" x 60" per classroom**

SPECIAL EDUCATION

SPACE NAME: STORAGE ROOM

USE OF SPACE - PURPOSE/ACTIVITIES:

- A. Storage of Special Education supplies.

OCCUPANTS:

- **Staff** N/A
- **Students** N/A

SIZE AND LOCATION:

- **Size** 200 sq ft
- **Location**

FURNISHINGS AND EQUIPMENT:

- **In-Contract** 18 L.F. adjustable metal shelving units (12" deep by 84" high)
- **By Owner** N/A
- **Finishes** Floor: VCT
Base: Vinyl
Walls: CMU - painted
Ceiling: Suspended acoustic tile 9'-0" A.F.F.
Door: 36" X 84"
- **Electric outlets** Minimum (1) duplex per wall
- **Ceiling speaker** Public Address System
- **Telecommunications** Data/Phone outlet
- **Motion Detector** lighting control

SPECIAL CHARACTERISTICS:

- N/A

SPECIAL EDUCATION

SPACE NAME: CONFERENCE ROOM

USE OF SPACE - PURPOSE/ACTIVITIES:

A. Conference room for Special Education.

OCCUPANTS:

- **Staff** 8
- **Students** N/A

SIZE AND LOCATION:

- **Size** 250 sq ft
- **Location** Adjacent to principal's office with connecting door.

FURNISHINGS AND EQUIPMENT:

- **In-Contract** 4' x 8' tackboard
4' x 4' white marker board
64" Interactive whiteboard (smart technology w/ projector)
- **By Owner** Table
Chairs
- **Finishes** Floor: VCT
Base: Vinyl
Walls: CMU - painted
Ceiling: Suspended acoustic tile 9'-0" A.F.F.
Door: 36" X 84" with 8"x30" vision glass
- **Electric outlets** Minimum (1) duplex per wall / Projector ceiling outlet
- **Clock (Atomic)**
- **Ceiling speaker** Public Address System
- **Telecommunications** Data/Phone outlet / Interactive White Board / Projector provisions / Apple TV
- **Motion Detector** lighting control
- **Fire alarm mini-audio/visual signaling device**

SPECIAL CHARACTERISTICS:

- N/A

SPACE NAME: TESTING ROOM

USE OF SPACE - PURPOSE/ACTIVITIES:

A. Student support.

OCCUPANTS:

- **Staff** 1
- **Students** Varies 1-2

SIZE AND LOCATION:

- **Size** 100 sq ft
- **Location**

FURNISHINGS AND EQUIPMENT: (Items listed below are per space)

- **In-Contract** 48" x 48" total length whiteboard
48" x 48" total length tackboard
- **By Owner** Desks (1-2)
Chairs (1-2)
- **Finishes** Floor: VCT
Base: Vinyl
Walls: CMU - painted
Ceiling: Suspended acoustic tile 9'-0" A.F.F.
Door: 36" X 84" with 8" x 30" vision glass
- **Electric outlets** Minimum (1) duplex outlet per wall
- **Telecommunications** Data / Phone outlet
- **Ceiling speakers** Public Address System
- **Motion Detector** lighting control

SPECIAL CHARACTERISTICS:

- **N/A**

SPACE NAME: SPECIAL EDUCATION TEAM ROOM

- A. Individual teachers work area and storage of professional materials.
- B. Specific Activities:
 - Teacher and staff preparation of materials
 - Space for teacher and staff files
 - Space for teacher and staff supplies and storage.

OCCUPANTS:

- **Staff** 6-8
- **Students** N/A

SIZE AND LOCATION:

- **Size** 400 sq ft
- **Location** Central to the Special Education Department.

FURNISHINGS AND EQUIPMENT:

- **In-Contract** 6 ft. work counter/cabinet with sink/hot and cold water
48" x 48" tackboard
48" x 48" whiteboard
- **By Owner** Copier Equipment
Bookcases
File Cabinets
Sofa
2 Round tables
8 Chairs
4 Lounge chairs
- **Finishes** Floor: VCT
Base: Vinyl
Walls: CMU - painted
Ceiling: Suspended acoustic tile 9'-0" A.F.F.
Door: 36" X 84" with 24" x 36" vision glass
- **Electric outlets** Minimum (2) duplex per wall, (2) duplex outlets above counter, and (1) 208V outlet for copying equipment
- **Telecommunications** (1) data outlet for copying equipment / Wireless Access Point
- **Ceiling speaker** Public Address System
- **Motion Detector** lighting control

SPECIAL CHARACTERISTICS:

- **N/A**

SPACE NAME: TOILET CHANGING ROOM

USE OF SPACE - PURPOSE/ACTIVITIES:

- A. Controlled student use
- B. Specific Activities:
 - Rest room facility
 - H/C accessible

OCCUPANTS:

- Staff 1
- Students N/A

SIZE AND LOCATION:

- Size 80 sq ft each
- Location Proximity to Special Education with separate entrance to Corridor

FURNISHINGS AND EQUIPMENT:

- In-Contract Toilet accessories
- By Owner N/A
- Finishes
 - Floor: ceramic tile
 - Base: ceramic tile
 - Walls: ceramic tile wainscot 5—0" - CMU - painted - epoxy
 - Ceiling: suspended acoustic tile 8'-0" A.F.F.
 - Door: 36" X 84" with privacy lock
- Ceiling speaker Public Address System
- Motion Detector lighting control

SPECIAL CHARACTERISTICS:

- ADA Accessible

SPACE NAME: STAFF TOILET

USE OF SPACE - PURPOSE/ACTIVITIES:

- A. For Staff use
- B. Specific Activities:
 - Rest room facility
 - H/C accessible

OCCUPANTS:

- **Staff** 1
- **Students** N/A

SIZE AND LOCATION:

- **Size** 60 sq ft each
- **Location**

FURNISHINGS AND EQUIPMENT:

- **In-Contract** Toilet accessories
- **By Owner** N/A
- **Finishes**
 - Floor: ceramic tile
 - Base: ceramic tile
 - Walls: ceramic tile wainscot 5—0" - CMU - painted - epoxy
 - Ceiling: suspended acoustic tile 8'-0" A.F.F.
 - Door: 36" X 84" with privacy lock
- **Ceiling speaker** Public Address System
- **Motion Detector** lighting control

SPECIAL CHARACTERISTICS:

- **ADA Accessible**

TECHNOLOGY SUPPORT SERVICES

SPACE NAME: IT ADMIN OFFICE / COMMAND CENTER

USE OF SPACE - PURPOSE/ACTIVITIES:

A. IT Storage and Repair.

OCCUPANTS:

- **Staff** 6
- **Students** N/A

SIZE AND LOCATION:

- **Size** 1000 sq ft
- **Location** Adjacent Server Room

FURNISHINGS AND EQUIPMENT: (Items listed below are per space)

- **In-Contract** 120" x 48" tackboard
192" x 48" whiteboard
- **By Owner** Stools (2)
Desk (4)
Chair (4)
Filing Cabinet (1)
Shelving
Workbench (2)
- **Finishes** Floor: VCT
Base: Vinyl
Walls: CMU - painted
Ceiling: Suspended acoustic tile 9'-6" A.F.F.
Door: 36" X 84" with 8" x 30" vision glass
- **Electric outlets** (6) Double duplex at desk locations and workbenches / Minimum (2) duplex outlets per wall
- **Telecommunications** (6) Data / Phone outlets at desks and workbenches, wireless access point,
- **Clock (Atomic)**
- **Ceiling speakers** Public Address System with
- **Motion Detector** lighting control

SPECIAL CHARACTERISTICS:

- Window to Exterior

TECHNOLOGY SUPPORT SERVICES

SPACE NAME: DIGITAL TECHNOLOGY STORAGE

USE OF SPACE - PURPOSE/ACTIVITIES:

- A. Storage of technology and related supplies.

OCCUPANTS:

- **Staff** N/A
- **Students** N/A

SIZE AND LOCATION:

- **Size** 200 sq ft
- **Location** Adjacent to IT Admin Office

FURNISHINGS AND EQUIPMENT:

- **In-Contract** 18 L.F. adjustable metal shelving units (24" deep by 84" high)
- **By Owner** N/A
- **Finishes** Floor: VCT
Base: Vinyl
Walls: CMU - painted
Ceiling: Suspended acoustic tile 9'-0" A.F.F.
Door: 36" X 84"
- **Electric outlets** Minimum (1) duplex per wall
- **Ceiling speaker** Public Address System
- **Telecommunications** Data/Phone outlet
- **Motion Detector** lighting control

SPECIAL CHARACTERISTICS:

- N/A

TECHNOLOGY SUPPORT SERVICES

SPACE NAME: SERVER ROOM

USE OF SPACE - PURPOSE/ACTIVITIES:

A. Central space for network servers and Cox Data & VOIP head end.

OCCUPANTS:

- **Staff** N/A
- **Students** N/A

SIZE AND LOCATION:

- **Size** 300 sq ft
- **Location** Adjacent to IT Admin Office

FURNISHINGS AND EQUIPMENT:

- **In-Contract** Main distribution equipment for security, telephone, and computer networking
- **By Owner**
- **Finishes** Floor: VCT
Base: Vinyl
Walls: Fire Rated Plywood - painted
Ceiling: Suspended acoustic tile 9'-0" A.F.F.
Door: 36" X 84"
- **Electric outlets** Minimum double duplex at each wall. Provide Emergency power and UPS for racks and equipment
- **Ceiling speaker** Public Address System
- **Telecommunications** Data/Phone outlet
- **Lock on Door** Card Reader Door Access
- **Motion Detector** lighting control

SPECIAL CHARACTERISTICS:

- **No windows**
- **Dedicated HVAC to maintain temperature control 24 hours/day**
- **Halon or Dry Sprinkler System**

BUILDING SERVICES / MAINTENANCE

SPACE NAME: BUILDING SERVICES – CUSTODIAL / MAINTENANCE OFFICE / SHOP

USE OF SPACE - PURPOSE/ACTIVITIES:

- A. Specific Activities:
- Maintenance Staff office
 - Maintenance Shop

OCCUPANTS:

- Staff 3-5
- Students N/A

SIZE AND LOCATION:

- Size 800 sq ft
- Location

FURNISHINGS AND EQUIPMENT:

- In-Contract (10) Metal Lockers 18" x 84"
- By Owner (3) Desk
(3) Chair
File Cabinet
Shop Equipment
- Finishes Floor: VCT
Base: Vinyl
Walls: CMU painted
Ceiling: Suspended acoustic tile 12'-0" A.F.F.
Door: 36" X 84" with 8" x 30" vision glass
- Electric outlets Double duplex at desk locations / Minimum (4) duplex per wall
Coordinate Electric Requirements for Shop Equipment
- Telecommunications Data/Phone outlet at Desks / Wireless Access Point
- Ceiling speaker Public Address System
- Motion Detector lighting control

SPECIAL CHARACTERISTICS:

- Provide 9'-0" wide x 10'-0" high roll-up door to Exterior
- Provide Card Reader Access on both sides of interior door
- Provide parking for (6) maintenance vehicles outside Maintenance Office

BUILDING SERVICES / MAINTENANCE

SPACE NAME: BUILDING SERVICES - RECEIVING / STORAGE

USE OF SPACE - PURPOSE/ACTIVITIES:

- A. Storage
- B. Specific Activities:

OCCUPANTS:

- **Staff** N/A
- **Students** N/A

SIZE AND LOCATION:

- **Size** 1200 sq ft
- **Location** Adjacent to Loading Dock

FURNISHINGS AND EQUIPMENT:

- **In-Contract** 40 L.F. adjustable metal shelving units (12" deep by 84" high)
- **By Owner** N/A
- **Finishes** Floor: VCT
Base: Vinyl
Walls: CMU - painted
Ceiling: Exposed Structure - painted
Door: 36" X 84" double doors w/ removable mullion
- **Electric outlets** (2) duplex outlet per wall
- **Ceiling speaker** Public Address System
- **Telecommunications** Data / Phone outlet

SPECIAL CHARACTERISTICS:

- **Card Reader Door Access**

BUILDING SERVICES / MAINTENANCE

SPACE NAME: STAFF TOILET

USE OF SPACE - PURPOSE/ACTIVITIES:

- A. For Staff use
- B. Specific Activities:
 - Rest room facility
 - H/C accessible

OCCUPANTS:

- Staff 1
- Students N/A

SIZE AND LOCATION:

- Size 60 sq ft each
- Location Adjacent Custodial / Maint Office / Shop

FURNISHINGS AND EQUIPMENT:

- In-Contract Toilet accessories
- By Owner N/A
- Finishes
 - Floor: ceramic tile
 - Base: ceramic tile
 - Walls: ceramic tile wainscot 5'-0" - CMU - painted - epoxy
 - Ceiling: suspended acoustic tile 8'-0" A.F.F.
 - Door: 36" X 84" with privacy lock
- Ceiling speaker Public Address System
- Motion Detector lighting control

SPECIAL CHARACTERISTICS:

- ADA Accessible

BUILDING SERVICES / MAINTENANCE

SPACE NAME: OUTDOOR STORAGE FACILITY

USE OF SPACE - PURPOSE/ACTIVITIES:

- A. Unconditioned Space for the storage of outdoor equipment and small vehicles. Can be a stand alone outdoor storage building.

OCCUPANTS:

- Staff n/a
- Students N/A

SIZE AND LOCATION:

- Size 2000 sq ft
- Location Convenient from Maintenance Shop and Athletic Department

FURNISHINGS AND EQUIPMENT:

- In-Contract 10' wide x 10' high roll-up Door
- By Owner
- Finishes Floor: Concrete
Base: None
Walls: CMU - painted
Ceiling: Open Structure
Door: 36" X 84"
- Electric outlets Minimum (1) duplex per wall
- Telecommunications Phone/Data Outlet

SPECIAL CHARACTERISTICS:

- N/A

HEALTH SERVICES

SPACE NAME: CLINIC WAITING / RECEPTION

USE OF SPACE - PURPOSE/ACTIVITIES:

- A. Specific Activities:
- Center for care of students becoming ill during school hours
 - First Aide Station

OCCUPANTS:

- **Staff** 1
- **Students** Varies

SIZE AND LOCATION:

- **Size** 50 sq ft
- **Location** Direct access from corridor and co-located with administration.

FURNISHINGS AND EQUIPMENT:

- **In-Contract** 48" x 72" tackboard
- **By Owner** Table
2 Side Chairs
- **Finishes** Floor: VCT
Base: Vinyl
Walls: CMU - painted
Ceiling: suspended acoustic tile 9'-0" A.F.F.
Door: 36" X 84" with 8" x 30" vision glass
- **Electric outlets** Minimum (1) duplex per wall
-
- **Telecommunications** Data / Phone outlet
-
- **Ceiling speaker** Public Address System

SPECIAL CHARACTERISTICS:

- N/A

HEALTH SERVICES

SPACE NAME: NURSE'S OFFICE

USE OF SPACE - PURPOSE/ACTIVITIES:

- A. Office for Health Nurse
- B. Specific Activities:
 - Conferring with Ill Students

OCCUPANTS:

- **Staff** 1
- **Students** 1

SIZE AND LOCATION:

- **Size** 100 sq ft
- **Location** Adjacent to main administrative area. Direct connection to clinic waiting room.

FURNISHINGS AND EQUIPMENT:

- **In-Contract** 48" x 48" tackboard
Built in Casework workstation
- **By Owner** Desk
Chair
Side Chairs (2)
File Cabinet
- **Finishes** Floor: Carpet
Base: Vinyl
Walls: CMU - painted
Ceiling: suspended acoustic tile 9'-0" A.F.F.
Door: 36" X 84"
- **Electric outlets** Double duplex at desk location / Minimum (1) duplex per wall
- **Telecommunications** Data / Phone outlet at desk
- **Ceiling speaker** Public Address System with Call Back

SPECIAL CHARACTERISTICS:

- N/A

SPACE NAME: EXAM ROOM

USE OF SPACE - PURPOSE/ACTIVITIES:

- A. Specific Activities:
- Private space to exam ill students during the school day

OCCUPANTS:

- **Staff** 1
- **Students** 1

SIZE AND LOCATION:

- **Size** 150 sq ft
- **Location** Adjacent to Clinic Waiting Room. Provide closet with shelves and lock

FURNISHINGS AND EQUIPMENT:

- **In-Contract** H/C lavatory and faucet
Rough-in for refrigerator with ice maker
6 L.F. base and wall cabinet with locks
Ceiling mounted curtain track and curtain
- **By Owner** Table
2 Side Chairs
Refrigerator with ice maker
Clinic Bed
- **Finishes** Floor: VCT
Base: Vinyl
Walls: CMU - painted - epoxy
Ceiling: suspended acoustic tile 9'-0" A.F.F.
Door: 36" X 84"
- **Electric outlets** Minimum (2) duplex per wall / Refrigerator Circuit on Emergency Power
- **Telecommunications** Data / Phone outlet
- **Ceiling speaker** Public Address System with Call Back

SPECIAL CHARACTERISTICS:

- N/A

HEALTH SERVICES

SPACE NAME: RESTING AREA

USE OF SPACE - PURPOSE/ACTIVITIES:

- A. Specific Activities:
- A separate space for cots where ill students can rest or wait for parent pick-up

OCCUPANTS:

- Staff 1
- Students 2

SIZE AND LOCATION:

- Size 100 sq ft
- Location Adjacent Exam Room.

FURNISHINGS AND EQUIPMENT:

- **In-Contract** Ceiling mounted curtain track and curtain to provide 2 separate rest areas
- **By Owner** Clinic Table
2 Side Chairs
Recovery Cots (2)
- **Finishes** Floor: VCT
Base: Vinyl
Walls: CMU - painted - epoxy
Ceiling: suspended acoustic tile 9'-0" A.F.F.
Door: 36" X 84"
- **Electric outlets** none near cots
- **Ceiling speaker** Public Address System

SPECIAL CHARACTERISTICS:

- N/A.

HEALTH SERVICES

SPACE NAME: STORAGE

USE OF SPACE - PURPOSE/ACTIVITIES:

- A. Storage of clinic supplies.

OCCUPANTS:

- Staff N/A
- Students N/A

SIZE AND LOCATION:

- Size 50 sq ft
- Location Adjacent to rest area and exam room.

FURNISHINGS AND EQUIPMENT:

- **In-Contract** 10 L.F. adjustable metal shelving units (12" deep by 84" high)
- **By Owner** N/A
- **Finishes** Floor: VCT
Base: Vinyl
Walls: CMU - painted
Ceiling: Suspended acoustic tile 9'-0" A.F.F.
Door: 36" X 84"
- **Electric outlets** Minimum (1) duplex per wall
- **Ceiling speaker** Public Address System
- **Telecommunications** Data/Phone outlet
- **Motion Detector** Lighting control

SPECIAL CHARACTERISTICS:

- N/A

HEALTH SERVICES

SPACE NAME: HEALTH CLINIC TOILET

USE OF SPACE - PURPOSE/ACTIVITIES:

- A. For Student use
- B. Specific Activities:
 - Rest room facility
 - H/C accessible

OCCUPANTS:

- **Staff** N/A
- **Students** 1

SIZE AND LOCATION:

- **Size** 75 sq ft
- **Location** Adjacent to exam room.

FURNISHINGS AND EQUIPMENT:

- **In-Contract** Toilet accessories
- **By Owner** N/A
- **Finishes** Floor: ceramic tile
Base: ceramic tile
Walls: ceramic tile wainscot 5'-0" - CMU - painted - epoxy
Ceiling: suspended acoustic tile 8'-0" A.F.F.
Door: 36" X 84" with privacy lock
- **Ceiling speaker** Public Address System
- **Motion Detector** Lighting control

SPECIAL CHARACTERISTICS:

- **ADA Accessible**

FOOD SERVICE

SPACE NAME: DINING / COMMONS

USE OF SPACE - PURPOSE/ACTIVITIES:

- A. The cafeteria shall house the entire school population in three sittings for lunch
- B. The dining area should serve group activities of various sizes.
- C. Easy community access should be a consideration to accommodate meetings and dinners.

OCCUPANTS:

- **Staff** 15
- **Students** 550 per lunch shift (tables and chairs); 800 for assemblies (chairs only)

SIZE AND LOCATION:

- **Size** 7000 sq ft
- **Location** Locate accessible to an outside blacktop area and to rest rooms. Adjacent to parking.

FURNISHINGS AND EQUIPMENT:

- **In-Contract** 48" x 72" tackboards (6)
10' x 8' motorized movie screen (ceiling mounted remote control)
Ceiling Projector
(2) 42" TV's above serving line entrances
(4) 42" TV's in Cafeteria
(1) 60" TV in Cafeteria
Provide space for (6) vending machines
(2) Water Coolers
(8) Microwaves – Microwave Stations
- **By Owner** Tables
Chairs (800)
- **Finishes** Floor: VCT
Base: Vinyl
Walls: CMU - painted – epoxy / Sound Panels
Ceiling: Suspended acoustic tile 12'-0" A.F.F.
Door: 36" X 84" with 24" x 36" vision glass from corridors, electronic door holders
- **Electric Outlets** Minimum (32) duplex outlets / Computer Charging Station / Vending Machine Provisions / TV Provisions
- **Clock (Atomic)**
- **Telecommunications** (4) Data Outlets / (1) Phone Outlet / (4) wireless access points / Data at TV Locations
- **Ceiling speakers for building Public Address systems with Call Back (10 min.)**
- **Ceiling speakers for portable P.A. system (10 min.)**
- **Portable P.A. system wall jacks**
- **Electronic Door Holders**

SPECIAL CHARACTERISTICS:

- **Windows to exterior**

FOOD SERVICE

SPACE NAME: SERVING

USE OF SPACE - PURPOSE/ACTIVITIES:

A. Provide dual serving lines for distribution of lunches

OCCUPANTS:

- **Staff** 6
- **Students** Varies

SIZE AND LOCATION:

- **Size** 1600 sq ft (verify size with equipment layout)
- **Location** Adjacent to Dining / Commons

FURNISHINGS AND EQUIPMENT:

- **In-Contract** Serving line equipment (see food service equipment specification)
(4) Cash registers (two point of sale systems per line)
(2) 42" TV's (one per serving line)
- **By Owner**
- **Finishes** Floor: quarry tile w/ epoxy grout
Base: quarry tile
Walls: ceramic tile
Ceiling: suspended acoustic tile 10'-0" A.F.F.
Door: 36" X 84" (Quantity as required by code)
- **Electric Outlets** General use outlets / specialized electric for equipment
- **Telecommunications** (4) Data lines / (1) Phone for communicating cash register to office
- **Clock (Atomic)**
- **Ceiling speakers** Public Address System

SPECIAL CHARACTERISTICS:

- Provide necessary utilities for serving line equipment

SPACE NAME: KITCHEN

USE OF SPACE - PURPOSE/ACTIVITIES:

- A. Specific Activities
- Preparation of food

OCCUPANTS:

- **Staff** 15
- **Students** N/A

SIZE AND LOCATION:

- **Size** 1500 sq ft
- **Location** Adjacent to serving area.

FURNISHINGS AND EQUIPMENT:

- **In-Contract** Food preparation equipment (see typical kitchen layout)
(4) 48" x 48" whiteboard
- **By Owner** Miscellaneous cooking utensils
- **Finishes** Floor: quarry tile w/ epoxy grout
Base: quarry tile
Walls: ceramic tile
Ceiling: suspended acoustic tile 10'-0" A.F.F.
Door: 42" X 84" with 24" x 36" vision glass at exterior with 42" X 80" screen door, all other doors 36" x 84"
- **Electric Outlets** outlets and specialized electric for equipment / ceiling reals for island worktables
- **Telecommunications** Data / Phone outlet
- **Clock (Atomic)**
- **Ceiling speakers** Public Address System

SPECIAL CHARACTERISTICS:

- Provide exhaust hood with fire suppression (as required by code)
- Loading platform for two vehicles and two trash dumpsters (1 regular, 1 recycle) conveniently located for deliveries and to dry food storage, but not in front of building or near entrances that may be used by public. Dock height 42". Deliveries of supplies and equipment other than food service shall have a separate access to school and not pass through the kitchen. Provide ramp from loading platform to street level
- Kitchen keyed separate from building

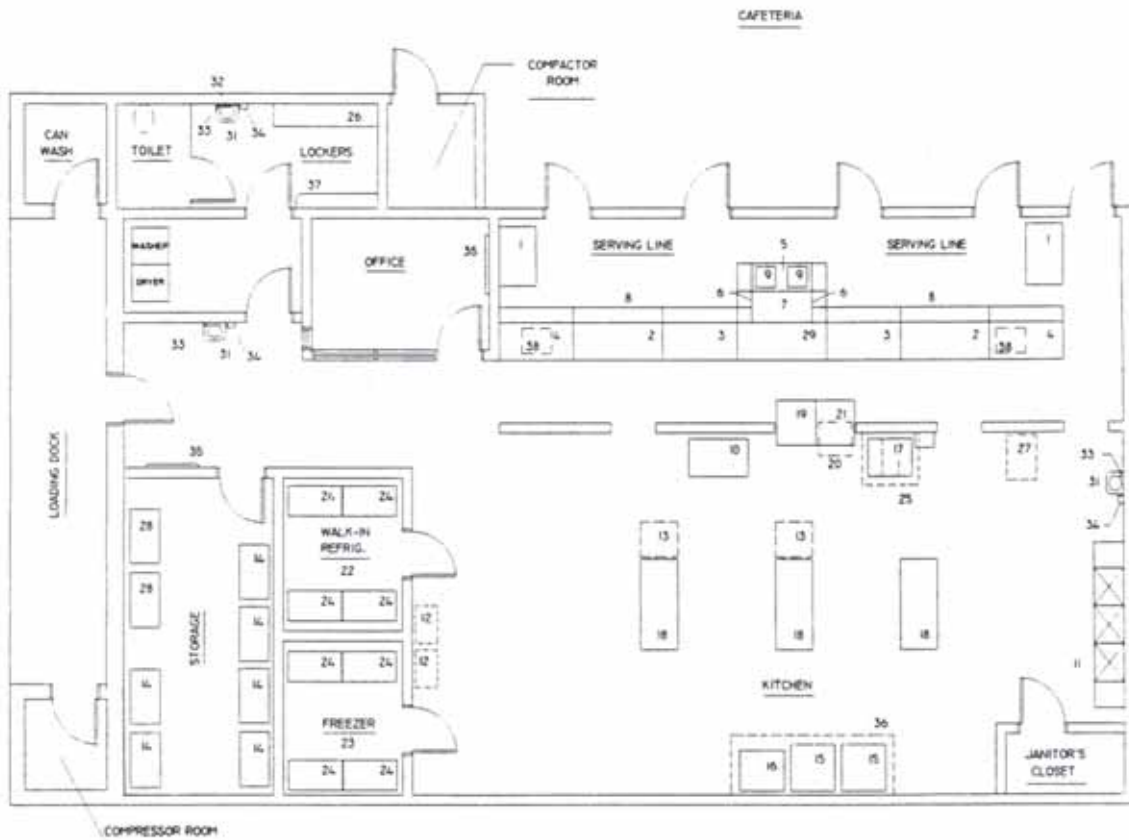

SAMPLE KITCHEN LAYOUT
(See Specific Items included below)

KITCHEN

GENERAL REQUIREMENTS

AS FEASIBLE, ALL EQUIPMENT AND TABLES SHOULD BE ON WHEELS

- (4) PAPER TOWEL DISPENSERS
- (4) SOAP DISPENSERS
- (2) FIRE EXTINGUISHER

EQUIPMENT LIST (Modify to create serving area for faster service with multiple stations) :

1. (2) MILK COOLER (Serving Line)
2. (2) PORTABLE INDUCTION HOT FOOD TABLE (Serving Line)
3. (2) FROST TOP TABLE (Serving Line)
4. (2) PORTABLE SOLID TOP TABLE (Serving Line) – Ceiling Electric Reals Above
5. (4) PORTABLE CASHIER'S TABLE (Serving Line)
6. FALSE FRONT PANEL WITH TRAY SLIDE (Serving Line)
8. TRAY SLIDE (Serving Line)
9. (4) COMPUTERIZED POINT OF SALE (Serving Line)
- 9.A (4) PASS THROUGH REFRIGERATORS WITH GLASS DOORS (Serving Line)
- 9.B (1) SALAD BAR (One side of Serving Line)
- 9.C (1) DELI BAR (One side of Serving Line)

FOOD SERVICE

11. (1) 3 COMPARTMENT POT SINK WITH BOOSTER HEATER AND GARBAGE DISPOSAL
- 11.A (1) 2 COMPARTMENT FOOD PREP SINK
12. (2) UTILITY CARRIER TRUCK
13. (2) PAN RACK
14. (8) SHELVING FOR DRY STORAGE
15. (3) DOUBLE DECK CONVECTION OVEN, GAS
16. (2) TILT SKILLET
- ~~18. (3) WORK TABLE~~
19. (2) REFRIGERATOR, PASS-THROUGH
20. (2) STORAGE RACK FOR ROLL-THROUGH
21. (2) ROLL-TROUGH HOT CABINET
22. WALK-IN REFRIGERATOR WITH REMOTE TEMPERATURE ALARM
23. WALK-IN FREEZER WITH REMOTE TEMPERATURE ALARM
24. (32) SHELVING FOR WALK-IN FREEZER/REFRIGERATOR
27. (2) HOT MOBILE FOOD TRANSPORT CART
29. (7) PORTABLE SOLID TOP WORK TABLE
- 29.A (2) 4 BURNER GAS GRILL
- 29.B (1) 2 BURNER OPEN FLAME UNIT
- 29.C (1) MICROWAVE STATION
- 29.D (1) 80 QUART MIXER
- 29.E (1) SLICER STATION
- 29.F (1) ICE MAKER
- 29.G (1) DOUBLE DECK STEAMER
- 29.H (1) KETTLE
30. EUTECTIC LIDS (LOOSE EQUIPMENT, NOT SHOWN)
31. HANDWASHING SINK
32. WALL MOUNTED MIRROR
33. SOAP DISPENSER
34. PAPER TOWEL DISPENSER
35. (4) WHITEBOARD 4'-0"L X 4'-0"H
36. MECHANICAL EXHAUST HOOD WITH FIRE PREVENTION SYSTEM
40. RESIDENTIAL WASHER AND DRYER (Catering Storage Room)
41. TRAY WASHER
42. DISHWASHER

SPACE NAME: KITCHEN OFFICE

USE OF SPACE - PURPOSE/ACTIVITIES:

- A. Specific Activities:
- Private office.
 - Visual control of food preparation and exterior entry

OCCUPANTS:

- **Staff** 1
- **Students** N/A

SIZE AND LOCATION:

- **Size** 50 sq ft
- **Location** Adjacent to kitchen area

FURNISHINGS AND EQUIPMENT:

- **In-Contract** 48" x 48" whiteboard
- **By Owner** Desk
Chair
Bookcase
File Cabinet
- **Finishes** Floor: VCT
Base: Vinyl
Walls: CMU - painted
Ceiling: Suspended acoustic tile 9'-0" A.F.F.
Door: 36" X 84"
Vision windows (3' x 3' w/ blinds) into kitchen
- **Electric outlets** Double duplex at desk location / Minimum (1) duplex outlet per wall
- **Telecommunications** Data / Phone outlets at desks
- **Ceiling speakers** Public Address System

SPECIAL CHARACTERISTICS:

- **Visual control of food preparation area and delivery doors.**

SPACE NAME: WALK-IN REFRIGERATOR

USE OF SPACE - PURPOSE/ACTIVITIES:

A. Walk-in refrigerator storage box with remote compressor

OCCUPANTS:

- **Staff** N/A
- **Students** N/A

SIZE AND LOCATION:

- **Size** 500 sq ft
- **Location** Directly adjacent to kitchen area.

FURNISHINGS AND EQUIPMENT:

- **In-Contract** Walk-in freezer box with mobile wire shelves
- **By Owner** N/A
- **Finishes** N/A

SPECIAL CHARACTERISTICS:

- **Remote compressor**
- **Remote Temperature Alarm**

SPACE NAME: WALK-IN FREEZER

USE OF SPACE - PURPOSE/ACTIVITIES:

A. Walk-in freezer storage box with remote compressor

OCCUPANTS:

- **Staff** N/A
- **Students** N/A

SIZE AND LOCATION:

- **Size** 500 sq ft
- **Location** Directly adjacent to kitchen area.

FURNISHINGS AND EQUIPMENT:

- **In-Contract** Walk-in freezer box with mobile wire shelves
- **By Owner** N/A
- **Finishes** N/A

SPECIAL CHARACTERISTICS:

- **Remote compressor**
- **Provide insulated depressed floor**
- **Remote Temperature Alarm**

SPACE NAME: DRY STORAGE

USE OF SPACE - PURPOSE/ACTIVITIES:

A. Storage of food supplies and disposable serving utensils

OCCUPANTS:

- **Staff** N/A
- **Students** N/A

SIZE AND LOCATION:

- **Size** 600 sq ft
- **Location** Adjacent to kitchen with easy access to delivery area and loading dock.

FURNISHINGS AND EQUIPMENT:

- **In-Contract** Metal wire shelving (mobile)
- **By Owner** N/A
- **Finishes** Floor: VCT
Base: Vinyl
Walls: CMU - painted
Ceiling: suspended acoustic tile 10'-0" A.F.F.
Door: 36" X 84"
- **Electric outlets** (1) duplex outlet per wall
- **Ceiling speaker** Public Address System
- **Lock on Door** Card Reader access

SPECIAL CHARACTERISTICS:

- N/A

SPACE NAME: CATERING STORAGE ROOM

USE OF SPACE - PURPOSE/ACTIVITIES:

A. Storage of food supplies and utensils

OCCUPANTS:

- Staff N/A
- Students N/A

SIZE AND LOCATION:

- Size 300 sq ft
- Location Adjacent to kitchen .

FURNISHINGS AND EQUIPMENT:

- **In-Contract** Metal wire shelving (mobile)
Residential Washer and Dryer
- **By Owner** N/A
- **Finishes** Floor: VCT
Base: Vinyl
Walls: CMU - painted
Ceiling: suspended acoustic tile 10'-0" A.F.F.
Door: 36" X 84"
- **Electric outlets** (1) duplex outlet per wall
- **Ceiling speaker** Public Address System
- **Telecommunications** Data / Phone Outlet

SPECIAL CHARACTERISTICS:

- N/A

FOOD SERVICE

SPACE NAME: FACULTY DINING / LOUNGE

USE OF SPACE - PURPOSE/ACTIVITIES:

- A. Specific Activities:
- Staff eating lunch.
 - Meetings
 - Comfort.

OCCUPANTS:

- **Staff** 15-20
- **Students** N/A

SIZE AND LOCATION:

- **Size** 300 sq ft
- **Location** N/A.

FURNISHINGS AND EQUIPMENT:

- **In-Contract** 4x 8' tackboard
Rough-in for refrigerator with ice maker
12 L.F. base cabinet with sink and wall cabinets above
- **By Owner** 4 Lounge chairs
4 Round tables
16 Side chairs
Refrigerator with ice maker
- **Finishes** Floor: VCT
Base: Vinyl
Walls: Gypsum wallboard painted
Ceiling: Suspended acoustic tile 9'-0" A.F.F.
Door: 36" X 84"
- **Electric outlets** (2) Vending machines / Minimum (2) outlet per wall.
- **Telecommunications** Data Outlets / Phone Outlet, wireless access point
- **Ceiling speaker** Public Address System

SPECIAL CHARACTERISTICS:

- N/A

SPACE NAME: KITCHEN STAFF BREAKROOM

USE OF SPACE - PURPOSE/ACTIVITIES:

- A. Specific Activities:
- Staff eating lunch.
 - Meetings
 - Comfort.

OCCUPANTS:

- Staff 4-5
- Students N/A

SIZE AND LOCATION:

- Size 150 sq ft
- Location N/A.

FURNISHINGS AND EQUIPMENT:

- **In-Contract** 4 x 4' whiteboard
Rough-in for refrigerator with ice maker
8 L.F. base cabinet with sink and wall cabinets above
(8) Metal Lockers
- **By Owner** 2 Round tables
8 Side chairs
Refrigerator with ice maker
- **Finishes** Floor: VCT
Base: Vinyl
Walls: Gypsum wallboard painted
Ceiling: Suspended acoustic tile 9'-0" A.F.F.
Door: 36" X 84"
- **Electric outlets** Minimum (2) outlet per wall.
- **Telecommunications** Data / Phone Outlet
- **Ceiling speaker** Public Address System

SPECIAL CHARACTERISTICS:

- N/A

FOOD SERVICE

SPACE NAME: SENIOR COURTYARD / OUTDOOR SPACE

USE OF SPACE - PURPOSE/ACTIVITIES:

- A. Specific Activities:
- Seniors eating lunch.
 - Comfort.

OCCUPANTS:

- **Staff** N/A
- **Students** N/A

SIZE AND LOCATION:

- **Size** 0 sq ft
- **Location** Adjacent to Dining / Commons

FURNISHINGS AND EQUIPMENT:

- **In-Contract**
- **By Owner** Round tables
Chairs
- **Finishes** Floor: Concrete Patio 1000 SF
Door: 36" X 84"
- **Speakers** Public Address System

SPECIAL CHARACTERISTICS:

- N/A

SPACE NAME: STAFF TOILET

USE OF SPACE - PURPOSE/ACTIVITIES:

- A. For Staff use
- B. Specific Activities:
 - Rest room facility
 - H/C accessible

OCCUPANTS:

- **Staff** 1
- **Students** N/A

SIZE AND LOCATION:

- **Size** 60 sq ft each
- **Location** By Faculty Dining

FURNISHINGS AND EQUIPMENT:

- **In-Contract** Toilet accessories
- **By Owner** N/A
- **Finishes** Floor: ceramic tile
Base: ceramic tile
Walls: ceramic tile wainscot 5'-0" - CMU - painted - epoxy
Ceiling: suspended acoustic tile 8'-0" A.F.F.
Door: 36" X 84" with privacy lock
- **Ceiling speaker** Public Address System
- **Motion Detector** lighting control

SPECIAL CHARACTERISTICS:

- **ADA Accessible**

ADMINISTRATION / SAFETY / GUIDANCE

SPACE NAME: SECURE VESTIBULE

USE OF SPACE - PURPOSE/ACTIVITIES:

- A. The secure vestibule is the main security checkpoint for entrance into the school. All visitors to the school should enter the vestibule and be directed into the Main Office.
- B. Specific Activities:
 - Security Checkpoint

OCCUPANTS:

- **Staff** 1
- **Students** N/A

SIZE AND LOCATION:

- **Size** 300 sq ft
- **Location** Main entrance to building.

FURNISHINGS AND EQUIPMENT:

- **In-Contract** Security Desk
- **By Owner** Chair
- **Finishes** Floor: Epoxy Terrazzo / Walk-off Mat
Base: Terrazzo
Walls: CMU – painted; Storefront
Ceiling: Suspended acoustic tile 10'0" A.F.F.
Door: Storefront System
- **Electric outlets** Maintenance Outlets (1) / Duplex Outlet at Security Desk
- **Security CCTV** Monitor at Security Desk for Entrance Doors
- **Intercom** Main visitor entrance – Master Station at Security Desk
- **Buzzer/elec. release** Main visitor entrance
- **Key pad for security**
- **Ceiling Speakers** Public Address System
- **Telecommunications** Data Outlet at Security Station

SPECIAL CHARACTERISTICS:

- Provide security station in entrance vestibule with built-in Desk. Provide electronic door release for Main Entrance Doors. Egress Doors from Vestibule to Lobby should be lockable to provide emergency egress only.
- Provide impact resistant glazing in Vestibule – all sides.

ADMINISTRATION / SAFETY / GUIDANCE

SPACE NAME: ENTRANCE LOBBY

USE OF SPACE - PURPOSE/ACTIVITIES:

- A. All visitors to the school should enter the Lobby through the Main Office. The lobby acts as a common gathering point and should reflect the identity of George Mason High School.
- B. Specific Activities:
 - Waiting / Gathering Area

OCCUPANTS:

- **Staff** N/A
- **Students** N/A

SIZE AND LOCATION:

- **Size** 800 sq ft
- **Location** Main entrance to building.

FURNISHINGS AND EQUIPMENT:

- **In-Contract** Bench
School Name and Graphic
- **By Owner** _____

- **Finishes** Floor: Epoxy Terrazzo
Base: Terrazzo
Walls: CMU - painted
Ceiling: Suspended acoustic tile 10'0" A.F.F.
Door: Storefront System
- **Electric outlets** Maintenance Outlets (4) / (2) TV Outlets
- **Ceiling Speakers** Public Address System
- **Telecommunications** (2) Data Outlets at Wall mounted TVs / wireless access point

SPECIAL CHARACTERISTICS:

- Egress doors from Lobby to Vestibule should be lockable to provide egress only.
- Relocate existing GMHS logo in floor of existing building outside the Media Center to new Lobby.

ADMINISTRATION / SAFETY / GUIDANCE

SPACE NAME: RECEPTION / CLERICAL

USE OF SPACE - PURPOSE/ACTIVITIES:

- A. The administrative suite is the coordinating unit for all activities in the school and between the school and the community. Parents and community groups must be made to feel that the school is an integral part of the community providing facilities for their use, and instructional program which is responsive to and open to their voluntary participation. Therefore, the administration suite must be easily accessible to students and visitors, presenting a friendly, informal, and pleasant atmosphere.
- B. Specific Activities:
 - Receptionist who would handle all incoming traffic
 - General waiting area
 - Student waiting area
 - Secretary space
- C. Provide internal direct access from Administration to the Health Suite and Guidance Department

OCCUPANTS:

- **Staff** 3 Secretaries
- **Students** 1 - 10

SIZE AND LOCATION:

- **Size** 500 sq ft
- **Location** At main entrance to building. Must have visual control of main entrance, secure vestibule and lobby. All visitors must enter main office.

FURNISHINGS AND EQUIPMENT:

- **In-Contract** 48" x 48" tackboard
48" x 48" whiteboard
6 L.F. base and wall cabinet with sink and under counter refrigerator for coffee bar. Place out of view
Built in Casework for Reception Desk and Workstations
42" TVs (2) Wall Mounted
- **By Owner** (3) desk chairs
Sofa
(2) Chairs
Tables
File cabinets
- **Finishes** Floor: Carpet
Base: Vinyl
Walls: CMU - painted
Ceiling: Suspended acoustic tile 9'-0" A.F.F.
Door: 36" X 84" with 24" x 36" vision glass / Storefront System to Vestibule and Lobby
- **Electric outlets** Double duplex at desk locations / Minimum (2) duplex per wall /
Electric for TVs / Computer Charging Station
- **Security CCTV** monitors (at desk locations)

ADMINISTRATION / SAFETY / GUIDANCE

- **Intercom** Main visitor entrance / Auditorium Lobby Entrance / Gym Lobby Entrance / Receiving – Master Station
- **Buzzer/elec. release** Main Entrance / Main Office Entrance from Vestibule / Auditorium Lobby Entrance / Gym Lobby Entrance / Receiving
- **Clock (Atomic)**
- **Public Address System master station**
- **Fire alarm control panel**
- **Telecommunications** Data/Phone outlets at each secretarial workstation – wireless access point / **Data outlets at TV locations**
- **Emergency generator annunciator panel**

SPECIAL CHARACTERISTICS:

- **Closet space** Place out of view
- **Provide storage for incoming supplies**

ADMINISTRATION / SAFETY / GUIDANCE

SPACE NAME: DELIVERY STORAGE ROOM

USE OF SPACE - PURPOSE/ACTIVITIES:

A. Storage of deliveries

OCCUPANTS:

- Staff N/A
- Students N/A

SIZE AND LOCATION:

- Size 50 sq ft
- Location Adjacent to Reception/Clarical

FURNISHINGS AND EQUIPMENT:

- In-Contract 8 L.F. adjustable metal shelving units (12" deep by 84" high)
- By Owner N/A
- Finishes Floor: VCT
Base: Vinyl
Walls: CMU or Gypsum Wallboard - painted
Ceiling: Suspended acoustic tile 9'-0" A.F.F.
Door: 36" X 84"
- Electric outlets Minimum (1) duplex per wall
- Motion Detector lighting control

SPECIAL CHARACTERISTICS:

N/A

ADMINISTRATION / SAFETY / GUIDANCE

SPACE NAME: PRINCIPAL'S OFFICE

USE OF SPACE - PURPOSE/ACTIVITIES:

- A. Specific Activities:
- Planning with individuals, and community groups
 - Conferring with teachers, students, and parents
 - Interviewing applicants
 - Private with secondary access

OCCUPANTS:

- **Staff** 3-4
- **Students** N/A

SIZE AND LOCATION:

- **Size** 300 sq ft
- **Location** Door to adjacent conference room. Provide closet with lock.

FURNISHINGS AND EQUIPMENT:

- **In-Contract** Closet with lock
42" Wall Mounted TV
- **By Owner** Desk
Chair
48" conference table
Coffee table
2 side chairs
Credenza
- **Finishes** Floor: Carpet
Base: Vinyl
Walls: CMU or Gypsum wallboard painted
Ceiling: suspended acoustic tile 9'-0" A.F.F.
Door: 36" X 84" with 8" x 30" vision glass
- **Electric outlets** Double duplex at desk location / Minimum (1) duplex per wall /
Electric for TV
- **Clock (Atomic)**
- **Telecommunications** Data/Phone outlet at Desk / Data at TV Location
- **Ceiling speaker** Public Address System
- **Motion Detector** lighting control

SPECIAL CHARACTERISTICS:

- **Provide closet with lock**
- **Window to exterior**

ADMINISTRATION / SAFETY / GUIDANCE

SPACE NAME: ASSISTANT PRINCIPAL/ DEAN OFFICE

USE OF SPACE - PURPOSE/ACTIVITIES:

- A. Specific Activities:
- Planning with individuals and community groups
 - Conferring with teachers, students, and parents

OCCUPANTS:

- **Staff** 3
- **Students** N/A

SIZE AND LOCATION:

- **Size** 120 sq ft
- **Location** Adjacent to reception area. Provide closet with lock

FURNISHINGS AND EQUIPMENT:

- **In-Contract** Closet with lock
- **By Owner** Desk
Chair
2 side chairs
Credenza
File Cabinet
- **Finishes** Floor: Carpet
Base: Vinyl
Walls: CMU or Gypsum wallboard painted
Ceiling: Suspended acoustic tile 9'-0" A.F.F.
Door: 36" X 84" with 8" x 30" vision glass
- **Electric outlets** Double duplex at desk location / Minimum (1) duplex per wall
- **Telecommunications** Data/Phone outlet at Desk
- **Ceiling speaker** Public Address System
- **Motion Detector** lighting control

SPECIAL CHARACTERISTICS:

- **Window to exterior**
- **Closet with lock**

ADMINISTRATION / SAFETY / GUIDANCE

SPACE NAME: STAFF OFFICE

USE OF SPACE - PURPOSE/ACTIVITIES:

A. Specific Activities:

- Staff offices

OCCUPANTS:

- Staff 3
- Students N/A

SIZE AND LOCATION:

- Size 120 sq ft
- Location Adjacent to reception area.

FURNISHINGS AND EQUIPMENT:

- In-Contract
- By Owner Desk
Chair
2 side chairs
File Cabinet
- Finishes Floor: Carpet
Base: Vinyl
Walls: CMU or Gypsum wallboard painted
Ceiling: Suspended acoustic tile 9'-0" A.F.F.
Door: 36" X 84" with 8" x 30" vision glass
- Electric outlets Double duplex at desk location / Minimum (1) duplex per wall
- Telecommunications Data/Phone outlet at Desk
- Ceiling speaker Public Address System
- Motion Detector lighting control

SPECIAL CHARACTERISTICS:

- Window to exterior

ADMINISTRATION / SAFETY / GUIDANCE

SPACE NAME: WORKROOM / MAILROOM

USE OF SPACE - PURPOSE/ACTIVITIES:

- A. Duplication of materials and general office production work
- B. Location for Staff Mailboxes

OCCUPANTS:

- **Staff** 6-8
- **Students** N/A

SIZE AND LOCATION:

- **Size** 300 sq ft
- **Location** Adjacent supply/storage room.

FURNISHINGS AND EQUIPMENT:

- **In-Contract** 48" x 48" tackboard
20 L.F. of base and wall cabinets with sink
Storage Cabinet 48"W
Mailbox Casework 100 Slots
- **By Owner** Table
Chairs
Photocopier
- **Finishes** Floor: VCT
Base: vinyl
Walls: CMU or Gypsum Wallboard - painted
Ceiling: suspended acoustic tile 9'-0" A.F.F.
Door: 36" X 84" with 8" x 30" vision glass
- **Electric outlets** Minimum (1) duplex per wall, (2) duplex outlets above counter, and (2) 208V outlets for copying equipment
-
- **Telecommunications** (2) data outlets for copying equipment
-
- **Ceiling speaker** Public Address System
-
- **Motion Detector** lighting control

SPECIAL CHARACTERISTICS:

- N/A

ADMINISTRATION / SAFETY / GUIDANCE

SPACE NAME: CONFERENCE ROOM

USE OF SPACE - PURPOSE/ACTIVITIES:

A. Conference room for principal.

OCCUPANTS:

- **Staff** 16
- **Students** N/A

SIZE AND LOCATION:

- **Size** 400 sq ft
- **Location** Adjacent to principal's office with connecting door.

FURNISHINGS AND EQUIPMENT:

- **In-Contract** 48" x 48" tackboard
48" x 48" white marker board
64" Interactive whiteboard (smart technology w/ projector)
- **By Owner** Table
Chairs
- **Finishes** Floor: Carpet
Base: Vinyl
Walls: CMU or Gypsum Wallboard - painted
Ceiling: Suspended acoustic tile 9'-0" A.F.F.
Door: 36" X 84" with 8"x30" vision glass
- **Electric outlets** Minimum (1) duplex per wall / Projector ceiling outlet
- **Ceiling speaker** Public Address System
- **Telecommunications** Data/Phone outlet / Interactive White Board / Projector provisions / Apple TV
- **Motion Detector** lighting control

SPECIAL CHARACTERISTICS:

- N/A

ADMINISTRATION / SAFETY / GUIDANCE

SPACE NAME: STORAGE / SUPPLIES

USE OF SPACE - PURPOSE/ACTIVITIES:

- A. Storage of general office supplies.

OCCUPANTS:

- **Staff** N/A
- **Students** N/A

SIZE AND LOCATION:

- **Size** 100 sq ft
- **Location** Adjacent to duplication/production & office spaces.

FURNISHINGS AND EQUIPMENT:

- **In-Contract** 18 L.F. adjustable metal shelving units (12" deep by 84" high)
- **By Owner** N/A
- **Finishes** Floor: VCT
Base: Vinyl
Walls: CMU or Gypsum Wallboard - painted
Ceiling: Suspended acoustic tile 9'-0" A.F.F.
Door: 36" X 84"
- **Electric outlets** Minimum (1) duplex per wall
- **Ceiling speaker** Public Address System
- **Telecommunications** Data/Phone outlet
- **Motion Detector** lighting control

SPECIAL CHARACTERISTICS:

N/A

ADMINISTRATION / SAFETY / GUIDANCE

SPACE NAME: ATTENDANCE

USE OF SPACE - PURPOSE/ACTIVITIES:

- A. Monitor Student Attendance
- B. Compile and maintain student attendance records
- C. Monitor Secure Vestibule access to lobby

OCCUPANTS:

- **Staff** 1
- **Students** 2

SIZE AND LOCATION:

- **Size** 150 sq ft
- **Location** Adjacent to Secure Vestibule, Reception / Clerical.

FURNISHINGS AND EQUIPMENT:

- **In-Contract** 48" x 48" tackboard
48" x 48" white marker board
- **By Owner** Desk
Desk Chair
Side Chairs (2)
File Cabinet
- **Finishes** Floor: Carpet
Base: Vinyl
Walls: CMU or Gypsum Wallboard - painted
Ceiling: Suspended acoustic tile 9'-0" A.F.F.
Door: 36" X 84" with 8" x 30" vision glass
- **Electric outlets** Double Duplex at desk location / Minimum (1) duplex per wall
- **Ceiling speaker** Public Address System
- **Telecommunications** Data/Phone outlet at Desk
- **Motion Detector** lighting control

SPECIAL CHARACTERISTICS:

- N/A

ADMINISTRATION / SAFETY / GUIDANCE

SPACE NAME: BOOKKEEPER

USE OF SPACE - PURPOSE/ACTIVITIES:

- A. Space for finance office.

OCCUPANTS:

- **Staff** 2
- **Students** N/A

SIZE AND LOCATION:

- **Size** 150 sq ft
- **Location** Adjacent to Reception / Clerical.

FURNISHINGS AND EQUIPMENT:

- **In-Contract** 48"x 48" tackboard
48" x 48" white marker board
- **By Owner** Desk
Desk Chair
Side Chairs (2)
- File Cabinet
Bookcase
- **Finishes** Floor: Carpet
Base: Vinyl
Walls: CMU or Gypsum Wallboard - painted
Ceiling: Suspended acoustic tile 9'-0" A.F.F.
Door: 36" X 84" with 8" x 30" vision glass
- **Electric outlets** double duplex at desk locations / Minimum (1) duplex per wall
- **Ceiling speaker** Public Address System
- **Telecommunications** Data/Phone outlet
- **Motion Detector** lighting control

SPECIAL CHARACTERISTICS:

- N/A

ADMINISTRATION / SAFETY / GUIDANCE

SPACE NAME: SCHOOL RESOURCE OFFICER

USE OF SPACE - PURPOSE/ACTIVITIES:

A. Space for Resource Officer

OCCUPANTS:

- Staff 1
- Students N/A

SIZE AND LOCATION:

- Size 120 sq ft
- Location

FURNISHINGS AND EQUIPMENT:

- **In-Contract** 48"x 48" tackboard
48" x 48" white marker board
- **By Owner** Desk
Desk Chair
Side Chairs (2)
- File Cabinet
Bookcase
- **Finishes** Floor: Carpet
Base: Vinyl
Walls: CMU or Gypsum Wallboard - painted
Ceiling: Suspended acoustic tile 9'-0" A.F.F.
Door: 36" X 84" with 8" x 30" vision glass
- **Electric outlets** double duplex at desk locations / Minimum (1) duplex per wall
- **Ceiling speaker** Public Address System
- **Telecommunications** Data/Phone outlet
- **Motion Detector** lighting control

SPECIAL CHARACTERISTICS:

- N/A

ADMINISTRATION / SAFETY / GUIDANCE

SPACE NAME: PARENT/TEACHER LIAISON

USE OF SPACE - PURPOSE/ACTIVITIES:

A. Space for Parent/Teacher Liaison

OCCUPANTS:

- Staff 1
- Students N/A

SIZE AND LOCATION:

- Size 120 sq ft
- Location Adjacent to Reception / Clerical.

FURNISHINGS AND EQUIPMENT:

- **In-Contract** 48"x 48" tackboard
48" x 48" white marker board
- **By Owner** Desk
Desk Chair
Side Chairs (2)
- File Cabinet
Bookcase
- **Finishes** Floor: Carpet
Base: Vinyl
Walls: CMU or Gypsum Wallboard - painted
Ceiling: Suspended acoustic tile 9'-0" A.F.F.
Door: 36" X 84" with 8" x 30" vision glass
- **Electric outlets** double duplex at desk locations / Minimum (1) duplex per wall
- **Ceiling speaker** Public Address System
- **Telecommunications** Data/Phone outlet
- **Motion Detector** lighting control

SPECIAL CHARACTERISTICS:

- N/A

ADMINISTRATION / SAFETY / GUIDANCE

SPACE NAME: RECORDS STORAGE

USE OF SPACE - PURPOSE/ACTIVITIES:

- A. Storage of important documents and funds.

OCCUPANTS:

- **Staff** 1
- **Students** N/A

SIZE AND LOCATION:

- **Size** 200 sq ft
- **Location** Adjacent to Bookkeeper.

FURNISHINGS AND EQUIPMENT:

- **In-Contract** 18 L.F. adjustable metal shelving units (12" deep by 84" high)
- **By Owner** File Cabinets
- **Finishes** Floor: VCT
Base: Vinyl
Walls: CMU or Gypsum Wallboard - painted
Ceiling: Suspended acoustic tile 9'-0" A.F.F.
Door: 36" X 84"
- **Electric outlets** Minimum (1) duplex per wall
- **Ceiling speaker** Public Address System
- **Telecommunications** Phone/Data Outlet
- **Motion Detector** lighting control

SPECIAL CHARACTERISTICS:

- **Small safe anchored to floor**

ADMINISTRATION / SAFETY / GUIDANCE

SPACE NAME: STUDENT SUPERVISED STUDY

USE OF SPACE - PURPOSE/ACTIVITIES:

- A. Student Support.

OCCUPANTS:

- **Staff** 1
- **Students** 1-4

SIZE AND LOCATION:

- **Size** 200 sq ft
- **Location** Adjacent to Attendance Office

FURNISHINGS AND EQUIPMENT:

- **In-Contract** 48" x 48" total length tackboard
- 48" x 48" total length whiteboard

- **By Owner** Desks (4)
Chairs (4)
(1) Teacher desk, chair, computer workstation

- **Finishes** Floor: VCT
Base: Vinyl
Walls: CMU or Gypsum Wallboard - painted
Ceiling: Suspended acoustic tile 9'-0" A.F.F.
Door: 36" X 84"

- **Electric outlets** Minimum (1) duplex per wall
- **Ceiling speaker** Public Address System
- **Telecommunications** Phone/Data Outlet
- **Motion Detector** lighting control

SPECIAL CHARACTERISTICS:

- N/A

ADMINISTRATION / SAFETY / GUIDANCE

SPACE NAME: STAFF TOILET

USE OF SPACE - PURPOSE/ACTIVITIES:

- A. For Staff use
- B. Specific Activities:
 - Rest room facility
 - H/C accessible

OCCUPANTS:

- **Staff** 1
- **Students** N/A

SIZE AND LOCATION:

- **Size** 60 sq ft each
- **Location** By Reception / Clerical

FURNISHINGS AND EQUIPMENT:

- **In-Contract** Toilet accessories
- **By Owner** N/A
- **Finishes** Floor: ceramic tile
Base: ceramic tile
Walls: ceramic tile wainscot 5'-0" - CMU - painted - epoxy
Ceiling: suspended acoustic tile 8'-0" A.F.F.
Door: 36" X 84" with privacy lock
- **Ceiling speaker** Public Address System
- **Motion Detector** lighting control

SPECIAL CHARACTERISTICS:

- **ADA Accessible**

ADMINISTRATION / SAFETY / GUIDANCE

SPACE NAME: GUIDANCE RECEPTION

USE OF SPACE - PURPOSE/ACTIVITIES:

- A. The Guidance suite is the coordinating unit for all activities in the Guidance Department and between the Career Center and the community. Parents must be made to feel that the school is an integral part of the community providing facilities for their use, and instructional program which is responsive to and open to their voluntary participation.
- B. Specific Activities:
- General waiting area
 - Student waiting area
 - Provide internal direct access to the Administration Area

OCCUPANTS:

- Staff N/A
- Students 1 - 10

SIZE AND LOCATION:

- Size 100 sq ft
- Location Adjacent to the Guidance Secretary

FURNISHINGS AND EQUIPMENT:

- In-Contract 42" Wall Mounted TV
- By Owner Sofa
(2) Chairs
- Finishes Floor: Carpet
Base: Vinyl
Walls: CMU - painted
Ceiling: Suspended acoustic tile 9'-0" A.F.F.
Door: 36" X 84" with 24" x 36" vision glass
- Electric outlets Minimum (1) duplex per wall / Electric for TV location
- Telecommunications Data outlet at TV location / Data outlet at Electronic Sign-in Station
- Motion Detector light Control

SPECIAL CHARACTERISTICS:

- N/A

ADMINISTRATION / SAFETY / GUIDANCE

SPACE NAME: GUIDANCE - REGISTRAR / SECRETARY

USE OF SPACE - PURPOSE/ACTIVITIES:

- A. Registering Students for Classes.
- B. Specific Activities:
 - Receptionist who would handle all incoming traffic
 - Secretary space
 - Registrar

OCCUPANTS:

- **Staff** 1
- **Students** 1 - 2

SIZE AND LOCATION:

- **Size** 75 sq ft
- **Location** Adjacent to the Counselors and Guidance Reception

FURNISHINGS AND EQUIPMENT:

- **In-Contract** 48" x 48" tackboard
48" x 48" whiteboard
- **By Owner** (1) Desk
(2) desk chairs
File cabinets
- **Finishes** Floor: Carpet
Base: Vinyl
Walls: CMU - painted
Ceiling: Suspended acoustic tile 9'-0" A.F.F.
Door: 36" X 84" with 24" x 36" vision
- **Electric outlets** Double duplex at desk locations / Minimum (1) duplex per wall
- **Telecommunications** Phone/Data at desk location / Wireless Access Point
- **Motion Detector** light control

SPECIAL CHARACTERISTICS:

- **Window to reception area – visual control over reception**

ADMINISTRATION / SAFETY / GUIDANCE

SPACE NAME: GUIDANCE - COLLEGE / CAREER CENTER

- A. Library of College Materials
- B. Discussion of College options with students.

OCCUPANTS:

- **Staff** 1
- **Students** 1-4

SIZE AND LOCATION:

- **Size** 300 sq ft
- **Location** Adjacent to Guidance Reception.

- **In-Contract** 18 L.F. book cases

- **By Owner** Round Table (2)
Chairs (8)

- **Finishes** Floor: Carpet
Base: Vinyl
Walls: CMU - painted
Ceiling: Suspended acoustic tile 9'-0" A.F.F.
Door: 36" X 84" with 8" x 30" vision glass

- **Electric outlets** (1) duplex outlet per wall

- **Ceiling speaker** Public Address System

- **Telecommunications** Data / Phone outlet

- **Motion Detector** lighting control

SPECIAL CHARACTERISTICS:

- N/A

ADMINISTRATION / SAFETY / GUIDANCE

SPACE NAME: GUIDANCE - MAIN COUNSELOR'S OFFICE

USE OF SPACE - PURPOSE/ACTIVITIES:

- A. Specific Activities:
- Conferring with teachers, students, and parents

OCCUPANTS:

- **Staff** 1
- **Students** N/A

SIZE AND LOCATION:

- **Size** 175 sq ft
- **Location** Adjacent to Guidance Reception area. Provide closet with lock

FURNISHINGS AND EQUIPMENT:

- **In-Contract** Closet with lock
42" Wall Mounted TV
- **By Owner** Desk
Chair
2 side chairs
Credenza
File Cabinet
- **Finishes** Floor: Carpet
Base: Vinyl
Walls: CMU or Gypsum wallboard painted
Ceiling: Suspended acoustic tile 9'-0" A.F.F.
Door: 36" X 84" with 8" x 30" vision glass
- **Electric outlets** Double duplex at desk location / Minimum (1) duplex per wall /
Electric at TV location
- **Telecommunications** Data/Phone outlet at Desk / Data at TV location
- **Ceiling speaker** Public Address System
- **Motion Detector** lighting control

SPECIAL CHARACTERISTICS:

- **Window to exterior**

ADMINISTRATION / SAFETY / GUIDANCE

SPACE NAME: GUIDANCE - COUNSELOR'S OFFICE

USE OF SPACE - PURPOSE/ACTIVITIES:

- A. Specific Activities:
- Conferring with teachers, students, and parents

OCCUPANTS:

- **Staff** 1
- **Students** N/A

SIZE AND LOCATION:

- **Size** 150 sq ft
- **Location** Adjacent to Guidance Reception area. Provide closet with lock

FURNISHINGS AND EQUIPMENT:

- **In-Contract** Closet with lock
- **By Owner** Desk
Chair
2 side chairs
Credenza
File Cabinet
- **Finishes** Floor: Carpet
Base: Vinyl
Walls: CMU or Gypsum wallboard painted
Ceiling: Suspended acoustic tile 9'-0" A.F.F.
Door: (2) 36" X 84" with ½ vision glass
- **Electric outlets** Double duplex at desk location / Minimum (1) duplex per wall
- **Telecommunications** Data/Phone outlet at Desk
- **Ceiling speaker** Public Address System
- **Motion Detector** lighting control

SPECIAL CHARACTERISTICS:

- **Window to exterior**
- **Provide door to Counseling Suite and Corridor**

ADMINISTRATION / SAFETY / GUIDANCE

SPACE NAME: GUIDANCE - IB COORDINATOR / GIFTED

USE OF SPACE - PURPOSE/ACTIVITIES:

- A. Specific Activities:
- Conferring with teachers, students, and parents

OCCUPANTS:

- **Staff** 1
- **Students** N/A

SIZE AND LOCATION:

- **Size** 150 sq ft
- **Location** Adjacent to Guidance Reception area. Provide closet with lock

FURNISHINGS AND EQUIPMENT:

- **In-Contract** Closet with lock
- **By Owner** Desk
Chair
2 side chairs
Credenza
File Cabinet
- **Finishes** Floor: Carpet
Base: Vinyl
Walls: CMU or Gypsum wallboard painted
Ceiling: Suspended acoustic tile 9'-0" A.F.F.
Door: 36" X 84" with 8" x 30" vision glass
- **Electric outlets** Double duplex at desk location / Minimum (1) duplex per wall
- **Telecommunications** Data/Phone outlet at Desk
- **Ceiling speaker** Public Address System
- **Motion Detector** lighting control

SPECIAL CHARACTERISTICS:

- **Window to exterior**

ADMINISTRATION / SAFETY / GUIDANCE

SPACE NAME: GUIDANCE - TESTING / DATA COORDINATOR

USE OF SPACE - PURPOSE/ACTIVITIES:

- A. Specific Activities:
- Conferring with teachers, students, and parents

OCCUPANTS:

- **Staff** 1
- **Students** N/A

SIZE AND LOCATION:

- **Size** 150 sq ft
- **Location** Adjacent to Guidance Reception area. Provide closet with lock

FURNISHINGS AND EQUIPMENT:

- **In-Contract** Closet with lock
- **By Owner** Desk
Chair
2 side chairs
Credenza
File Cabinet
- **Finishes** Floor: Carpet
Base: Vinyl
Walls: CMU or Gypsum wallboard painted
Ceiling: Suspended acoustic tile 9'-0" A.F.F.
Door: 36" X 84" with 8" x 30" vision glass
- **Electric outlets** Double duplex at desk location / Minimum (1) duplex per wall
- **Telecommunications** Data/Phone outlet at Desk
- **Ceiling speaker** Public Address System
- **Motion Detector** lighting control

SPECIAL CHARACTERISTICS:

- **Window to exterior**

ADMINISTRATION / SAFETY / GUIDANCE

SPACE NAME: GUIDANCE - STUDENT SUPPORT

USE OF SPACE - PURPOSE/ACTIVITIES:

- A. Specific Activities:
- Conferring with teachers, students, and parents

OCCUPANTS:

- **Staff** 1
- **Students** N/A

SIZE AND LOCATION:

- **Size** 150 sq ft
- **Location** Adjacent to Guidance Reception area. Provide closet with lock

FURNISHINGS AND EQUIPMENT:

- **In-Contract** Closet with lock
- **By Owner** Desk
Chair
2 side chairs
Credenza
File Cabinet
- **Finishes** Floor: Carpet
Base: Vinyl
Walls: CMU or Gypsum wallboard painted
Ceiling: Suspended acoustic tile 9'-0" A.F.F.
Door: 36" X 84" with 8" x 30" vision glass
- **Electric outlets** Double duplex at desk location / Minimum (1) duplex per wall
- **Telecommunications** Data/Phone outlet at Desk
- **Ceiling speaker** Public Address System
- **Motion Detector** lighting control

SPECIAL CHARACTERISTICS:

- **Window to exterior**

ADMINISTRATION / SAFETY / GUIDANCE

SPACE NAME: GUIDANCE - ITINERANTS

USE OF SPACE - PURPOSE/ACTIVITIES:

A. Specific Activities:

-

OCCUPANTS:

- **Staff** 1
- **Students** N/A

SIZE AND LOCATION:

- **Size** 50 sq ft
- **Location** Adjacent to Guidance Reception area.

FURNISHINGS AND EQUIPMENT:

- **In-Contract**
- **By Owner**

- **Finishes** Floor: Carpet
Base: Vinyl
Walls: CMU or Gypsum wallboard painted
Ceiling: Suspended acoustic tile 9'-0" A.F.F.
Door: 36" X 84" with 8" x 30" vision glass

- **Electric outlets** Double duplex at desk location / Minimum (1) duplex per wall

- **Telecommunications** Data/Phone outlet at Desk

- **Ceiling speaker** Public Address System
-
- **Motion Detector** lighting control

SPECIAL CHARACTERISTICS:

- N/A

ADMINISTRATION / SAFETY / GUIDANCE

SPACE NAME: GUIDANCE - SMALL GROUP / CONFERENCE

USE OF SPACE - PURPOSE/ACTIVITIES:

A. Conference room for librarian.

OCCUPANTS:

- **Staff** 6
- **Students** N/A

SIZE AND LOCATION:

- **Size** 200 sq ft
- **Location** Adjacent to Main Councilor's office with connecting door, In Guidance Suite

FURNISHINGS AND EQUIPMENT:

- **In-Contract** 48" x 48" tackboard
48" x 48" white marker board
64" Interactive whiteboard (smart technology w/ projector)
42" Wall Mounted TV
- **By Owner** Table
Chairs
- **Finishes** Floor: Carpet
Base: Vinyl
Walls: CMU or Gypsum wallboard - painted
Ceiling: Suspended acoustic tile 9'-0" A.F.F.
Door: 36" X 84" with 8"x30" vision glass
- **Electric outlets** Minimum (1) duplex per wall / Projector ceiling outlet / Electric at TV location
- **Ceiling speaker** Public Address System
- **Telecommunications** Data/Phone outlet / Interactive White Board / Projector provisions / Apple TV / Data at TV location
- **Ceiling speaker** Public Address System
- **Motion Detector** lighting control

SPECIAL CHARACTERISTICS:

- N/A

ADMINISTRATION / SAFETY / GUIDANCE

SPACE NAME: GUIDANCE - WORKROOM

USE OF SPACE - PURPOSE/ACTIVITIES:

- A. Individual teachers work area and storage of professional materials.
- B. Specific Activities:
 - Teacher and staff preparation of materials
 - Space for teacher and staff files
 - Space for teacher and staff supplies and storage.

OCCUPANTS:

- **Staff** 6-8
- **Students** N/A

SIZE AND LOCATION:

- **Size** 200 sq ft
- **Location** Central to Guidance.

FURNISHINGS AND EQUIPMENT:

- **In-Contract** 6 ft. work counter/cabinet with sink/hot and cold water
48" x 48" tackboard
48" x 48" whiteboard
Standard Refrigerator
- **By Owner** Copier Equipment
Bookcases
File Cabinets
- **Finishes** Floor: VCT
Base: Vinyl
Walls: CMU or Gypsum Wallboard - painted
Ceiling: Suspended acoustic tile 9'-0" A.F.F.
Door: 36" X 84" with 24" x 36" vision glass
- **Electric outlets** Minimum (2) duplex per wall, (2) duplex outlets above counter, and (1) 208V outlet for copying equipment
- **Telecommunications** (1) data outlet for copying equipment
- **Ceiling speaker** Public Address System
- **Motion Detector** lighting control

SPECIAL CHARACTERISTICS:

- N/A

ADMINISTRATION / SAFETY / GUIDANCE

SPACE NAME: GUIDANCE - RECORDS STORAGE

USE OF SPACE - PURPOSE/ACTIVITIES:

- A. Storage of academic files.

OCCUPANTS:

- Staff N/A
- Students N/A

SIZE AND LOCATION:

- Size 800 sq ft
- Location Guidance

FURNISHINGS AND EQUIPMENT:

- In-Contract (10) Legal Size four drawer fireproof file cabinets
High Density File Storage System
- By Owner
- Finishes Floor: VCT
Base: Vinyl
Walls: CMU - painted
Ceiling: Suspended acoustic tile 9'-0" A.F.F.
Door: 36" X 84"
- Electric outlets Minimum (1) duplex per wall
- Ceiling speaker Public Address System
- Telecommunications Data/Phone outlet
- Motion Detector lighting control

SPECIAL CHARACTERISTICS:

- Fire Rated Room – 2 hours
- Card Reader Door Access

ADMINISTRATION / SAFETY / GUIDANCE

SPACE NAME: GUIDANCE - SPECIAL EDUCATION / PARENT LIASON

USE OF SPACE - PURPOSE/ACTIVITIES:

- A. Specific Activities:
- Conferring with teachers, students, and parents

OCCUPANTS:

- **Staff** 1
- **Students** N/A

SIZE AND LOCATION:

- **Size** 150 sq ft
- **Location** Special Education Department

FURNISHINGS AND EQUIPMENT:

- **In-Contract** Closet with lock
- **By Owner** Desk
Chair
2 side chairs
Credenza
File Cabinet
- **Finishes** Floor: Carpet
Base: Vinyl
Walls: CMU or Gypsum wallboard - painted
Ceiling: Suspended acoustic tile 9'-0" A.F.F.
Door: 36" X 84" with 8" x 30" vision glass
- **Electric outlets** Double duplex at desk location / Minimum (1) duplex per wall
- **Telecommunications** Data/Phone outlet at Desk
- **Ceiling speaker** Public Address System
- **Motion Detector** lighting control

SPECIAL CHARACTERISTICS:

- N/A

ADMINISTRATION / SAFETY / GUIDANCE

SPACE NAME: GUIDANCE - STAFF TOILET

USE OF SPACE - PURPOSE/ACTIVITIES:

- A. For Staff use
- B. Specific Activities:
 - Rest room facility
 - H/C accessible

OCCUPANTS:

- **Staff** 1
- **Students** N/A

SIZE AND LOCATION:

- **Size** 60 sq ft each
- **Location**

FURNISHINGS AND EQUIPMENT:

- **In-Contract** Toilet accessories
- **By Owner** N/A
- **Finishes** Floor: ceramic tile
Base: ceramic tile
Walls: ceramic tile wainscot 5'-0" - CMU - painted - epoxy
Ceiling: suspended acoustic tile 8'-0" A.F.F.
Door: 36" X 84" with privacy lock
- **Ceiling speaker** Public Address System
- **Motion Detector** lighting control

SPECIAL CHARACTERISTICS:

- **ADA Accessible**

TOILETS

SPACE NAME: TOILET – BOY’S GANG

USE OF SPACE - PURPOSE/ACTIVITIES:

- A. For Student use
- B. Specific Activities:
 - Rest room facility
 - H/C accessible

OCCUPANTS:

- **Staff** N/A
- **Students** 1-6

SIZE AND LOCATION:

- **Size** 300 sq ft
- **Location** Distribute throughout Building

FURNISHINGS AND EQUIPMENT:

- **In-Contract** Toilet accessories
Toilet partitions
- **By Owner** Soap Dispensers
- **Finishes** Floor: ceramic tile
Base: ceramic tile
Walls: ceramic tile wainscot 5'-0" - CMU - painted - epoxy
Ceiling: suspended acoustic tile 9'-0" A.F.F.
Door: 36" X 84"
- **Ceiling speaker** Public Address System

SPECIAL CHARACTERISTICS:

- **ADA Accessible**
- **Minimum One per Floor**

TOILETS

SPACE NAME: TOILET – GIRL’S GANG (4)

USE OF SPACE - PURPOSE/ACTIVITIES:

- A. For Student use
- B. Specific Activities:
 - Rest room facility
 - H/C accessible

OCCUPANTS:

- **Staff** N/A
- **Students** 1-6

SIZE AND LOCATION:

- **Size** 300 sq ft
- **Location** Distribute Throughout Building

FURNISHINGS AND EQUIPMENT:

- **In-Contract** Toilet accessories
Toilet partitions
- **By Owner** Soap Dispensers
- **Finishes** Floor: ceramic tile
Base: ceramic tile
Walls: ceramic tile wainscot 5'-0" - CMU - painted - epoxy
Ceiling: suspended acoustic tile 9'-0" A.F.F.
Door: 36" X 84"
- **Ceiling speaker** Public Address System

SPECIAL CHARACTERISTICS:

- **ADA Accessible**
- **Minimum One per Floor**

TOILETS

SPACE NAME: STUDENT UNISEX SINGLE TOILETS

USE OF SPACE - PURPOSE/ACTIVITIES:

- A. For Controlled Student use
- B. Minimum one Toilet per Floor
- C. Specific Activities:
 - Rest room facility
 - H/C accessible

OCCUPANTS:

- Staff 1
- Students N/A

SIZE AND LOCATION:

- Size 60 sq ft each
- Location One per Floor

FURNISHINGS AND EQUIPMENT:

- In-Contract Toilet accessories
- By Owner N/A
- Finishes
 - Floor: ceramic tile
 - Base: ceramic tile
 - Walls: ceramic tile wainscot 5'0" - CMU - painted - epoxy
 - Ceiling: suspended acoustic tile 8'-0" A.F.F.
 - Door: 36" X 84" with privacy lock
- Ceiling speaker Public Address System
- Motion Detector lighting control

SPECIAL CHARACTERISTICS:

- ADA Accessible
- Card Reader Door Access

TOILETS

SPACE NAME: CUSTODIAL CLOSET

USE OF SPACE - PURPOSE/ACTIVITIES:

- A. Cleaning Support
- B. Specific Activities:
 - Storage of custodial supplies
 - Mop basin

OCCUPANTS:

- **Staff** 1
- **Students** N/A

SIZE AND LOCATION:

- **Size** 50 sq ft
- **Location** (1) Adjacent to gang toilets
(3) Adjacent to core classrooms (one per floor)

FURNISHINGS AND EQUIPMENT:

- **In-Contract** Mop basin
Mop shelf and rack
Backflow Prevention for Chemical Dispenser
- **By Owner** N/A
- **Finishes** Floor: Sealed Concrete
Base: Vinyl
Walls: CMU painted epoxy
Ceiling: suspended acoustic tile 9'-0" A.F.F.
Door: 36" X 84"
- **Electric Outlet** GFI

SPECIAL CHARACTERISTICS:

- N/A

SUPPORT SPACES & CIRCULATION

SPACE NAME: MECHANICAL ROOM

USE OF SPACE - PURPOSE/ACTIVITIES:

A. Space for mechanical equipment

OCCUPANTS:

- **Staff** N/A
- **Students** N/A

SIZE AND LOCATION:

- **Size** As required for equipment, maintenance & replacement (pull space)
- **Location** Mechanical rooms in various locations sized as required.

FURNISHINGS AND EQUIPMENT:

- **In-Contract** N/A
- **By Owner** N/A
- **Finishes** Floor: concrete (sealed)
Base: none
Walls: CMU - painted
Ceiling: exposed structure - painted
Door: 36" X 84" metal (pairs as required)
- **Electric outlets** for equipment and general use
- **Speakers** Public Address System

SPECIAL CHARACTERISTICS:

- N/A

SUPPORT SPACES & CIRCULATION

SPACE NAME: MECHANICAL CLOSETS

USE OF SPACE - PURPOSE/ACTIVITIES:

A. Space for mechanical equipment

OCCUPANTS:

- **Staff** N/A
- **Students** N/A

SIZE AND LOCATION:

- **Size** As required for equipment, maintenance & replacement (pull space)
- **Location** Mechanical rooms in various locations sized as required.

FURNISHINGS AND EQUIPMENT:

- **In-Contract** N/A
- **By Owner** N/A
- **Finishes**
 - Floor: concrete (sealed)
 - Base: none
 - Walls: CMU - painted
 - Ceiling: exposed structure - painted
 - Door: 36" X 84" (pairs as required)
- **Electric outlets** for equipment and general use

SPECIAL CHARACTERISTICS:

- N/A

SUPPORT SPACES & CIRCULATION

SPACE NAME: ELECTRICAL ROOM

USE OF SPACE - PURPOSE/ACTIVITIES:

A. Space for electrical equipment

OCCUPANTS:

- Staff N/A
- Students N/A

SIZE AND LOCATION:

- **Size** As required for all electrical equipment, maintenance & replacement
- **Location** Electrical rooms in various locations sized as required.

FURNISHINGS AND EQUIPMENT:

- **In-Contract** N/A
- **By Owner** N/A
- **Finishes** Floor: concrete (sealed)
Base: none
Walls: CMU - painted
Ceiling: exposed structure - painted
Door: 36" X 84" (pairs as required)
- **Electric outlets** for equipment and general use

SPECIAL CHARACTERISTICS:

- N/A

SUPPORT SPACES AND CIRCULATION

SPACE NAME: ELECTRICAL CLOSETS

USE OF SPACE - PURPOSE/ACTIVITIES:

A. Space for electrical equipment

OCCUPANTS:

- **Staff** N/A
- **Students** N/A

SIZE AND LOCATION:

- **Size** As required for all electrical equipment, maintenance & replacement
- **Location** Electrical rooms in various locations sized as required.

FURNISHINGS AND EQUIPMENT:

- **In-Contract** N/A
- **By Owner** N/A
- **Finishes** Floor: concrete (sealed)
Base: none
Walls: CMU - painted
Ceiling: exposed structure - painted
Door: 36" X 80" (pairs as required)
- **Electric outlets** for equipment and general use

SPECIAL CHARACTERISTICS:

- N/A

SUPPORT SPACES AND CIRCULATION

SPACE NAME: ELEVATOR

USE OF SPACE - PURPOSE/ACTIVITIES:

- A. Space for electrical equipment
- B. Specific Activities: Efficient building circulation

OCCUPANTS:

- Staff N/A
- Students N/A

SIZE AND LOCATION:

- **Size** As required for students and to meet applicable code, Coordinate with Owner Equipment to be transported between floors
- **Location** In various locations sized as required.

FURNISHINGS AND EQUIPMENT:

- **In-Contract** N/A
- **By Owner** N/A
- **Finishes** Floor: VCT
Base: Cab
Walls: Cab
Ceiling: Cab

SPECIAL CHARACTERISTICS:

- N/A

SUPPORT SPACES AND CIRCULATION

SPACE NAME: STAIRS AND CORRIDORS

USE OF SPACE - PURPOSE/ACTIVITIES:

A. Efficient Building Circulation and as required by code

OCCUPANTS:

- **Staff** N/A
- **Students** N/A

SIZE AND LOCATION:

- **Size** As required for students and to meet applicable code
- **Location** In various locations sized as required.

FURNISHINGS AND EQUIPMENT:

- **In-Contract** N/A
- **By Owner** N/A
- **Finishes**

Floor:	Epoxy Terrazzo
Base:	Rubber
Walls:	CMU - painted
Ceiling:	Suspended acoustic tile
Treads:	Pre-Cast Terrazzo (Main Stair)
Treads:	Colored Concrete (Egress Stairs)
- **Electric outlets** for cleaning equipment and general use
- **Wall speakers** Public Address System
- **Electronic Door Holders on all Corridor and Stair Doors**

SPECIAL CHARACTERISTICS:

- N/A

SPACE NAME: EXTERIOR SITE REQUIREMENTS

USE OF SPACE - PURPOSE/ACTIVITIES:

- A. Staff and visitor parking; parent drop-off of students; bus loading/unloading area; service entrance

OCCUPANTS:

- Staff N/A
- Students N/A

SIZE AND LOCATION:

- Size N/A.
- Location N/A

FURNISHINGS AND EQUIPMENT:

- In-Contract N/A
- By Owner N/A

SPECIAL CHARACTERISTICS:

- Design overall site parking to meet permit requirements and accommodate:
 - 200 staff parking
 - 300 visitors and students
 - 500 total spaces
 - Parent drop-off of students for 10 cars close to Student Entrance
 - Bus loading for 12 buses
 - Service entrance - loading and unloading for two vehicles and two trash dumpsters.
- See Separate Sports Facilities Requirements